

1

Push button - Spring

3/2

Ordering code

105. **T.8.1/C**

- TYPE  
**T** 32 = 3 ways  
 52 = 5 ways  
 BUTTON COLOR  
**C** 1 = Red  
 2 = Black  
 3 = Green

5/2

Push button - Spring

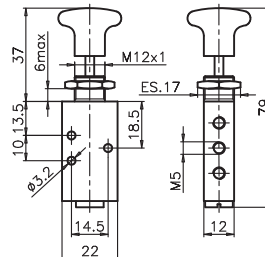
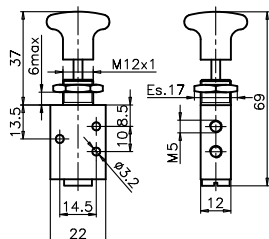

Weight gr. 75  
 Operating force 14 N

Weight gr. 92  
 Operating force 14 N

Operational characteristic

Fluid	Max working pressure (bar)	Temperature °C	Flow rate at 6 bar with $\Delta p=1$ (NI/min)	Orifice size (mm)	Working ports size
Filtered and lubricated air	10 bar	-5 - +70	120 NI/min	mm 2,5	M5

Push button 2 positions

3/2

Ordering code

105. **T.8/C**

- TYPE  
**T** 32 = 3 ways  
 52 = 5 ways  
 BUTTON COLOR  
**C** 1 = Red  
 2 = Black  
 3 = Green

5/2

Push button 2 positions

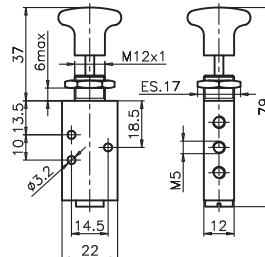
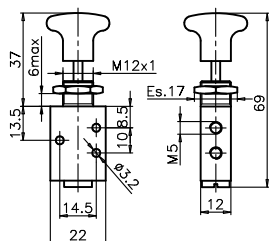

Weight gr. 75  
 Operating force 14 N

Weight gr. 92  
 Operating force 14 N

Operational characteristic

Fluid	Max working pressure (bar)	Temperature °C	Flow rate at 6 bar with $\Delta p=1$ (NI/min)	Orifice size (mm)	Working ports size
Filtered and lubricated air	10 bar	-5 - +70	120 NI/min	mm 2,5	M5

Whisker - Spring

3/2

Ordering code

105. **T.9.1**

- TYPE  
**T** 32 = 3 ways  
 52 = 5 ways

5/2

Whisker - Spring

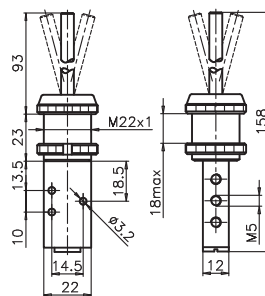
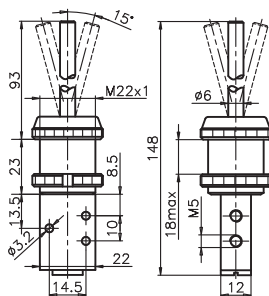

Weight gr. 136

Weight gr. 153

Operational characteristic

Fluid	Max working pressure (bar)	Temperature °C	Flow rate at 6 bar with $\Delta p=1$ (NI/min)	Orifice size (mm)	Working ports size
Filtered and lubricated air	10 bar	-5 - +70	120 NI/min	mm 2,5	M5