

General

The operational safety and durability of a pneumatic circuit depends on the quality of the compressed air. The compressed air and the moisture increase the rate of wear of the surfaces and seals, reducing the efficiency and the life of the pneumatic components. Furthermore the pressure fluctuation due to a discontinuous demand of air, adversely effect the correct operation of the circuit. To eliminate these disadvantages it is essential to install the service unit: filter, pressure regulator and lubricator.

Construction and working characteristics

The new FRL units AIRPLUS series represents the evolution of the well known and consolidated 1700 series.

The main features are increased performances, reliability, easy and fast assembly and the introduction of the latest technical features.

With the exception of the air intake module and the pressure switch module all elements are available in two configurations: with technopolimer connections (IN and OUT), (T series), or with metal threaded inserts, (N series).

Bowls made of transparent polycarbonate (PC) are fitted with a bowl protection guard which is assembled on the body via a quick coupling mechanism provided with a safety button. The filter, available with three filtration grades (5µm, 20µm and 50µm) is fitted as standard with a drain mechanism which can be operated manually or semi-automatically. The regulator is based on the rolling diaphragm technology with low hysteresis and the system is balanced. The unit can be fitted with integrated flush mounting pressure gauge (0 to 12 bar range).

4 pressure ranges are available going from 0 to 12 bar and the regulating knob can be blocked in position simply by pressing it down. A dedicated version is available for battery mounting, up to a maximum of 6 units. The lubricator is based on the Venturi principle and the oil quantity is regulated via the adjusting screw positioned on the transparent polycarbonate (PC) regulating dome which also ensure clear visibility of the oil flow and regulation. The oil suction pipe is fitted as standard with a sintered filter which ensures that any contaminant that should be present in the oil will reach the down stream circuit. Shoot off valve is available in two versions, one manually operated and one solenoid operated. In both cases the unit is fitted with a threaded connection for depressurising the downstream circuit. On the manually operated version, in the lock position, it is possible to fit up to three locks in order to prevent the accidental pressurization of the pneumatic circuit avoiding accidents or damages.

The solenoid operated version is available with a 15mm or with a 22mm solenoid valve. The soft start valve ensure a progressive pressurization of the down stream circuit avoiding sudden pressure surges which could be dangerous for the devices fitted on the down stream circuit. The filling time can be easily adjusted via a built in flow regulator. The full flow rate is allowed only once the down stream pressure has reached 50% of the value of the inlet pressure. The pressure switch module which can be set between 2 and 10 bar and the air intake module complete the range. The elements are joint together via dedicated quick coupling technopolimer flanges which allows for the units to be panel mounted moreover ensure the possibility to replace any component without disassembling the FRL group from its position.

90° mounting brackets and standard gauges are also available.

Instruction for installation and operation

The FRL unit must be installed as close as possible to the application.

The air flow direction must follow the directions indicated on the single units in correspondence of the threaded connections. (IN and OUT)

Units provided with bowl must be mounted vertically with the bowl facing down. Single units or groups can be panel mounted via the Y type flanges, regulators and filter-regulators can be mounted via the 90° zinc plated steel bracket. In order to mount the 90° bracket it is necessary to remove the regulating knob and then the locking ring before positioning the bracket. All units must be operated according to the specified pressure and temperature ranges; fittings must be mounted without exceeding the maximum torque allowed. Ensure that the units cover plates are in position before pressure is applied. The cover plates are needed to lock in position the top part of the unit. The condense level in filter and filter-regulators bowls must never exceed the maximum level indicated on the bowls. With manual or semi automatic drain the condense can be discharged via a 6/4mm tube directly connected to the drain tap. On the pressure regulator the pressure value must always set while pressure is rising and ideally the unit pressure range should be chosen based on the pressure value to be regulated. Lubricators must be filled with class FD22 and HG32 oils. Ensure, both on the inlet and on the outlet, that the flow rate is above the minimum flow rate required to operate the unit. Below this value the units does not operate.

The oil quantity can be regulated via the regulating screw on the transparent polycarbonate dome through which it is also clearly visible the oil flow. A drop every 300-600 litres should be allowed. The oil refill can take place only with the bowl not under pressure. This size does not have the dedicated oil re-fill plug.

The manual shot off valve needs, to be operated, a push and turn action (clockwise) in order to close it and discharge the down stream circuit it is necessary to turn anti clock wise the knob. The soft start valve is used to slowly and progressively pressurize the down stream circuit, the time needed to do so can be set by means of the built in flow regulator. The soft start valve on its own does not allow for the down stream circuit to be discharged, in order to do so it is necessary to combine it with a shot off valve (to be mounted upstream).

Maintenance



For any maintenance which requires the removal of the top plugs/ supports from the body it is necessary to preventively remove the sides cover plates. If the top plugs/supports are removed with the sides plates still in their position the unit could be permanently damaged.

Bowls, plugs and supports are assembled with a bayonet type mechanism. In order to remove them rotate anti clockwise until the mechanical stop is reached and then remove from the body (for the bowls firstly press down the green safety button).

Bowls and transparent parts can be cleaned with water and neutral soap. Do not use solvents or alcohol.

Filtering elements (from filters and filter regulators) made of HDPE can be regenerated by washing and blowing them. In order to remove them it is necessary to remove the bowl unscrew the filter element and replace it with a new one or clean it.

The oil refill process can take place only if the bowl is not pressurized. The oil refill plug is not available on this size.

Should the pressure regulator not perform properly or should present a constant leakage from the relieving replaced the diaphragm by unloading completely the regulating spring before removing the regulation support.

Any other maintenance operation, in consideration of the complexity of the assembly, and the need of a through test according to the Pneumax spa specification, should be carried out by the manufacturer.

Fittings maximum recommended torque applicable

THREAD	Technopolymer version (T)	Metal version (N)
G1/8"	4 Nm	15 Nm
G1/4"	9 Nm	20 Nm
G3/8"	16 Nm	25 Nm
G1/2"	22 Nm	30 Nm

Filter (F)

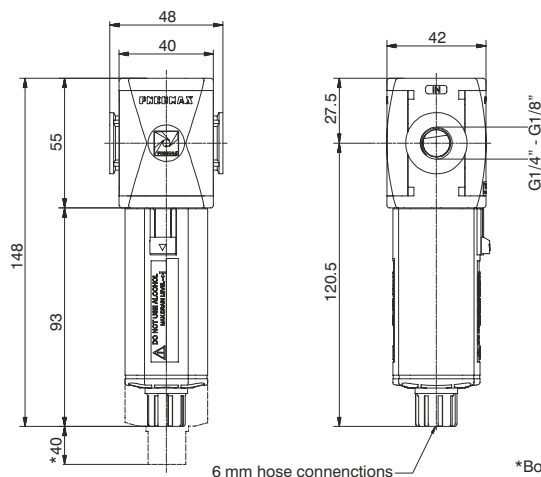

6 mm hose connections

*Bowl removal maximum height

Example: T171BFB : size 1, Filter with Technopolymer threads, G1/4" connections, 20 μ m filter pore size

Flow rate curves

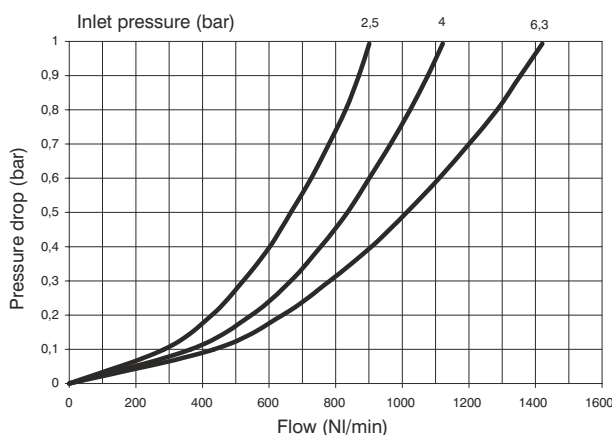

Operational characteristics

- Double filtering action: air flow centrifugation and filter element
- Filtering element made of HDPE (high density polyethylene) available in three different filtration grades (5 μ m, 20 μ m and 50 μ m) can be regenerated by washing it or replaced.
- Transparent bowl made off polycarbonate with bowl protection guard.
- Bowl assembly via bayonet type quick coupling mechanism with safety button.
- Semi-automatic drain mounted as standard; automatic drain upon request

Note

In order to ensure adequate flow on the auto drain version it is recommended to use minimum a 6mm fitting.

Technical characteristics

Connections	G 1/8" - G 1/4"
Max. inlet pressure	13 bar
Minimum working pressure with automatic drain	0,5 bar
Maximum working pressure with automatic drain	10 bar
Working temperature	-5°C +50°C
Weight with Technopolymer threads	gr. 120
Weight with threaded inserts	gr. 130
Filter pore size	5 μ m - 20 μ m - 50 μ m
Bowl capacity	18 cm ³
Assembly positions	Vertical
Max. fitting torque (with Technopolymer threads)	G1/4" = 9 Nm
Max. fitting torque (with threaded inserts)	G1/8" = 15 Nm G1/4" = 20 Nm

Ordering code

V171CF502

VERSION

- V N = Metal inserts
- T = Technopolymer thread

CONNECTIONS

- A = G1/8" (only for "N" version)
- B = G1/4"
- C = 1/4 NPT (only for "N" version)

FILTER PORE SIZE

- A = 5 μ m
- B = 20 μ m
- C = 50 μ m

OPTIONS

- = Standard *
- S = Automatic drain

BOWL OPTIONS

- = Standard *
- N = Nylon bowl

* no additional letter required

Coalescing filter (D)

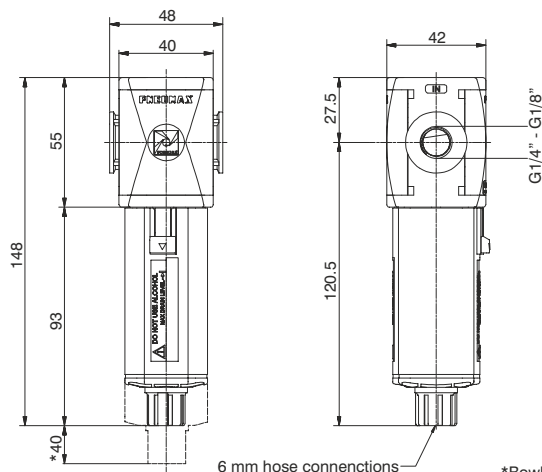

6 mm hose connections

*Bowl removal maximum height

Example : T171BDA : Coalescing size 1, Filter with Technopolymer threads, G1/4" connections, filter efficiency 99,97%

Flow rate curves

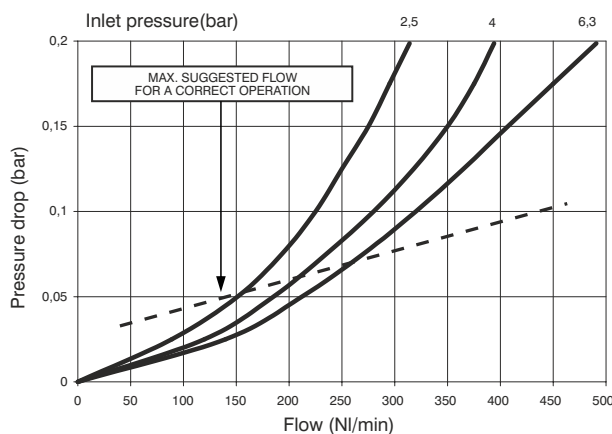

Operational characteristics

- Coalescing filter element with filtration grade of 0.01 μm
- Transparent bowl made off polycarbonate with bowl protection guard.
- Bowl assembly via bayonet type quick coupling mechanism with safety button.
- Semi-automatic drain mounted as standard; automatic drain upon request

Note

In order to ensure a better grade of filtration it is recommended to use a 5 μm filter before the coalescing filter. In order to ensure adequate flow on the auto drain version it is recommended to use minimum a 6mm fitting.

Technical characteristics

Connections	G 1/8" - G 1/4"
Max. inlet pressure	13 bar
Minimum working pressure with automatic drain	0,5 bar
Maximum working pressure with automatic drain	10 bar
Working temperature	-5°C +50°C
Weight with Technopolymer threads	gr. 125
Weight with threaded inserts	gr. 135
Filter efficiency with 0,01 μm particle	99,97%
Bowl capacity	18cm ³
Assembly positions	Vertical
Max. fitting torque (with Technopolymer threads)	G1/4" = 9 Nm
Max. fitting torque (with threaded inserts)	G1/8" = 15 Nm G1/4" = 20 Nm

Ordering code

V1710DE002

VERSION

- V N = Metal inserts
- T = Technopolymer thread

CONNECTIONS

- A = G1/8" (only for "N" version)
- B = G1/4"
- C = 1/4 NPT (only for "N" version)

FILTER EFFICIENCY

- A = 99,97%

OPTIONS

- = Standard *
- S = Automatic drain

BOWL OPTIONS

- = Standard *
- N = Nylon bowl

* no additional letter required

Regulator (R)

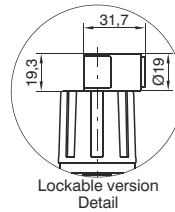
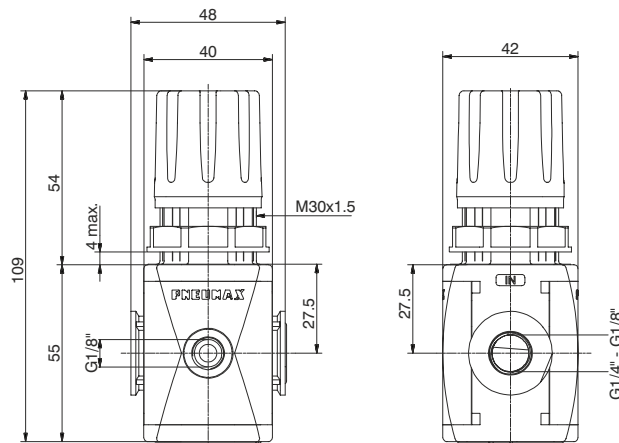

Example: T171BRC : size 1, Regulator with Technopolymer threads, G1/4" connections, 0 to 8 bar adjusting range

Flow rate curves

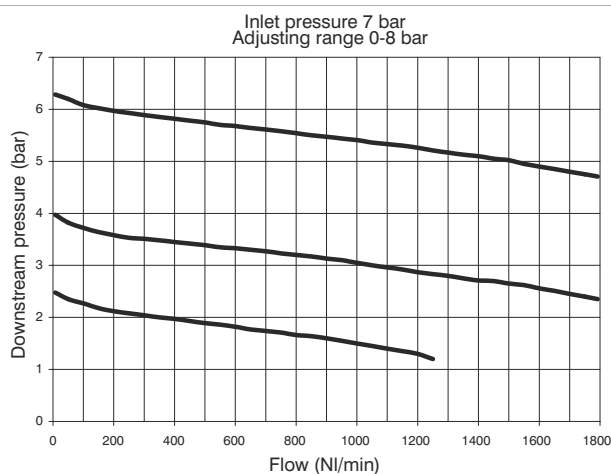

Adjustment characteristics

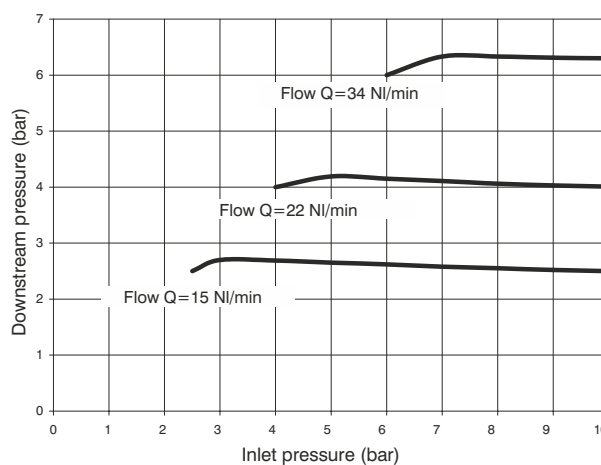

Operational characteristics

- Diaphragm pressure regulator with relieving.
- Low hysteresis rolling diaphragm.
- Balanced system.
- Available in four pressure ranges up to 12 bar.
- Operating knob can be locked in position by pressing it down once the desired P2 (regulated pressure) pressure value is achieved.
- Fitted with panel mounting locking ring.

Note

The pressure must be always regulating while increasing. For a more precise regulation and higher sensibility, the use of a regulator with a pressure range as close as possible to the regulated pressure is recommended.

Technical characteristics

Connections	G 1/8" - G 1/4"
Max. inlet pressure	13 bar
Working temperature	-5°C + 50°C
Pressure gauge connections	G 1/8"
Weight with Technopolymer threads	gr. 130
Weight with threaded inserts	gr. 140
Pressure range	0-2 bar / 0-4 bar 0-8 bar / 0-12 bar
Assembly positions	Indifferent
Max. fitting torque (with Technopolymer threads)	G1/8" = 4 Nm G1/4" = 9 Nm
Max. fitting torque (with threaded inserts)	G1/8" = 15 Nm G1/4" = 20 Nm

Ordering code

V1710RG10

VERSION	
V N = Metal inserts	
T = Technopolymer thread	
CONNECTIONS	
A = G1/8" (only for "N" version)	
B = G1/4"	
C = 1/4 NPT (only for "N" version)	
ADJUSTING RANGE	
A = 0-2 bar	
B = 0-4 bar	
C = 0-8 bar	
D = 0-12 bar	
TYPE	
= Standard *	
F = Controlled relief + improved relieving	
L = no relieving	
R = Improved relieving	
OPTIONS	
= Standard *	
K = Lockable version	

* no additional letter required

Regulator including gauge (RM)(RW)

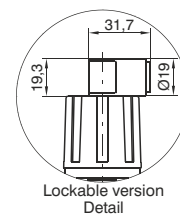
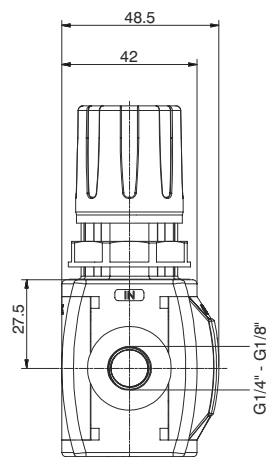
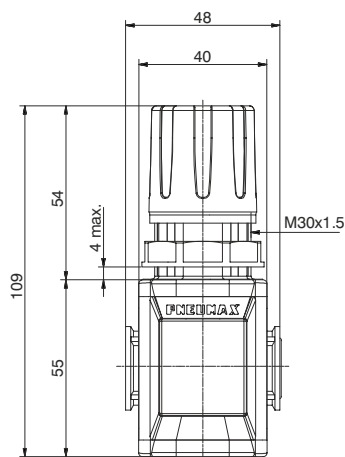

Example : T171BRMC : size 1, Regulator including gauge with Technopolymer threads, G1/4" connections, 0 to 8 bar adjusting range

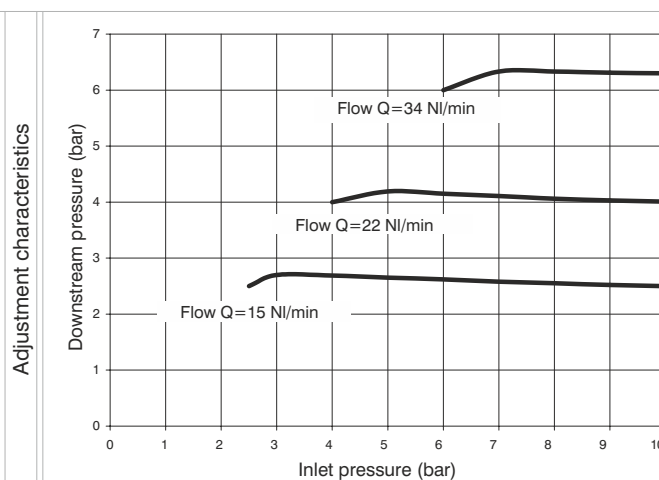
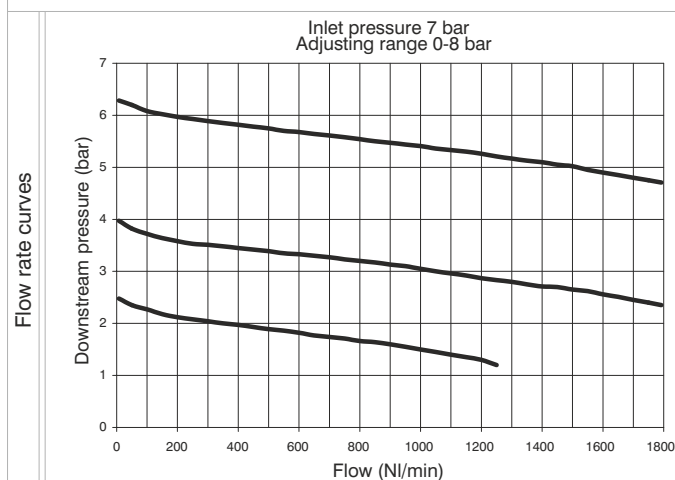

Operational characteristics

- Diaphragm pressure regulator with relieving.
- Low hysteresis rolling diaphragm.
- Balanced system.
- Available in four pressure ranges up to 12 bar.
- Operating knob can be locked in position by pressing it down once the desired P2 (regulated pressure) pressure value is achieved.
- Fitted with panel mounting locking ring.
- Integrated manometer 0-12 bar as standard (for 0-8 and 0-12 bar range) and 0-4 bar (for 0-2 and 0-4 range)

Note

The pressure must be always regulating while increasing. For a more precise regulation and higher sensibility, the use of a regulator with a pressure range as close as possible to the regulated pressure is recommended.

Technical characteristics

Connections	G 1/8" - G 1/4"
Max. inlet pressure	13 bar
Working temperature	-5°C +50°C
Weight with Technopolymer threads	gr. 140
Weight with threaded inserts	gr. 150
Pressure range	0-2 bar / 0-4 bar 0-8 bar / 0-12 bar
Assembly positions	Indifferent
Max. fitting torque (with Technopolymer threads)	G1/4" = 9 Nm

Max. fitting torque
(with threaded inserts)

G1/8" = 15 Nm
G1/4" = 20 Nm

Ordering code

V171CRDGT0

VERSION	
N = Metal inserts	
T = Technopolymer thread	
CONNECTIONS	
A = G1/8" (only for "N" version)	
B = G1/4"	
C = 1/4 NPT (only for "N" version)	
FLOW DIRECTION	
M = from left to right	
W = from right to left	
ADJUSTING RANGE	
A = 0-2 bar	
B = 0-4 bar	
C = 0-8 bar	
D = 0-12 bar	
TYPE	
= Standard *	
F = Controlled relief + improved relieving	
L = no relieving	
R = Improved relieving	
OPTIONS	
= Standard *	
K = Lockable version	

* no additional
letter required

Modular pressure regulator (B)

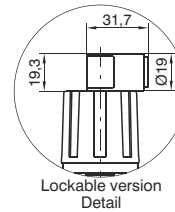
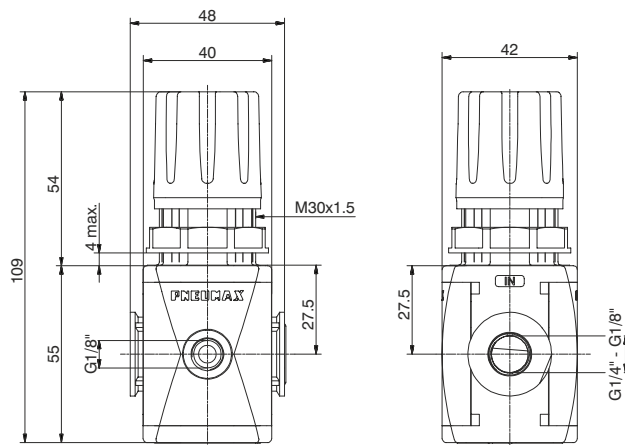

Example: T171BBC : size 1, Regulator with Technopolymer threads, G1/4" connections, 0 to 8 bar adjusting range

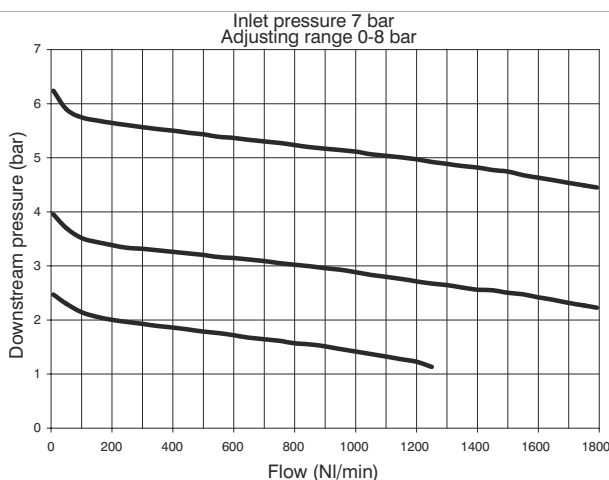

Operational characteristics

- Diaphragm pressure regulator with relieving.
- Low hysteresis rolling diaphragm.
- Balanced system.
- Available in four pressure ranges up to 12 bar.
- Operating knob can be locked in position by pressing it down once the desired P2 (regulated pressure) pressure value is achieved.
- G1/8" output front connection.
- Air supply can be applied by both directions.

Note

The pressure must be always regulating while increasing. For a more precise regulation and higher sensibility, the use of a regulator with a pressure range as close as possible to the regulated pressure is recommended.

Technical characteristics

Connections	G 1/8" - G 1/4"
Max. inlet pressure	13 bar
Working temperature	-5°C +50°C
Pressure gauge connections	G 1/8"
Weight with Technopolymer threads	gr. 130
Weight with threaded inserts	gr. 140
Pressure range	0-2 bar / 0-4 bar 0-8 bar / 0-12 bar
Assembly positions	Indifferent
Max. fitting torque (with Technopolymer threads)	G1/8" = 4 Nm G1/4" = 9 Nm
Max. fitting torque (with threaded inserts)	G1/8" = 15 Nm G1/4" = 20 Nm

Ordering code

V171BBC10

VERSION	
V N = Metal inserts	
T = Technopolymer thread	
CONNECTIONS	
A = G1/8" (only for "N" version)	
B = G1/4"	
C = 1/4 NPT (only for "N" version)	
ADJUSTING RANGE	
A = 0-2 bar	
B = 0-4 bar	
C = 0-8 bar	
D = 0-12 bar	
TYPE	
= Standard *	
F = Controlled relief + improved relieving	
L = no relieving	
R = Improved relieving	
OPTIONS	
= Standard *	
K = Lockable version	

* no additional letter required

Modular pressure regulator including manometer (M)

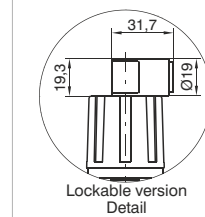
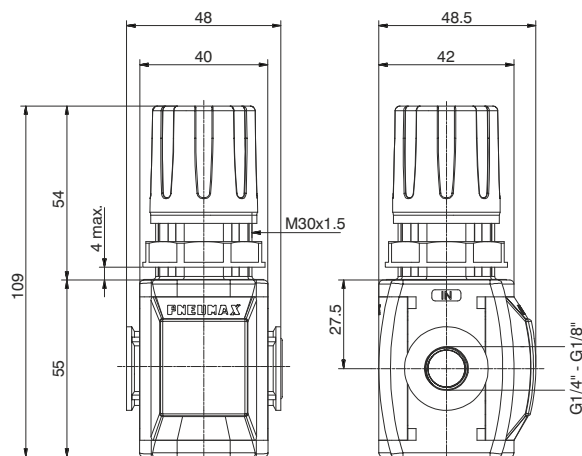

Example : T171BMC : size 1, Regulator including gauge with Technopolymer threads, G1/4" connections, 0 to 8 bar adjusting range

Flow rate curves

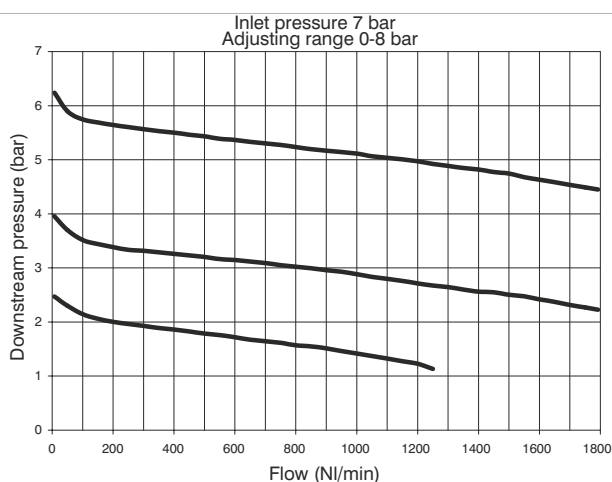

Operational characteristics

- Diaphragm pressure regulator with relieving.
- Low hysteresis rolling diaphragm.
- Balanced system.
- Available in four pressure ranges up to 12 bar.
- Operating knob can be locked in position by pressing it down once the desired P2 (regulated pressure) pressure value is achieved.
- G 1/8" output connection positioned on the opposite side of the built in gauge.
- Air supply can be applied by both directions.
- Integrated manometer 0-12 bar as standard (for 0-8 and 0-12 bar range) and 0-4 bar (for 0-2 and 0-4 range)

Note

The pressure must be always regulating while increasing. For a more precise regulation and higher sensibility, the use of a regulator with a pressure range as close as possible to the regulated pressure is recommended.

Technical characteristics

Connections	G 1/8" - G 1/4"
Max. inlet pressure	13 bar
Working temperature	-5°C +50°C
Weight with Technopolymer threads	gr. 140
Weight with threaded inserts	gr. 150
Pressure range	0-2 bar / 0-4 bar 0-8 bar / 0-12 bar
Assembly positions	Indifferent
Max. fitting torque (with Technopolymer threads)	G1/8" = 4 Nm G1/4" = 9 Nm
Max. fitting torque (with threaded inserts)	G1/8" = 15 Nm G1/4" = 20 Nm

Ordering code

V171CMGT0

VERSION	
N = Metal inserts	
T = Technopolymer thread	
CONNECTIONS	
A = G1/8" (only for "N" version)	
B = G1/4"	
C = 1/4 NPT (only for "N" version)	
ADJUSTING RANGE	
A = 0-2 bar	
B = 0-4 bar	
C = 0-8 bar	
D = 0-12 bar	
TYPE	
= Standard *	
F = Controlled relief + improved relieving	
L = no relieving	
R = Improved relieving	
OPTIONS	
= Standard *	
K = Lockable version	

* no additional letter required

Manifold pressure regulators

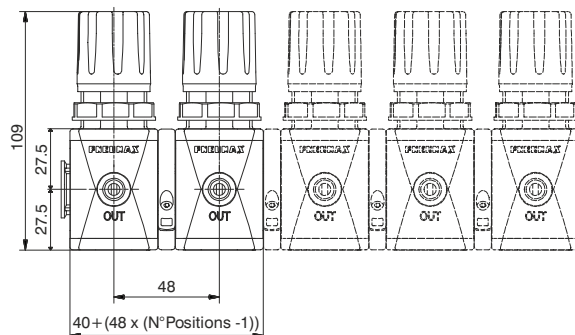

Example: GT171BB4CCCC : Combined group comprising 4 size 1 Regulators Technopolymer threads, G1/4" connections and 0 to 8 bar adjusting range

Flow rate curves

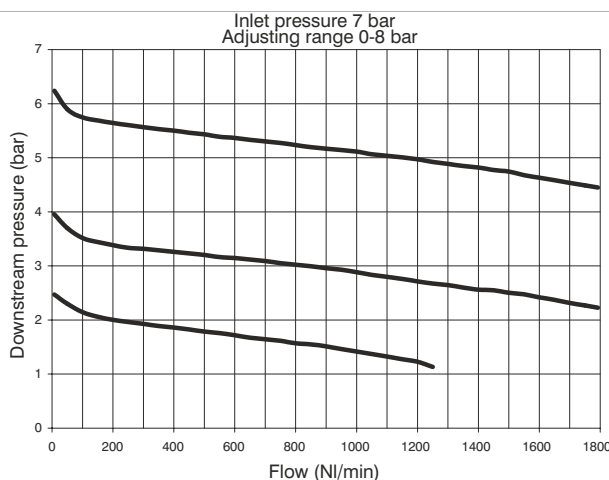

Operational characteristics

- Inlet pressure common for the whole manifold of regulator.
- A maximum of 6 regulators can be mounted
- Air supply can be applied by both directions.

Note

The pressure must be always regulating while increasing. For a more precise regulation and higher sensibility, the use of a regulator with a pressure range as close as possible to the regulated pressure is recommended.

Technical characteristics

Connections	G 1/8" - G 1/4"
Max. inlet pressure	13 bar
Working temperature	-5°C + 50°C
Pressure range	0-2 bar / 0-4 bar 0-8 bar / 0-12 bar
Assembly positions	indifferent
Max. fitting torque (with Technopolymer threads)	G1/8" = 4 Nm G1/4" = 9 Nm
Max. fitting torque (with threaded inserts)	G1/8" = 15 Nm G1/4" = 20 Nm

Ordering code

GV171CTNGGGGGGG

VERSION	
V	N = Metal inserts T = Technopolymer thread
CONNECTIONS	
G	A = G1/8" (only for "N" version) B = G1/4" C = 1/4 NPT (only for "N" version)
TYPE	
T	B = Standard with flanges X M = Manometer included with flanges X W = Standard with flanges Y Z = Manometer included with flanges Y
NUMBER REGULATORS	
N	2 = 2 regulators 3 = 3 regulators 4 = 4 regulators 5 = 5 regulators 6 = 6 regulators
ADJUSTING RANGE 1	
G	A = 0-2 bar B = 0-4 bar C = 0-8 bar D = 0-12 bar
ADJUSTING RANGE 2	
G	A = 0-2 bar B = 0-4 bar C = 0-8 bar D = 0-12 bar
ADJUSTING RANGE 3	
G	A = 0-2 bar B = 0-4 bar C = 0-8 bar D = 0-12 bar
ADJUSTING RANGE 4	
G	A = 0-2 bar B = 0-4 bar C = 0-8 bar D = 0-12 bar
ADJUSTING RANGE 5	
G	A = 0-2 bar B = 0-4 bar C = 0-8 bar D = 0-12 bar
ADJUSTING RANGE 6	
G	A = 0-2 bar B = 0-4 bar C = 0-8 bar D = 0-12 bar

Dimensions with Y type flanges

2 position manifold

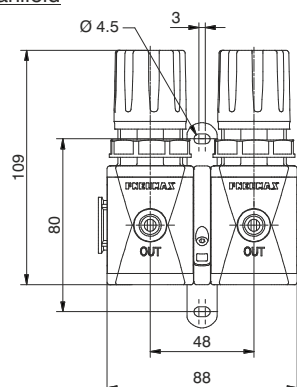

3 position manifold

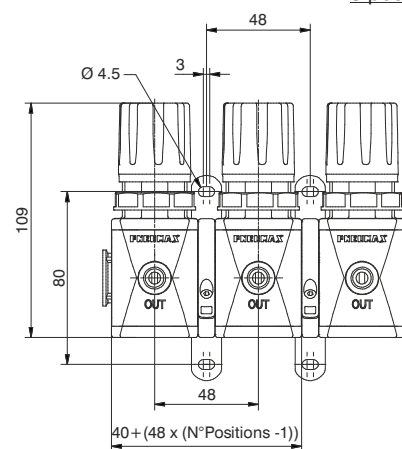

4 position manifold

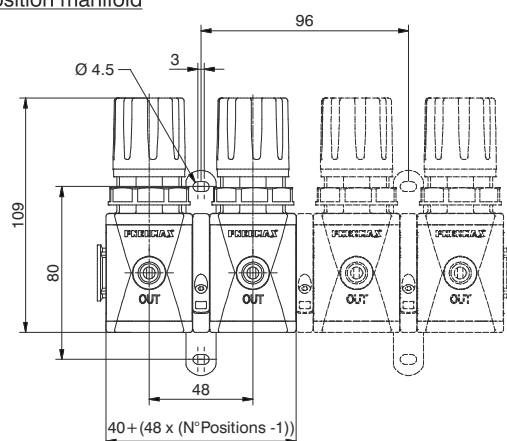

5 position manifold

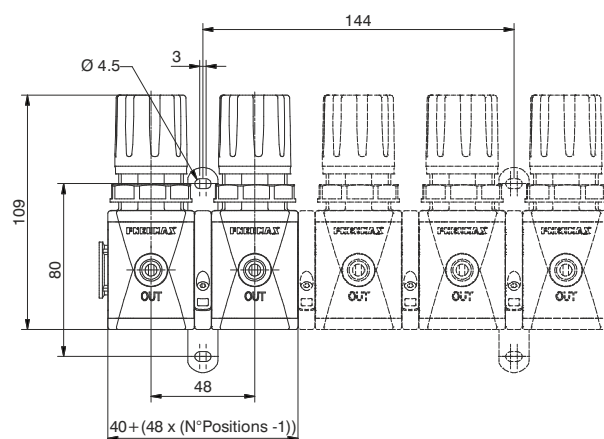

6 position manifold

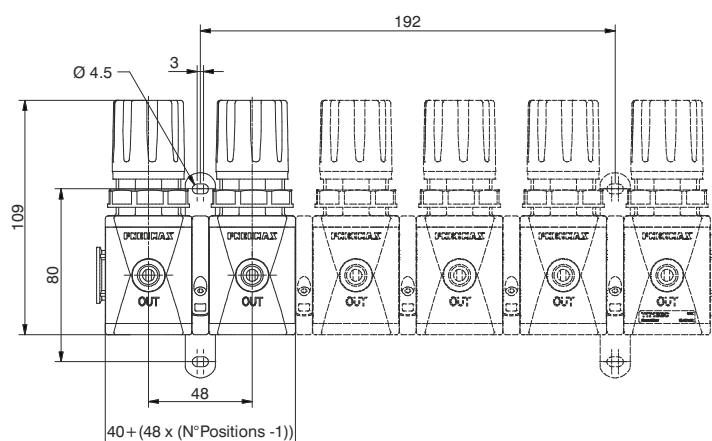

Filter-Regulator (E)

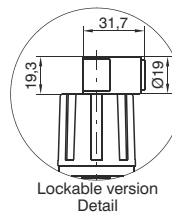
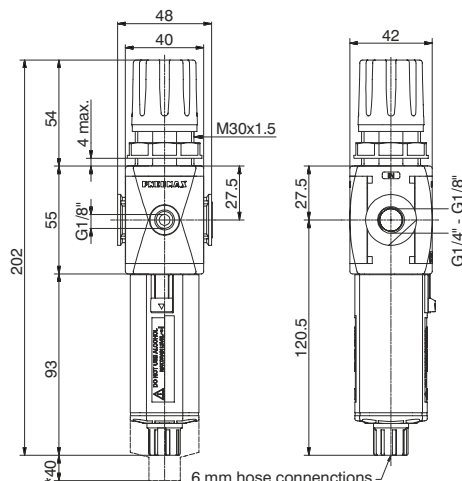

*Bowl removal maximum height

Example : T171BEBC : size 1, Filter-regulator with Technopolymer threads, G1/4" connections, 20 μ m filtering pore size, 0 to 8 bar adjusting range

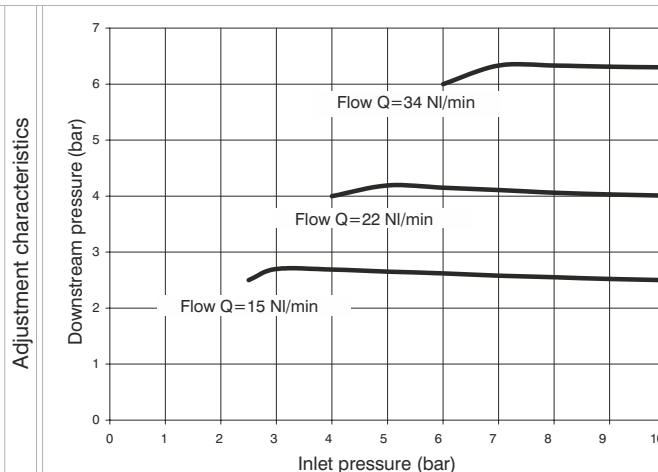
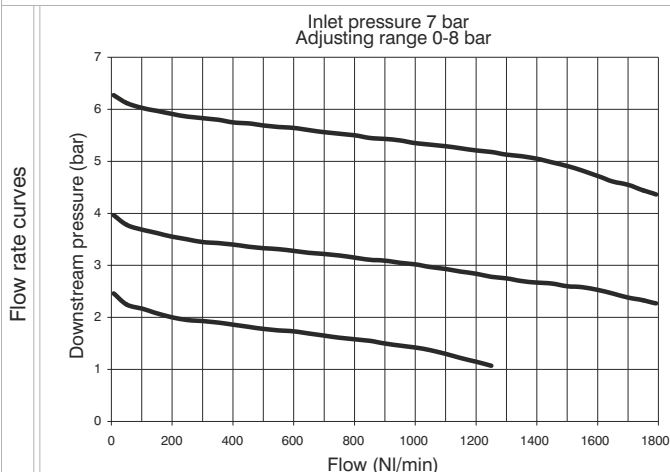

Operational characteristics

- Filter - diaphragm pressure regulator with relieving.
- Low hysteresis rolling diaphragm.
- Balanced system.
- Double filtering action: air flow centrifugation and filter element.
- Filtering element made of HDPE (high density polyethylene) available in three different filtration grades (5 μ m, 20 μ m and 50 μ m) can be regenerated by washing it or replaced.
- Transparent bowl made of polycarbonate with bowl protection guard.
- Bowl assembly via bayonet type quick coupling mechanism with safety button.
- Semi-automatic drain mounted as standard; automatic drain upon request
- Available in four pressure ranges up to 12 bar.
- Operating knob can be locked in position by pressing it down once the desired P2 (regulated pressure) pressure value is achieved.
- Fitted with panel mounting locking ring.

Note

The pressure must be always regulating while increasing. For a more precise regulation and higher sensibility, the use of a regulator with a pressure range as close as possible to the regulated pressure is recommended. In order to ensure adequate flow on the auto drain version it is recommended to use minimum a 6mm fitting.

Technical characteristics

Connections	G 1/8" - G 1/4"	Ordering code V1710ESG102
Max. inlet pressure	13 bar	
Minimum working pressure with automatic drain	0,5 bar	VERSION V N = Metal inserts T = Technopolymer thread
Maximum working pressure with automatic drain	10 bar	
Working temperature	-5°C +50°C	CONNECTIONS A = G1/8" (only for "N" version) B = G1/4" C = 1/4 NPT (only for "N" version)
Pressure gauge connections	G 1/8"	
Weight with Technopolymer threads	gr. 190	FILTER PORE SIZE A = 5 μ m B = 20 μ m C = 50 μ m
Weight with threaded inserts	gr. 200	
Pressure range	0-2 bar / 0-4 bar 0-8 bar / 0-12 bar	ADJUSTING RANGE A = 0-2 bar B = 0-4 bar C = 0-8 bar D = 0-12 bar
Filter pore size	5 μ m - 20 μ m - 50 μ m	
Bowl capacity	18 cm ³	TYPE 1 = Standard * S = Automatic drain
Assembly positions	Vertical	
Max. fitting torque (with Technopolymer threads)	G1/8" = 4 Nm G1/4" = 9 Nm	OPTIONS 0 = Standard * K = Lockable version
Max. fitting torque (with threaded inserts)	G1/8" = 15 Nm G1/4" = 20 Nm	
		BOWL OPTIONS 2 = Standard * N = Nylon bowl
		* no additional letter required

Filter-regulator including gauge (EM)(EW)

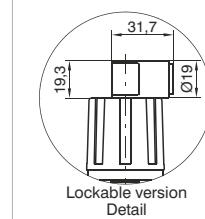
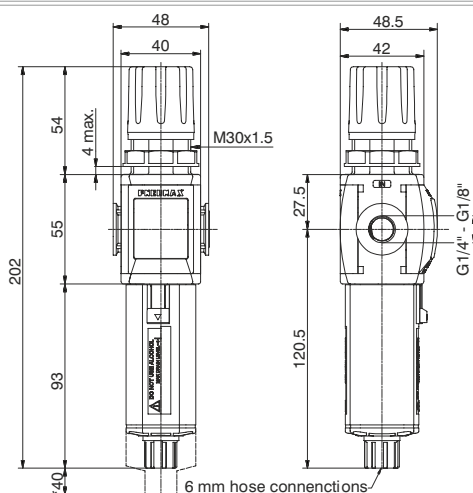

*Bowl removal maximum height

Example: T171BEMBC : size 1, Filter-Regulator including gauge with Technopolymer threads, G1/4" connections, with 20 µm filtering pore size, 0 to 8 bar adjusting range

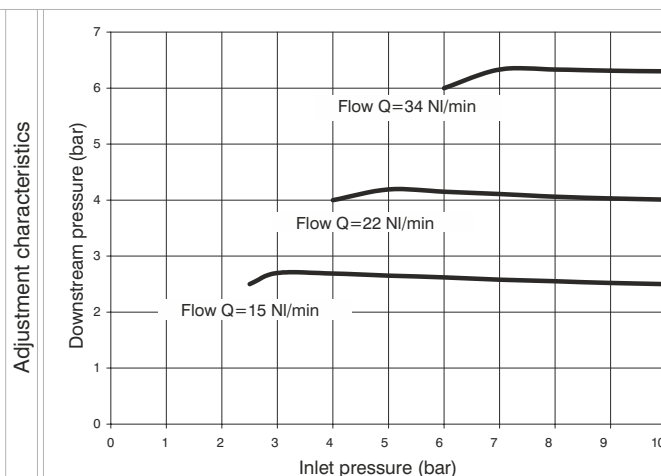
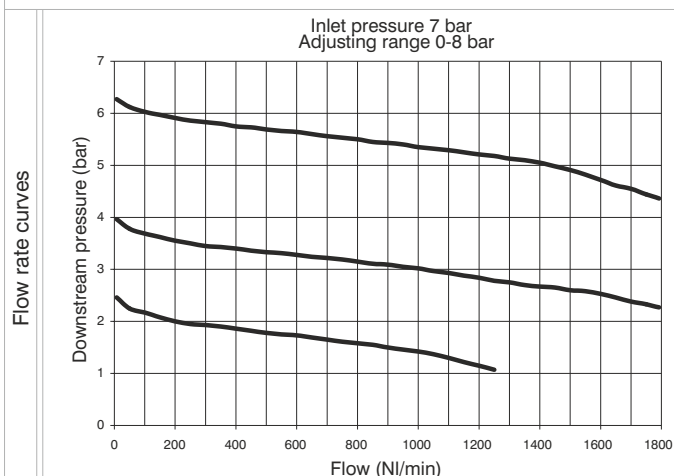

Operational characteristics

- Filter - diaphragm pressure regulator with relieving.
- Low hysteresis rolling diaphragm.
- Balanced system.
- Double filtering action: air flow centrifugation and filter element.
- Filtering element made of HDPE (high density polyethylene) available in three different filtration grades (5µm, 20µm and 50µm) can be regenerated by washing it or replaced.
- Transparent bowl made off polycarbonate with bowl protection guard.
- Bowl assembly via bayonet type quick coupling mechanism with safety button.
- Semi-automatic drain mounted as standard; automatic drain upon request
- Available in four pressure ranges up to 12 bar.
- Operating knob can be locked in position by pressing it down once the desired P2 (regulated pressure) pressure value is achieved.
- Fitted with panel mounting locking ring.
- Integrated manometer 0-12 bar as standard (for 0-8 and 0-12 bar range) and 0-4 bar (for 0-2 and 0-4 range)

Note

The pressure must be always regulating while increasing. For a more precise regulation and higher sensibility, the use of a regulator with a pressure range as close as possible to the regulated pressure is recommended. In order to ensure adequate flow on the auto drain version it is recommended to use minimum a 6mm fitting.

Technical characteristics

Connections	G 1/8" - G 1/4"
Max. inlet pressure	13 bar
Minimum working pressure	0,5 bar
with automatic drain	
Maximum working pressure	10 bar
with automatic drain	
Working temperature	-5°C +50°C
Weight with Technopolymer threads	gr. 200
Weight with threaded inserts	gr. 210
Pressure range	0-2 bar / 0-4 bar 0-8 bar / 0-12 bar
Filter pore size	5 µm - 20 µm - 50 µm
Bowl capacity	18 cm³
Assembly positions	Vertical
Max. fitting torque	G1/4" = 9 Nm
(with Technopolymer threads)	
Max. fitting torque	G1/8" = 15 Nm
(with threaded inserts)	G1/4" = 20 Nm

Ordering code

V171CE0SG10Z

VERSION	
V N = Metal inserts	
T = Technopolymer thread	
CONNECTIONS	
A = G1/8" (only for "N" version)	
B = G1/4"	
C = 1/4 NPT (only for "N" version)	
FLOW DIRECTION	
D M = from left to right	
W = from right to left	
FILTER PORE SIZE	
A = 5 µm	
B = 20 µm	
C = 50 µm	
ADJUSTING RANGE	
A = 0-2 bar	
B = 0-4 bar	
C = 0-8 bar	
D = 0-12 bar	
TYPE	
T = Standard *	
S = Automatic drain	
OPTIONS	
O = Standard *	
K = Lockable version	
BOWL OPTIONS	
Z = Standard *	
N = Nylon bowl	

* no additional letter required

Regulator with pressure switch (RP)(RZ)

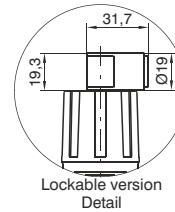
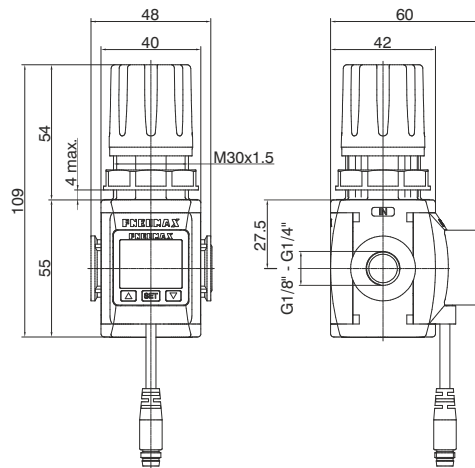

Example : T171BRPCA : size 1, Regulator with Technopolymer threads, G1/4" connections, 0 to 8 bar adjusting range, with pressure switch with M8 connector PNP

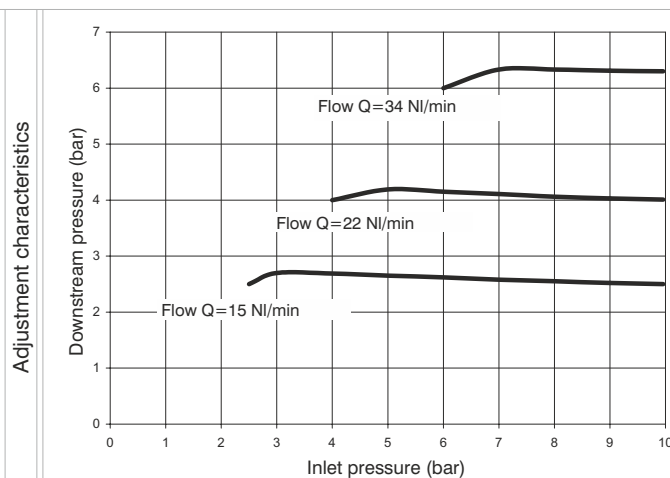
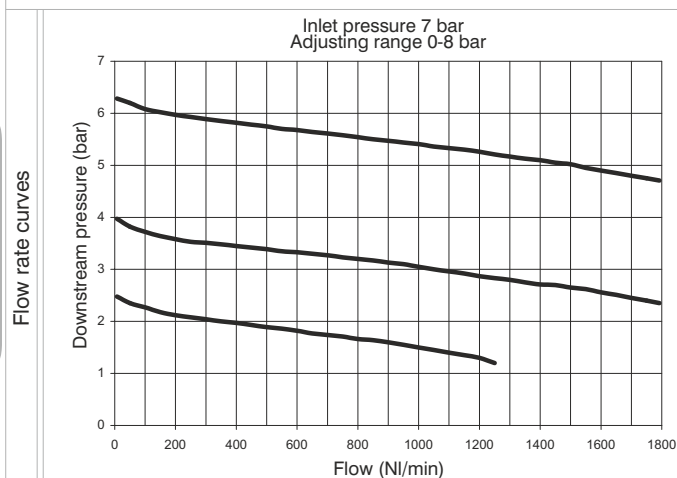

Operational characteristics

- Diaphragm pressure regulator with relieving.
- Low hysteresis rolling diaphragm.
- Balanced system.
- Available in four pressure ranges up to 12 bar.
- Operating knob can be locked in position by pressing it down once the desired P2 (regulated pressure) pressure value is achieved.
- Fitted with panel mounting locking ring.
- Pressure switch as standard

Note

The pressure must be always regulating while increasing. For a more precise regulation and higher sensibility, the use of a regulator with a pressure range as close as possible to the regulated pressure is recommended.

Technical characteristics

Connections	G 1/8" - G 1/4"
Max. inlet pressure	13 bar
Working temperature	0°C +50°C
Weight with Technopolymer threads	gr. 140
Weight with threaded inserts	gr. 150
Pressure range	0-2 bar / 0-4 bar 0-8 bar / 0-12 bar
Assembly positions	Indifferent
Max. fitting torque (with Technopolymer threads)	G1/4" = 9 Nm

Max. fitting torque (with threaded inserts)	G1/8" = 15 Nm G1/4" = 20 Nm
--	--------------------------------

Ordering code

V171OROGTOP

VERSION	
N = Metal inserts	
T = Technopolymer thread	
CONNECTIONS	
A = G1/8" (only for "N" version)	
B = G1/4"	
C = 1/4 NPT (only for "N" version)	
FLOW DIRECTION	
P = from left to right	
Z = from right to left	
ADJUSTING RANGE	
A = 0-2 bar	
B = 0-4 bar	
C = 0-8 bar	
D = 0-12 bar	
TYPE	
= Standard *	
F = Controlled relief + improved relieving	
L = no relieving	
R = Improved relieving	
OPTIONS	
= Standard *	
K = Lockable version	
PRESSURE SWITCH OPTION	
A = Cable 150 mm + M8 PNP	
B = Cable 150 mm + M8 NPN	
C = Cable 2 mt. PNP	
D = Cable 2 mt. NPN	

* no additional letter required

Filter regulator with pressure switch (EP)(EZ)

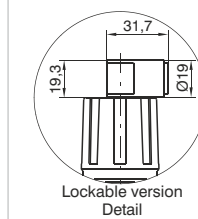
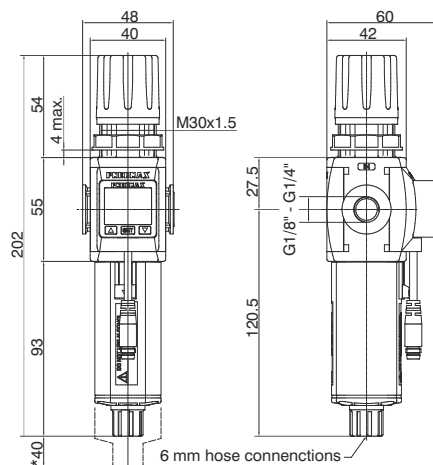

* Bowl removal maximum height

Example: T171BEPBCA : size 1, Filter-regulator with Technopolymer threads, G1/4" connections, 20 µm filtering pore size, 0 to 8 bar adjusting range, with pressure switch with M8 connector PNP

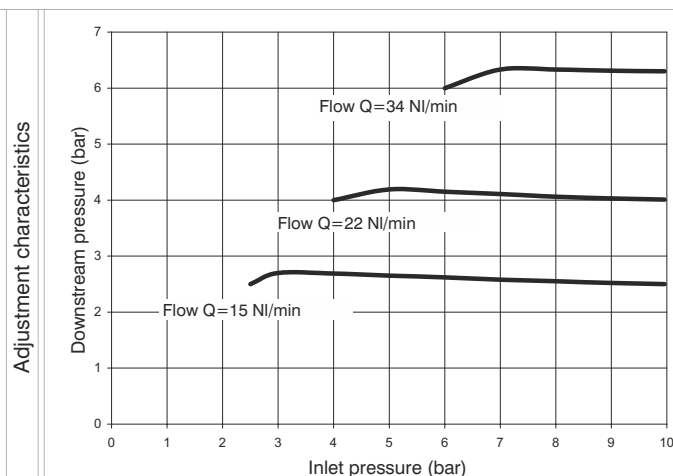
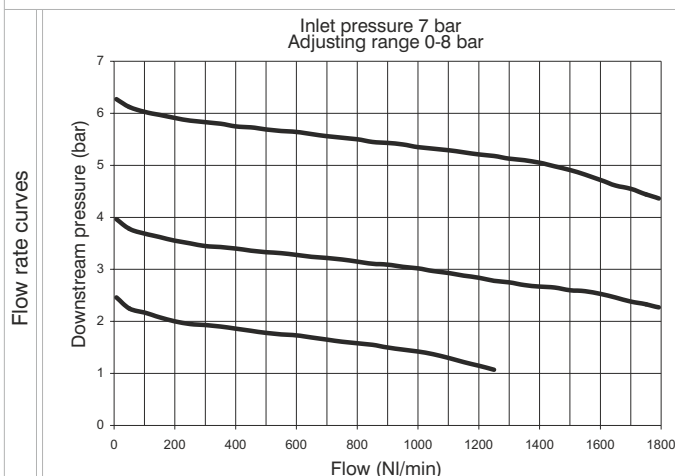

Operational characteristics

- Filter - diaphragm pressure regulator with relieving.
- Low hysteresis rolling diaphragm.
- Balanced system.
- Double filtering action: air flow centrifugation and filter element.
- Filtering element made of HDPE (high density polyethylene) available in three different filtration grades (5µm, 20µm and 50µm) can be regenerated by washing it or replaced.
- Transparent bowl made off polycarbonate with bowl protection guard.
- Bowl assembly via bayonet type quick coupling mechanism with safety button.
- Semi-automatic drain mounted as standard; automatic drain upon request
- Available in four pressure ranges up to 12 bar.
- Operating knob can be locked in position by pressing it down once the desired P2 (regulated pressure) pressure value is achieved.
- Fitted with panel mounting locking ring.
- Pressure switch as standard

Note

The pressure must be always regulating while increasing. For a more precise regulation and higher sensibility, the use of a regulator with a pressure range as close as possible to the regulated pressure is recommended. In order to ensure adequate flow on the auto drain version it is recommended to use minimum a 6mm fitting.

Technical characteristics

Connections	G 1/8" - G 1/4"
Max. inlet pressure	13 bar
Minimum working pressure	0,5 bar
Maximum working pressure	10 bar
Working temperature	0°C +50°C
Weight with Technopolymer threads	gr. 200
Weight with threaded inserts	gr. 210
Pressure range	0-2 bar / 0-4 bar 0-8 bar / 0-12 bar
Filter pore size	5 µm - 20 µm - 50 µm
Bowl capacity	18 cm ³
Assembly positions	Vertical
Max. fitting torque	G1/4" = 9 Nm

Max. fitting torque
(with threaded inserts)

G1/8" = 15 Nm
G1/4" = 20 Nm

Ordering code

V171CEDSSGTOPZ

VERSION	
N = Metal inserts	
T = Technopolymer thread	
CONNECTIONS	
A = G1/8" (only for "N" version)	
B = G1/4"	
C = 1/4 NPT (only for "N" version)	
FLOW DIRECTION	
P = from left to right	
Z = from right to left	
FILTER PORE SIZE	
A = 5 µm	
B = 20 µm	
C = 50 µm	
ADJUSTING RANGE	
A = 0-2 bar	
B = 0-4 bar	
C = 0-8 bar	
D = 0-12 bar	
TYPE	
T = Standard *	
S = Automatic drain	
OPTIONS	
O = Standard *	
K = Lockable version	
PRESSURE SWITCH OPTION	
A = Cable 150 mm + M8 PNP	
B = Cable 150 mm + M8 NPN	
C = Cable 2 mt. PNP	
D = Cable 2 mt. NPN	
BOWL OPTIONS	
N = Standard *	
N = Nylon bowl	

* no additional
letter required



CHARACTERISTICS

- 3 color digital LCD display, easy readout
- 4 units of measurement for pressure indication
- PNP and NPN output
- N.O. and N.C. output contact
- Not available individually, but only with a Regulator or a Filter-regulator

OUTPUT CIRCUIT WIRING DIAGRAMS

PNP output

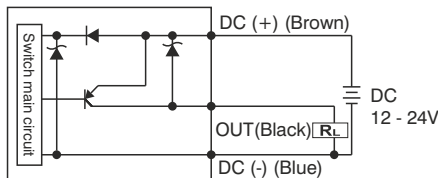

NPN output

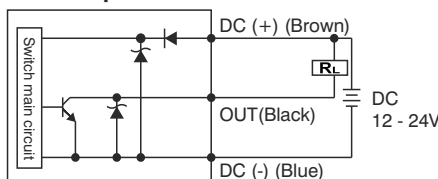

M8 CONNECTOR PIN LAY OUT

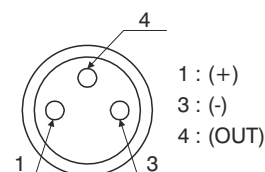

3 WIRES CABLE LAY OUT

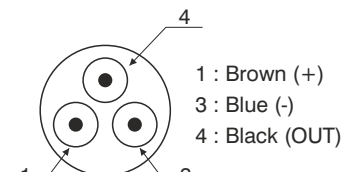

Cable ordering code

- MCH1** cable 3 wires l=2,5m with M8 connector
MCH2 cable 3 wires l=5m with M8 connector
MCH3 cable 3 wires l=10m with M8 connector

Connector



TECHNICAL CHARACTERISTICS

Adjusting range	0 - 10 bar / 0 - 1MPa
Max. inlet pressure	15 bar / 1,5 MPa
Fluid	Filtered and dehumidified air
Display unit of measurement	MPa - kgf/cm ² - bar - psi
Supply voltage	12 - 24 VDC
Current consumption	≤40mA (without load)
Digital output type	NPN - PNP
Type of contact	Normally Open - Normally Closed
Max. load current	125 mA
Digital output activation mode	single threshold with fixed hysteresis - window with fixed hysteresis - window without hysteresis
Digital output activation time	0.05s - 0.25s - 0.5s - 1s - 2s - 3s (selections for chattering-proof function)
Display characteristics	Double 3 1/2 digit display Digital output status indication Three-pushbuttons touchpad
Indicator accuracy	≤±2% F.S. ± 1 digit
Protection grade	IP 40
Temperature	0 - 50 °C
Cable section	3 x 0,129mm ² , Ø4 mm, PVC

Lubricator (L)

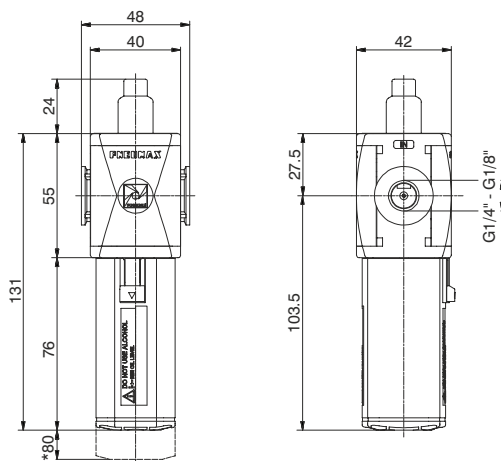

*Bowl removal maximum height

Example : T171BL : size 1, Lubricator with Technopolymer threads, G1/4" connections

Flow rate curves

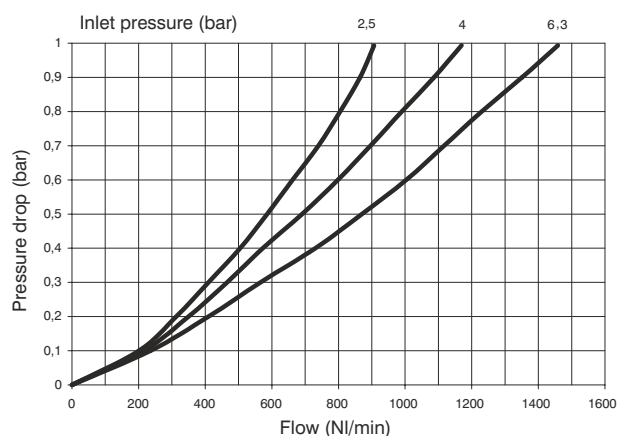

Operational characteristics

- Oil mist lubrication with variable orifice size in function of the flow rate
- Oil quantity regulation mechanism and oil quantity visualization dome made of polycarbonate.
- Transparent bowl made off polycarbonate with bowl protection guard.
- Bowl assembly via bayonet type quick coupling mechanism with safety button.

Note

Install as close as possible to the point of use
Do not use alcohol, detergent oils or solvents.

Technical characteristics

Connections	G 1/8" - G 1/4"
Max. inlet pressure	13 bar
Working temperature	-5°C +50°C
Weight with Technopolymer threads	gr. 110
Weight with threaded inserts	gr. 120
Indicative oil drop rate	1 drop every 300/600 NI
Oil type	FD22 - HG32
Bowl capacity	36 cm ³
Assembly positions	Vertical
Max. fitting torque (with Technopolymer threads)	G1/4" = 9 Nm
Max. fitting torque (with threaded inserts)	G1/8" = 15 Nm G1/4" = 20 Nm
Min. operational flow at 6,3 bar	40 NI/min.

Ordering code

V171CL2

- VERSION
- V N = Metal inserts
 - T = Technopolymer thread
- CONNECTIONS
- A = G1/8" (only for "N" version)
 - B = G1/4"
 - C = 1/4 NPT (only for "N" version)
- BOWL OPTIONS
- Z = Standard *
 - N = Nylon bowl

* no additional letter required

Shut-off valve (VL)

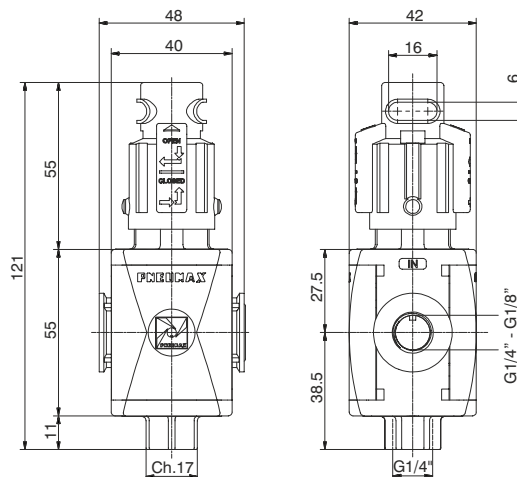

Example: T171BVL : size 1, Shut-off valve with Technopolymer threads, G1/4" connections

Operational characteristics	Technical characteristics		
<ul style="list-style-type: none"> - Manual operated 3 ways poppet valve. - Double handle action for valve opening: pushing and rotating (clockwise). - The valve can be closed and the down stream circuit depressurized by rotating anticlockwise the knob. - Knob lockable with three padlocks. 	Connections	G 1/8" - G 1/4"	Ordering code
	Max. inlet pressure	13 bar	V171CVL
	Discharge connection	G1/4"	
	Working temperature	-5°C +50°C	VERSION V N = Metal inserts T = Technopolymer thread
	Weight with Technopolymer threads	gr. 100	
	Weight with threaded inserts	gr. 110	CONNECTIONS C A = G1/8" (only for "N" version) B = G1/4" C = 1/4 NPT (only for "N" version)
	Assembly positions	Indifferent	
	Handle opening and closing angle	90°	
	Max. fitting torque (with Technopolymer threads)	G1/4" = 9 Nm	
	Max. fitting torque (with threaded inserts)	G1/8" = 15 Nm G1/4" = 20 Nm	
	Nominal flow rate at 6 bar with $\Delta p=1$	1400 NI/min.	
	Exhaust nominal flow rate at 6 bar with $\Delta p=1$	550 NI/min.	

Pneumatic shut-off valve (VP)

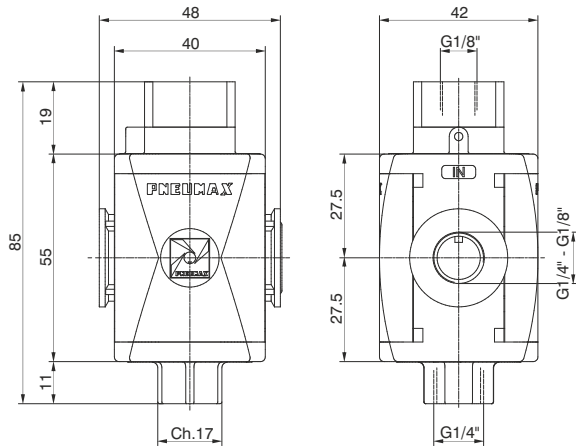

Example: T171BVP : size 1, Pneumatic shut-off valve with Technopolymer threads, G1/4" connections

Operational characteristics	Technical characteristics		
<div>- Pneumatic operated 3 ways poppet valve.</div> <div>- When the pneumatic signal is removed the valves exhaust the pneumatic circuit</div>	Connections	G 1/8" - G 1/4"	Ordering code
	Discharge connection	G1/4"	V171CVP
	Pilot port size	G1/8"	VERSION
	Working temperature	-5°C +50°C	V N = Metal inserts
	Weight with technopolymer threads	gr. 94	T = Technopolymer thread
	Weight with threaded inserts	gr. 99	CONNECTIONS
	Assembly positions	Indifferent	C A = G1/8" (only for "N" version)
	Min. pressure working	3 bar	B = G1/4"
	Max. pressure working	10 bar	C = 1/4 NPT (only for "N" version)
	Max. fitting torque (with Technopolymer threads)	G1/4" = 9 Nm	
	Max. fitting torque (with threaded inserts)	G1/8" = 15 Nm G1/4" = 20 Nm	
	Nominal flow rate at 6 bar with Δp=1	1400 NI/min.	
	Exhaust nominal flow rate at 6 bar with Δp=1	550 NI/min.	

Electric shut-off valve (VE)

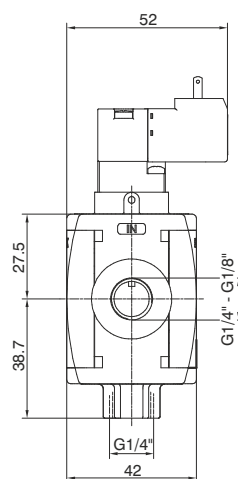
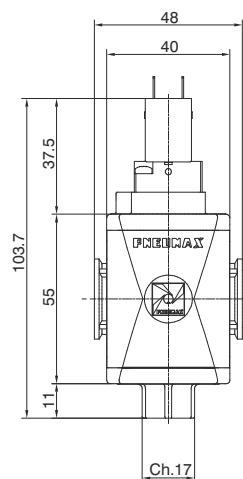
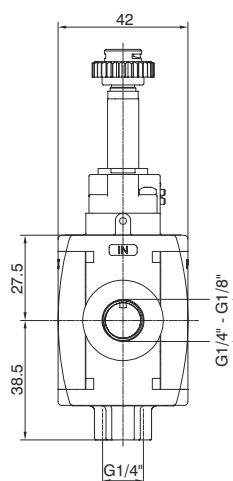
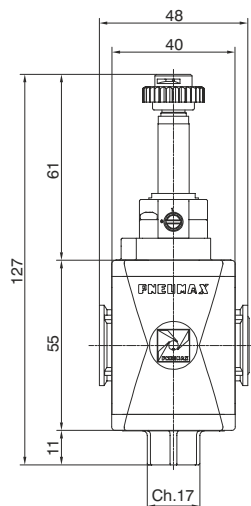

Example : T171BVEB2 : size 1, Electric shut-off valve, with M2 pilot without coil, Technopolymer threads, G1/4" connections

Operational characteristics	Technical characteristics		Ordering code
<ul style="list-style-type: none"> - Solenoid operated 3 ways poppet valve. - The model fitted with 15 mm pilots uses pilots series N33_0A and N33_0E (1 Watt) 	Supply and operating connections	G 1/8" - G 1/4"	V171CVEA VERSION N = Metal inserts T = Technopolymer thread
	Discharge connections	G 1/4"	
	Working temperature	-5°C +50°C	CONNECTIONS A = G1/8" (only for "N" version) B = G1/4" C = 1/4 NPT (only for "N" version)
	Weight with Technopolymer threads	130 g	
	Weight with threaded inserts	140 g	15 mm COIL VOLTAGE A4 = 12 V DC A5 = 24 V DC A6 = 24 V AC (50-60 Hz) A7 = 110 V AC (50-60 Hz) A8 = 230 V AC (50-60 Hz) A9 = 24 V DC (1 Watt)
	Assembly positions	Indifferent	
	Min. Pressure working	3 bar	22 mm COIL VOLTAGE B2 = Without coil M2 mechanic A
	Max. Pressure working	10 bar	
	Max. fitting torque (with Technopolymer threads)	G1/4" = 9 Nm	30 mm COIL VOLTAGE C5 = 24 V DC C6 = 24 V AC (50-60 Hz) C7 = 110 V AC (50-60 Hz) C8 = 230 V AC (50-60 Hz) C9 = 24 V DC (2 Watt)
	Max. fitting torque (with threaded inserts)	G1/8" = 15 Nm G1/4" = 20 Nm	
	Nominal flow rate at 6 bar with $\Delta p=1$	1400 NI/min.	
	Exhaust nominal flow rate at 6 bar with $\Delta p=1$	550 NI/min.	

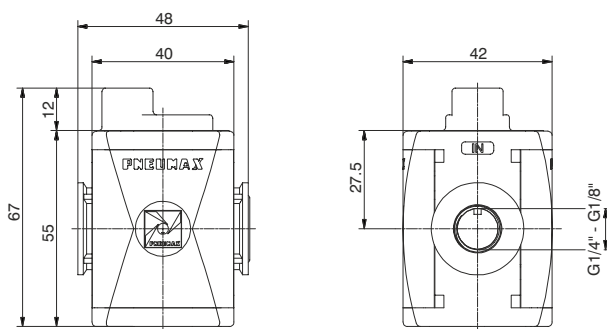
Progressive start-up valve (AP)

Example : T171BAP : size 1, Progressive start-up valve with Technopolymer threads, G1/4" connections

Operational characteristics	Technical characteristics		
<ul style="list-style-type: none"> - Down stream circuit filling time regulated via a built in flow regulator. - Full pressure is allowed once the down stream circuit pressure reaches 50% of the inlet pressure. 	Connections	G 1/8" - G 1/4"	Ordering code
	Max. inlet pressure	13 bar	
	Working temperature	-5°C +50°C	V171CAP VERSION N = Metal inserts T = Technopolymer thread
	Weight with Technopolymer threads	gr. 70	
	Weight with threaded inserts	gr. 80	CONNECTIONS A = G1/8" (only for "N" version) B = G1/4" C = 1/4 NPT (only for "N" version)
	Max. fitting torque (with Technopolymer threads)	G1/4" = 9 Nm	
	Max. fitting torque (with threaded inserts)	G1/8" = 15 Nm G1/4" = 20 Nm	
	Assembly positions	Indifferent	
	Min. pressure working	2,5 bar	
	Nominal flow rate at 6 bar with $\Delta p=1$	1400 NI/min.	
	Fully open built in flow regulator flow rate	75 NI/min.	

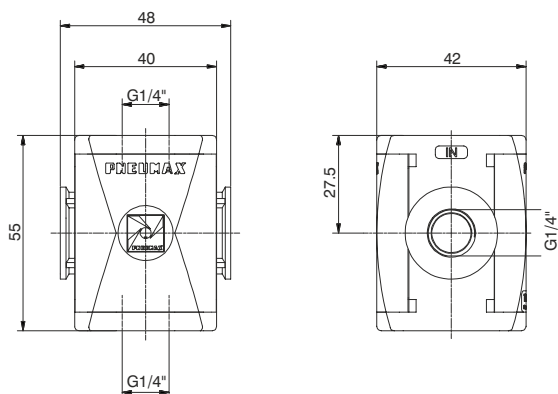
Air intake (PA)

Example : T171BPA : size 1, Air intake with Technopolymer threads, G1/4" connections

Operational characteristics	Technical characteristics		
<ul style="list-style-type: none"> - Available with two G1/4" threaded connections. Attention For this product are available only Technopolymer connections	Connections	G 1/4"	Ordering code
	Max. inlet pressure	13 bar	
	Working temperature	-5°C +50°C	T171BPA
	Weight	gr. 52	
	Assembly positions	Indifferent	
	Max. fitting torque (with Technopolymer threads)	G1/4" = 9 Nm	

Pressure switch (PP)

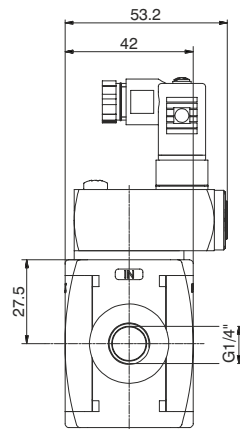
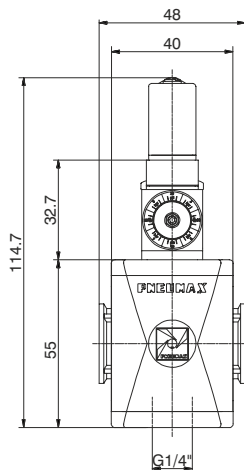

Example: T171BPP : Size 1, Pressure switch with Technopolymer threads, G1/4" connections

Operational characteristics

- Built in adjustable pressure switch (2 to 10 bar) with electrical connection.
- G1/4" threaded connection on the bottom face.
- The electrical connection is made by mean of a 15 mm connector DIN 43650 type C. The microswitch contact could be normally closed or open (change overswitch).

Attention

For this product are available only Technopolymer connections

Technical characteristics

Connections	G 1/4"	Ordering code
Max. inlet pressure	13 bar	T171BPP
Working temperature	-5°C +50°C	
Weight	gr. 138	
Microswitch capacity	1A	
Grade of protection (with connector assembled)	IP 65	
Adjusting range	2 -10 bar	
Assembly positions	Indifferent	
Max. fitting torque (with Technopolymer threads)	G1/4" = 9 Nm	
Microswitch maximum tension	250 VAC	

Connection

- 1 = neutral
- 2 = N.C. contact
- 3 = N.O. contact

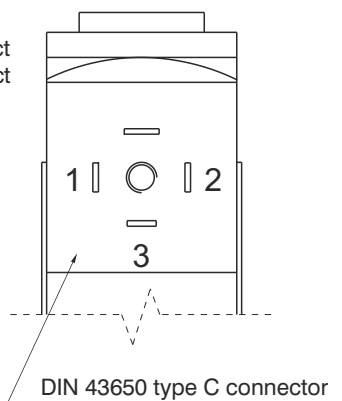

Flange X

Ordering code

T171X

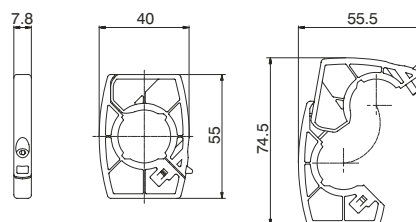

Weight 12 gr.
Example : T171X : Size 1 coupling flange
-Enables the quick connection of two functions

Flange Y

Ordering code

T171Y

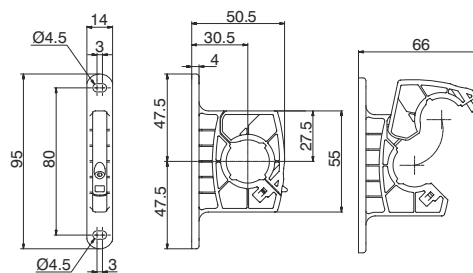

Weight 18 gr.
Example : T171Y : Size 1 coupling flange with mounting holes
- Used to couple together two elements and to panel mount them.
- Used to panel mount one single element.

Single unit panel
mounting dimensions

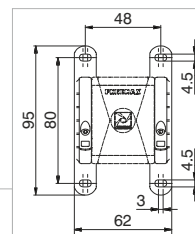

3

Aluminium flange Y

Ordering code

N171Y

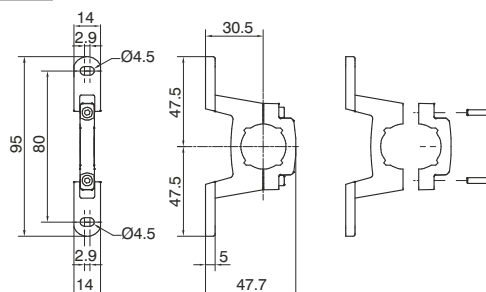

Weight 27 gr.
Example : N171Y : Size 1 coupling aluminium flange with mounting holes
- Used to couple together two elements and to panel mount them.
- Used to panel mount one single element.

Single unit panel
mounting dimensions

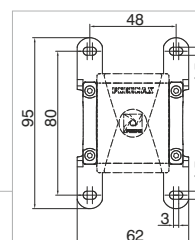

Fixing bracket

Ordering code

17150

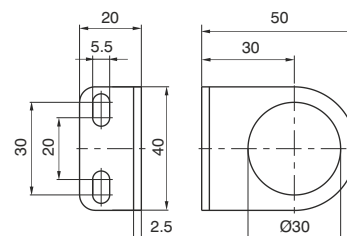

Weight 32 gr.
- Allows for regulators and filter regulators to be panel mounted.

Pressure gauge

Ordering code

17070V.S

VERSION
A = Dial Ø40
B = Dial Ø50
SCALE
A = Scale 0-4 bar
B = Scale 0-6 bar
C = Scale 0-12 bar

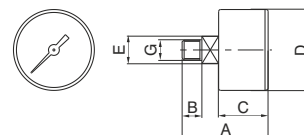

DIMENSIONS						
CODE	A	B	C	D	E	G
17070A	44	10	26	41	14	1/8"
17070B	45	10	27	49	14	1/8"

Weight gr.
60
80

Service unit assembled (EM+L) (E+L) (EW+L)

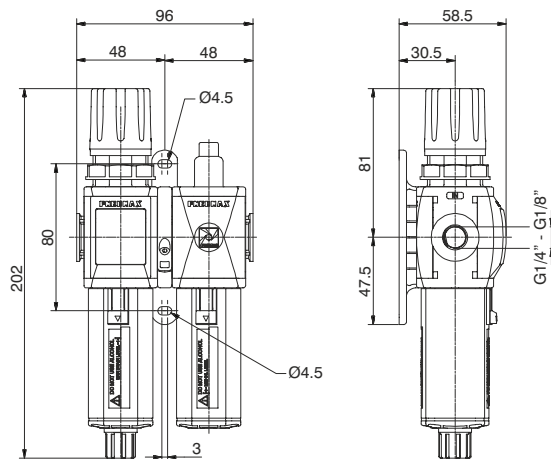

Example : GT171BHG : size 1, combined group comprising Filter-regulator and Lubricator, Technopolymer threads, G1/4" connections, 0 to 8 bar adjusting range and 20 µm filter pore size

Flow rate curves

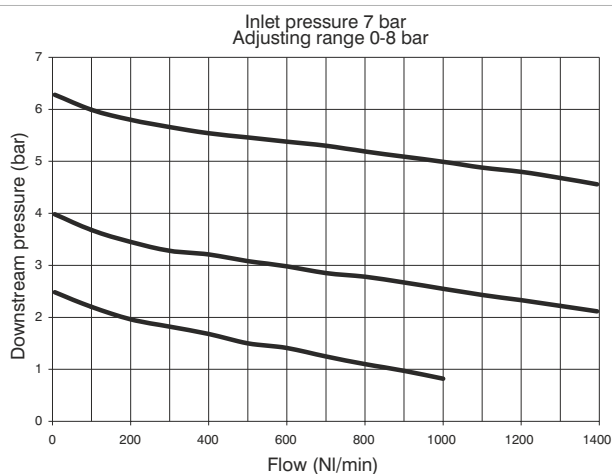

Adjustment characteristics

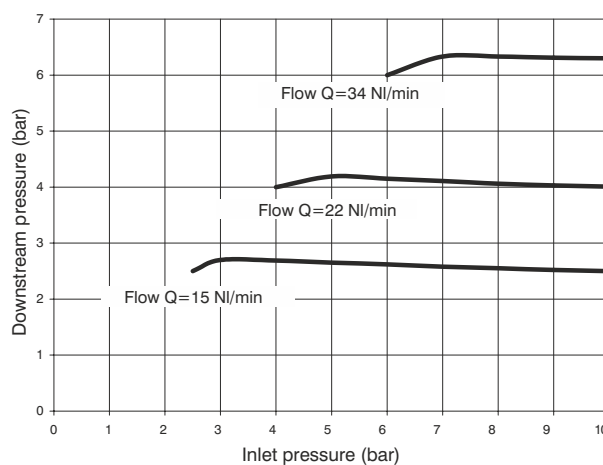

Operational characteristics

Combined group comprising Filter-regulator with built in manometer and Lubricator assembled with a (Y) type coupling kit for panel mounting.
 Integrated manometer 0-12 bar as standard
 (for 0-8 and 0-12 bar range) and 0-4 bar (for 0-2 and 0-4 range)

Note

The pressure must be always regulating while increasing. For a more precise regulation and higher sensibility, the use of a regulator with a pressure range as close as possible to the regulated pressure is recommended.

Technical characteristics

Connections	G 1/8" - G 1/4"
Max. inlet pressure	13 bar
Working temperature	-5°C +50°C
Weight with Technopolymer threads	gr. 328
Weight with threaded inserts	gr. 348
Pressure range	0-2 bar / 0-4 bar 0-8 bar / 0-12 bar
Filter pore size	5 µm - 20 µm - 50 µm
Bowl capacity	18 cm ³
Indicative oil drop rate	1 drop every 300/600 NI
Oil type	FD22 - HG32
Bowl capacity	36 cm ³
Assembly positions	Vertical
Max. fitting torque (with Technopolymer threads)	G1/4" = 9 Nm
Max. fitting torque (with threaded inserts)	G1/8" = 15 Nm G1/4" = 20 Nm
Min. operational flow at 6,3 bar	40 NI/min.

Ordering code

GV171CTSD02

VERSION	
N = Metal inserts	
T = Technopolymer thread	
CONNECTIONS	
A = G1/8" (only for "N" version)	
B = G1/4"	
C = 1/4 NPT (only for "N" version)	
TYPE	
H = Built in gauge	
J = G1/8" gauge connection	
FILTER PORE SIZE	
ADJUSTING RANGE	
C = 5 µm / 0-8 bar	
D = 5 µm / 0-12 bar	
G = 20 µm / 0-8 bar	
H = 20 µm / 0-12 bar	
N = 50 µm / 0-8 bar	
P = 50 µm / 0-12 bar	
OPTIONS	
= Standard *	
S = Automatic drain	
FLOW DIRECTION	
= Standard *	
(from left to right)	
W = from right to left	
BOWL OPTIONS	
= Standard *	
N = Nylon bowl	

* no additional letter required

Service unit assembled (F+RM+L) (F+R+L) (F+RW+L)

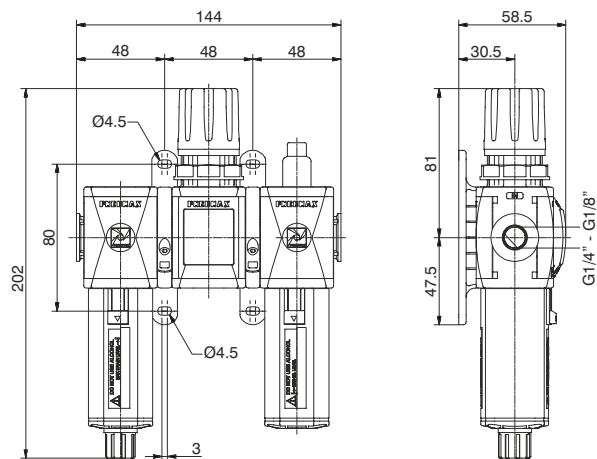

Example : GT171BKG : size 1 combined group comprising Filter, Regulator and Lubricator Technopolymer threads, G1/4" connections, 0 to 8 bar adjusting range and 20 µm filter pore size

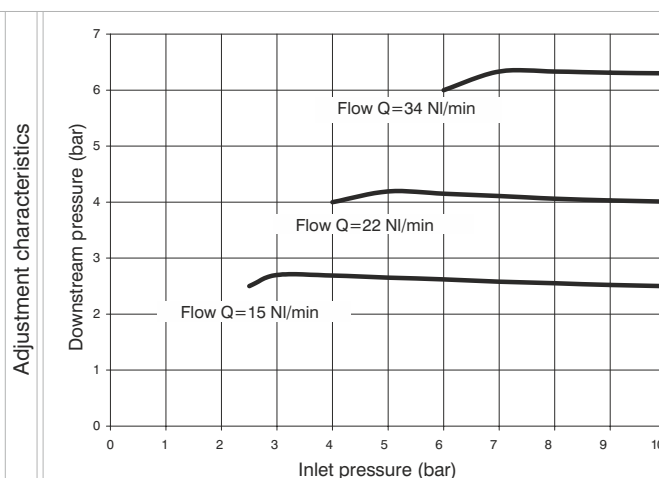
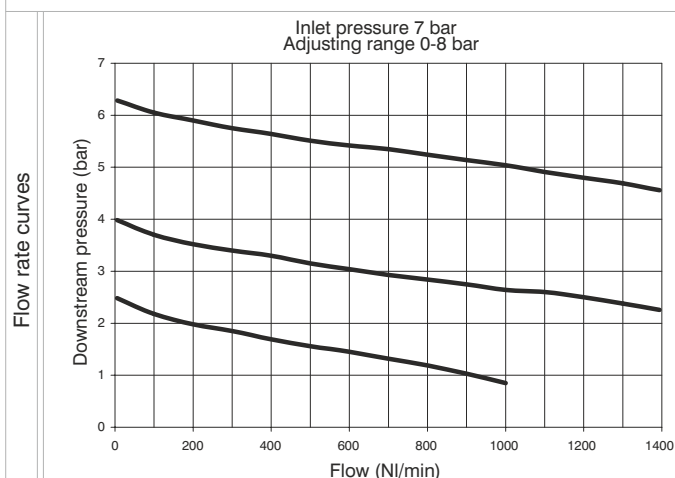

Operational characteristics

Combined group comprising Filter, Regulator with built in manometer and Lubricator assembled with two (Y) type coupling kits for panel mounting.
Integrated manometer 0-12 bar as standard
(for 0-8 and 0-12 bar range) and 0-4 bar (for 0-2 and 0-4 range)

Note

The pressure must be always regulating while increasing. For a more precise regulation and higher sensibility, the use of a regulator with a pressure range as close as possible to the regulated pressure is recommended.

Technical characteristics

Connections	G 1/8" - G 1/4"
Max. inlet pressure	13 bar
Working temperature	-5°C +50°C
Weight with Technopolymer threads	gr. 406
Weight with threaded inserts	gr. 436
Pressure range	0-2 bar / 0-4 bar 0-8 bar / 0-12 bar
Filter pore size	5 µm - 20 µm - 50 µm
Bowl capacity	18 cm ³
Indicative oil drop rate	1 drop every 300/600 NI
Oil type	FD22 - HG32
Bowl capacity	36 cm ³
Assembly positions	Vertical
Max. fitting torque (with Technopolymer threads)	G1/4" = 9 Nm
Max. fitting torque (with threaded inserts)	G1/8" = 15 Nm G1/4" = 20 Nm
Min. operational flow at 6,3 bar	40 NI/min.

Ordering code

GV171CTSD02

VERSION	
V N = Metal inserts	
T = Technopolymer thread	
CONNECTIONS	
A = G1/8" (only for "N" version)	
B = G1/4"	
C = 1/4 NPT (only for "N" version)	
TYPE	
T K = Built in gauge	
T = G1/8" gauge connection	
FILTER PORE SIZE	
ADJUSTING RANGE	
C = 5 µm / 0-8 bar	
D = 5 µm / 0-12 bar	
G = 20 µm / 0-8 bar	
H = 20 µm / 0-12 bar	
N = 50 µm / 0-8 bar	
P = 50 µm / 0-12 bar	
OPTIONS	
= Standard *	
S = Automatic drain	
FLOW DIRECTION	
= Standard	
D (from left to right)	
W = from right to left	
BOWL OPTIONS	
= Standard *	
N = Nylon bowl	

* no additional letter required

Service unit assembled (EM+PA+L) (E+PA+L) (EW+PA+L)

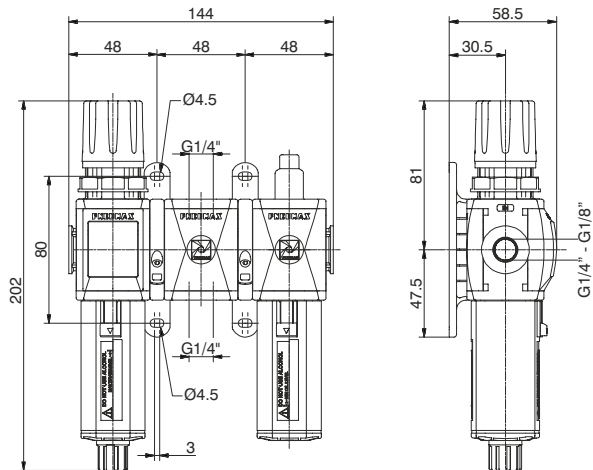

Example : GT171BNG : size 1 combined group comprising Filter-regulator, Air intake and Lubricator Technopolymer threads, G1/4" connections, 0 to 8 bar adjusting range and 20 µm filter pore size

Flow rate curves

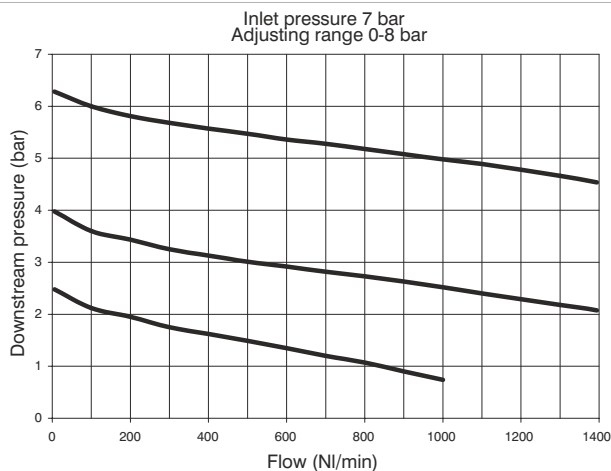

Adjustment characteristics

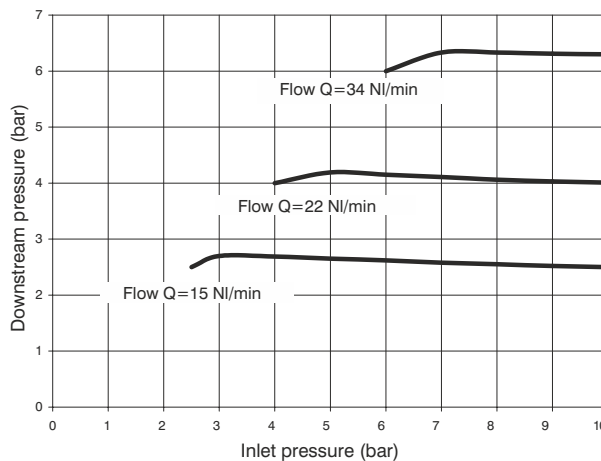

Operational characteristics

Combined group comprising Filter-regulator with built in manometer, Air intake and Lubricator assembled with two (Y) type coupling kits for panel mounting. Integrated manometer 0-12 bar as standard (for 0-8 and 0-12 bar range) and 0-4 bar (for 0-2 and 0-4 range)

Note

The pressure must be always regulating while increasing. For a more precise regulation and higher sensibility, the use of a regulator with a pressure range as close as possible to the regulated pressure is recommended.

Technical characteristics

Connections	G 1/8" - G 1/4"
Max. inlet pressure	13 bar
Working temperature	-5°C + 50°C
Weight with Technopolymer threads	gr. 398
Weight with threaded inserts	gr. 418
Pressure range	0-2 bar / 0-4 bar 0-8 bar / 0-12 bar
Filter pore size	5 µm - 20 µm - 50 µm
Bowl capacity	18 cm ³
Indicative oil drop rate	1 drop every 300/600 NI
Oil type	FD22 - HG32
Bowl capacity	36 cm ³
Assembly positions	Vertical
Max. fitting torque (with Technopolymer threads)	G1/4" = 9 Nm
Max. fitting torque (with threaded inserts)	G1/8" = 15 Nm G1/4" = 20 Nm
Min. operational flow at 6,3 bar	40 NI/min.

Ordering code

GV171CTSD02

VERSION	
N = Metal inserts	
T = Technopolymer thread	
CONNECTIONS	
A = G1/8" (only for "N" version)	
B = G1/4"	
C = 1/4 NPT (only for "N" version)	
TYPE	
N = Built in gauge	
P = G1/8" gauge connection	
FILTER PORE SIZE	
ADJUSTING RANGE	
C = 5 µm / 0-8 bar	
D = 5 µm / 0-12 bar	
G = 20 µm / 0-8 bar	
H = 20 µm / 0-12 bar	
N = 50 µm / 0-8 bar	
P = 50 µm / 0-12 bar	
OPTIONS	
= Standard *	
S = Automatic drain	
FLOW DIRECTION	
= Standard	
D (from left to right)	
W = from right to left	
BOWL OPTIONS	
= Standard *	
N = Nylon bowl	

* no additional letter required

Service unit assembled (EM+PP+L) (E+PP+L) (EW+PP+L)

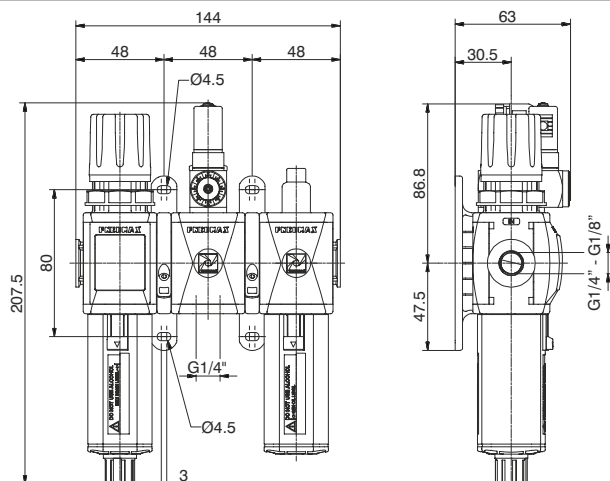

Example : GT171BRG : size 1 combined group comprising Filter-Regulator, Pressure switch and Lubricator Technopolymer threads, G1/4" connections 0 to 8 bar adjusting range and 20 µm filter pore size

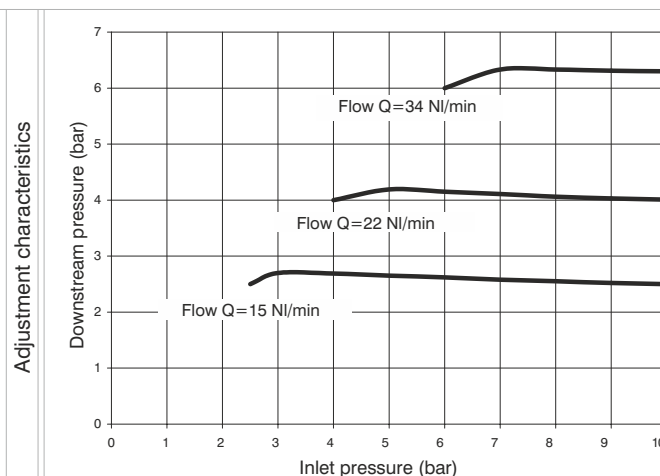
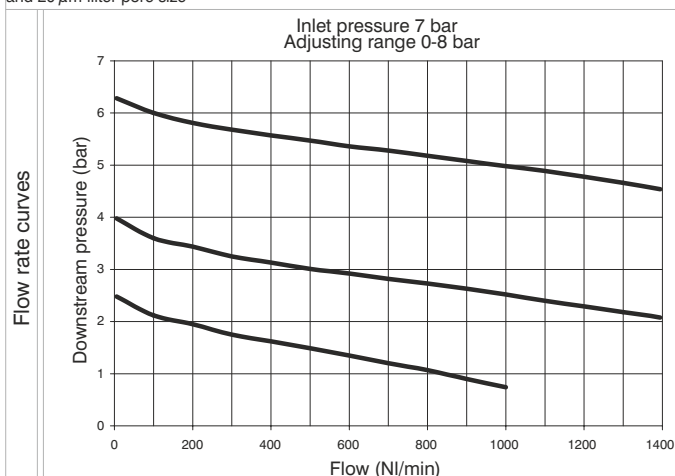

Operational characteristics

Combined group comprising Filter-regulator with built in manometer, Pressure switch and Lubricator assembled with two (Y) type coupling kits for panel mountings. Integrated manometer 0-12 bar as standard (for 0-8 and 0-12 bar range) and 0-4 bar (for 0-2 and 0-4 range)

Note

The pressure must be always regulating while increasing. For a more precise regulation and higher sensibility, the use of a regulator with a pressure range as close as possible to the regulated pressure is recommended.

Technical characteristics

Connections	G 1/8" - G 1/4"
Max. inlet pressure	13 bar
Working temperature	-5°C +50°C
Weight with Technopolymer threads	gr. 484
Weight with threaded inserts	gr. 504
Pressure range	0-2 bar / 0-4 bar 0-8 bar / 0-12 bar
Filter pore size	5 µm - 20 µm - 50 µm
Bowl capacity	18 cm ³
Indicative oil drop rate	1 drop every 300/600 NI
Oil type	FD22 - HG32
Bowl capacity	36 cm ³
Assembly positions	Vertical
Max. fitting torque (with Technopolymer threads)	G1/4" = 9 Nm
Max. fitting torque (with threaded inserts)	G1/8" = 15 Nm G1/4" = 20 Nm
Min. operational flow at 6,3 bar	40 NI/min.

Ordering code

GV171CTSD02

VERSION	
V N = Metal inserts	
T = Technopolymer thread	
CONNECTIONS	
A = G1/8" (only for "N" version)	
B = G1/4"	
C = 1/4 NPT (only for "N" version)	
TYPE	
T R = Built in gauge	
C = G1/8" gauge connection	
FILTER PORE SIZE	
ADJUSTING RANGE	
C = 5 µm / 0-8 bar	
D = 5 µm / 0-12 bar	
G = 20 µm / 0-8 bar	
H = 20 µm / 0-12 bar	
N = 50 µm / 0-8 bar	
P = 50 µm / 0-12 bar	
OPTIONS	
= Standard *	
S = Automatic drain	
FLOW DIRECTION	
= Standard	
D (from left to right)	
W = from right to left	
BOWL OPTIONS	
= Standard *	
N = Nylon bowl	

* no additional
letter required

Service unit assembled (VL+EM) (VL+E) (VL+EW)

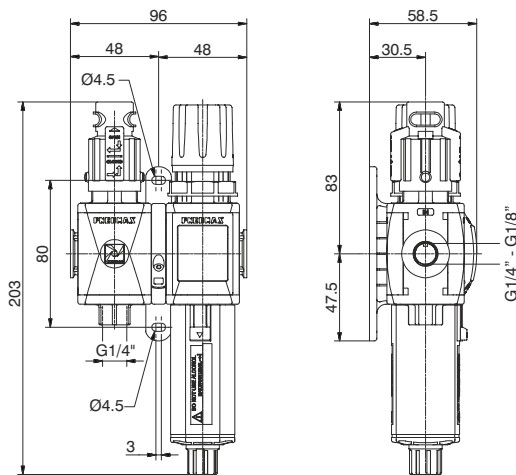

Example : GT171BVGG : size 1 combined group comprising Shut-off valve, Filter-regulator Technopolymer threads, G1/4" connections 0 to 8 bar adjusting range and 20 µm filter pore size

Flow rate curves

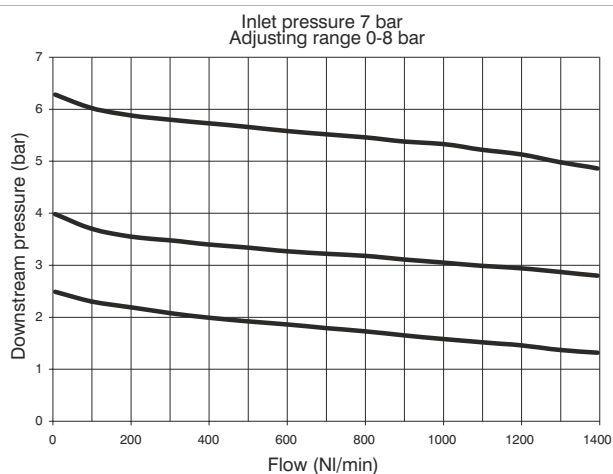

Adjustment characteristics

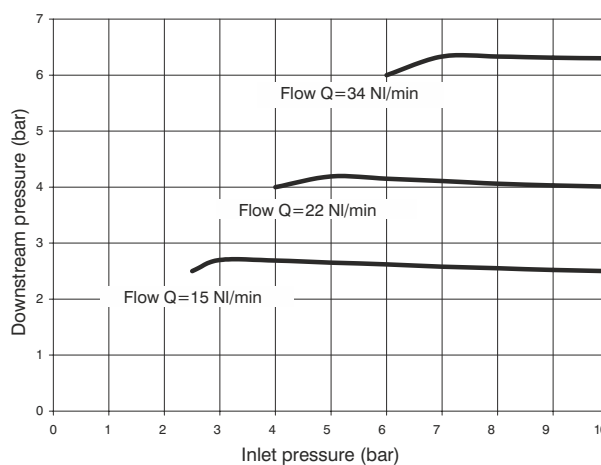

Operational characteristics

Combined group comprising manual shut-off valve, Filter - regulator with built in manometer, assembled with one (Y) type coupling kit for panel mountings.

Integrated manometer 0-12 bar as standard (for 0-8 and 0-12 bar range) and 0-4 bar (for 0-2 and 0-4 range)

Note

The pressure must be always regulating while increasing. For a more precise regulation and higher sensibility, the use of a regulator with a pressure range as close as possible to the regulated pressure is recommended.

Technical characteristics

Connections	G 1/8" - G 1/4"	Ordering code GV171CTSDZ
Max. inlet pressure	13 bar	
Working temperature	-5°C +50°C	VERSION
Weight with Technopolymer threads	gr. 318	V N = Metal inserts
Weight with threaded inserts	gr. 338	T = Technopolymer thread
Pressure range	0-2 bar / 0-4 bar 0-8 bar / 0-12 bar	CONNECTIONS
Filter pore size	5 µm - 20 µm - 50 µm	A = G1/8" (only for "N" version)
Bowl capacity	18 cm ³	B = G1/4"
Indicative oil drop rate	1 drop every 300/600 NI	C = 1/4 NPT (only for "N" version)
Oil type	FD22 - HG32	TYPE
Bowl capacity	36 cm ³	T VG = Built in gauge
Assembly positions	Vertical	VU = G1/8" gauge connection
Max. fitting torque (with Technopolymer threads)	G1/4" = 9 Nm	FILTER PORE SIZE
Max. fitting torque (with threaded inserts)	G1/8" = 15 Nm G1/4" = 20 Nm	ADJUSTING RANGE
Min. operational flow at 6,3 bar	40 NI/min.	C = 5 µm / 0-8 bar
		D = 5 µm / 0-12 bar
		G = 20 µm / 0-8 bar
		H = 20 µm / 0-12 bar
		N = 50 µm / 0-8 bar
		P = 50 µm / 0-12 bar
		OPTIONS
		○ = Standard *
		S = Automatic drain
		FLOW DIRECTION
		D = Standard
		(from left to right)
		W = from right to left
		BOWL OPTIONS
		Z = Standard *
		N = Nylon bowl

* no additional letter required

Service unit assembled (VL+EM+L) (VL+E+L) (VL+EW+L)

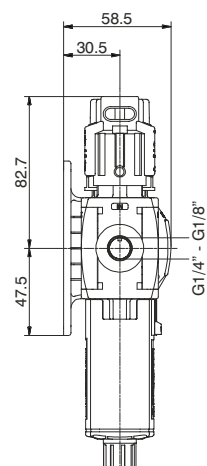
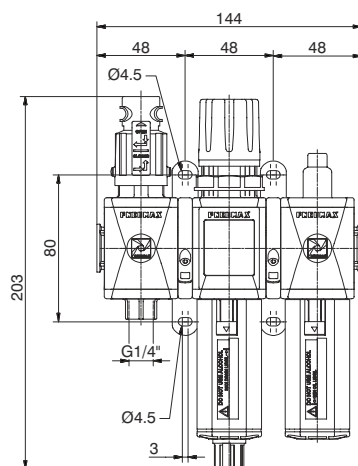

Example : GT171BVHG : size 1 combined group comprising Shut-off valve, Filter-regulator and Lubricator Technopolymer threads, G1/4" connections 0 to 8 bar adjusting range and 20 µm filter pore size

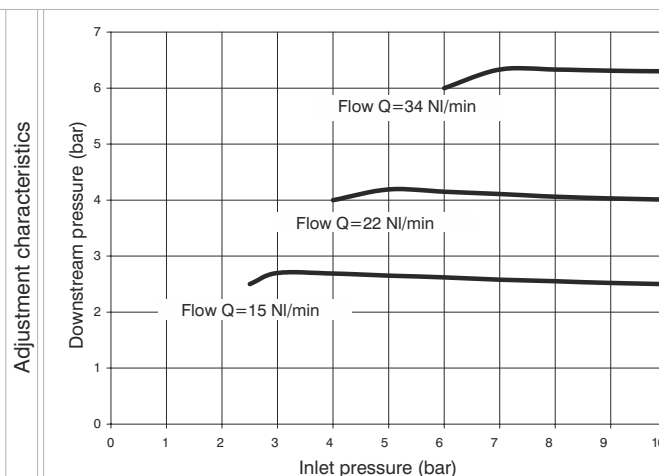
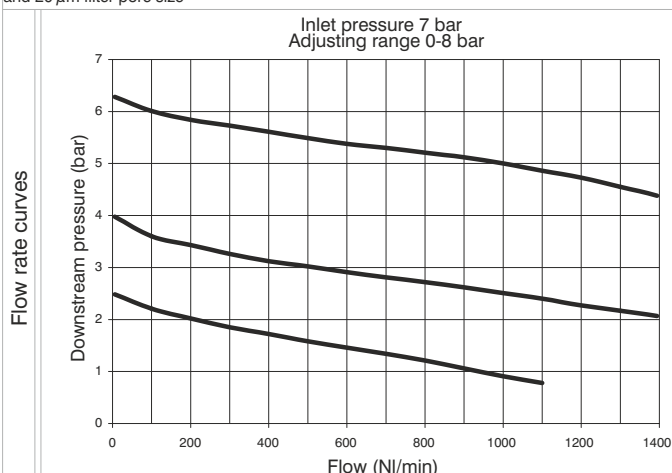

Operational characteristics

Combined group comprising manual shut-off valve, Filter - regulator with built in manometer and Lubricator assembled with two(Y) type coupling kits for panel mountings.
Integrated manometer 0-12 bar as standard
(for 0-8 and 0-12 bar range) and 0-4 bar (for 0-2 and 0-4 range)

Note

The pressure must be always regulating while increasing. For a more precise regulation and higher sensibility, the use of a regulator with a pressure range as close as possible to the regulated pressure is recommended.

Technical characteristics

Connections	G 1/8" - G 1/4"
Max. inlet pressure	13 bar
Working temperature	-5°C +50°C
Weight with Technopolymer threads	gr. 446
Weight with threaded inserts	gr. 476
Pressure range	0-2 bar / 0-4 bar 0-8 bar / 0-12 bar
Filter pore size	5 µm - 20 µm - 50 µm
Bowl capacity	18 cm ³
Indicative oil drop rate	1 drop every 300/600 NI
Oil type	FD22 - HG32
Bowl capacity	36 cm ³
Assembly positions	Vertical
Max. fitting torque (with Technopolymer threads)	G1/4" = 9 Nm
Max. fitting torque (with threaded inserts)	G1/8" = 15 Nm G1/4" = 20 Nm
Min. operational flow at 6,3 bar	40 NI/min.

Ordering code

GV1710TSD02

VERSION	
V N = Metal inserts	
T = Technopolymer thread	
CONNECTIONS	
A = G1/8" (only for "N" version)	
B = G1/4"	
C = 1/4 NPT (only for "N" version)	
TYPE	
1 VH = Built in gauge	
VJ = G1/8" gauge connection	
FILTER PORE SIZE	
ADJUSTING RANGE	
C = 5 µm / 0-8 bar	
D = 5 µm / 0-12 bar	
G = 20 µm / 0-8 bar	
H = 20 µm / 0-12 bar	
N = 50 µm / 0-8 bar	
P = 50 µm / 0-12 bar	
OPTIONS	
= Standard *	
S = Automatic drain	
FLOW DIRECTION	
= Standard	
D (from left to right)	
W = from right to left	
BOWL OPTIONS	
= Standard *	
N = Nylon bowl	

* no additional
letter required

Service unit assembled (VL+F+RM+L) (VL+F+R+L) (VL+F+RW+L)

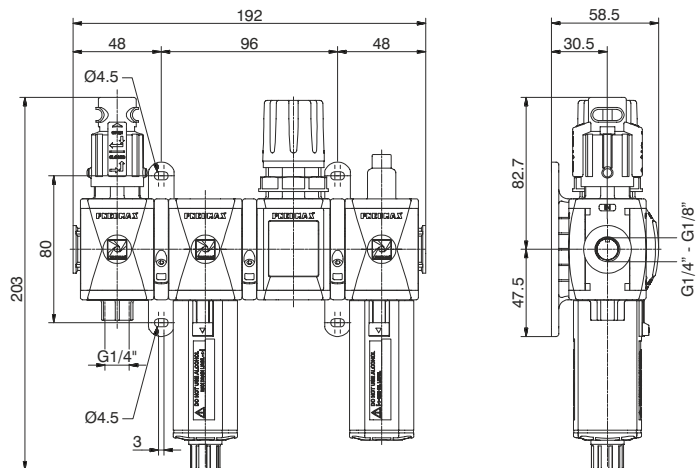

Example : GT171BVKG : size 1 combined group comprising Shut-off valve, Filter, Regulator and Lubricator Technopolymer threads, G1/4" connections 0 to 8 bar adjusting range and 20 µm filter pore size

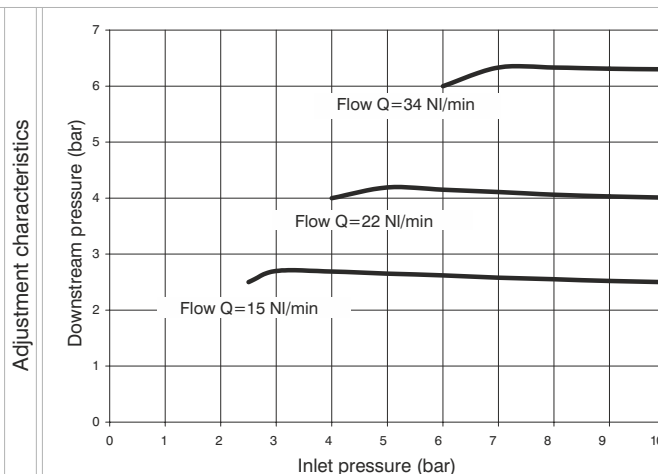
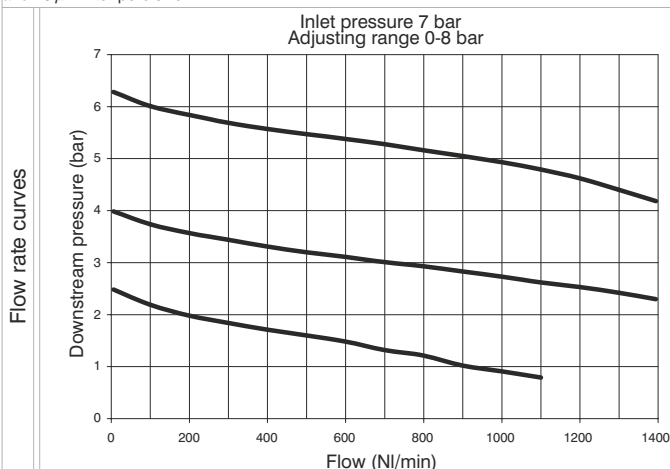

Operational characteristics

Combined group comprising manual shut - off valve, Filter, Regulator with built in manometer and Lubricator , assembled with two (Y) type coupling kits for panel mounting and one (X) type coupling kit.

Integrated manometer 0-12 bar as standard (for 0-8 and 0-12 bar range) and 0-4 bar (for 0-2 and 0-4 range)

Note

The pressure must be always regulating while increasing. For a more precise regulation and higher sensibility, the use of a regulator with a pressure range as close as possible to the regulated pressure is recommended.

Technical characteristics

Connections	G 1/8" - G 1/4"
Max. inlet pressure	13 bar
Working temperature	-5°C +50°C
Weight with Technopolymer threads	gr. 518
Weight with threaded inserts	gr. 558
Pressure range	0-2 bar / 0-4 bar 0-8 bar / 0-12 bar
Filter pore size	5 µm - 20 µm - 50 µm
Bowl capacity	18 cm ³
Indicative oil drop rate	1 drop every 300/600 NI
Oil type	FD22 - HG32
Bowl capacity	36 cm ³
Assembly positions	Vertical
Max. fitting torque (with Technopolymer threads)	G1/4" = 9 Nm
Max. fitting torque (with threaded inserts)	G1/8" = 15 Nm G1/4" = 20 Nm
Min. operational flow at 6,3 bar	40 NI/min.

Ordering code

GV171CTSD02

VERSION	
N = Metal inserts	
T = Technopolymer thread	
CONNECTIONS	
A = G1/8" (only for "N" version)	
B = G1/4"	
C = 1/4 NPT (only for "N" version)	
TYPE	
VT = Built in gauge	
VT = G1/8" gauge connection	
FILTER PORE SIZE	
ADJUSTING RANGE	
C = 5 µm / 0-8 bar	
D = 5 µm / 0-12 bar	
G = 20 µm / 0-8 bar	
H = 20 µm / 0-12 bar	
N = 50 µm / 0-8 bar	
P = 50 µm / 0-12 bar	
OPTIONS	
= Standard *	
S = Automatic drain	
FLOW DIRECTION	
= Standard	
(from left to right)	
W = from right to left	
BOWL OPTIONS	
= Standard *	
N = Nylon bowl	

* no additional letter required

Service unit assembled (VL+EM+PA+L) (VL+E+PA+L) (VL+EW+PA+L)

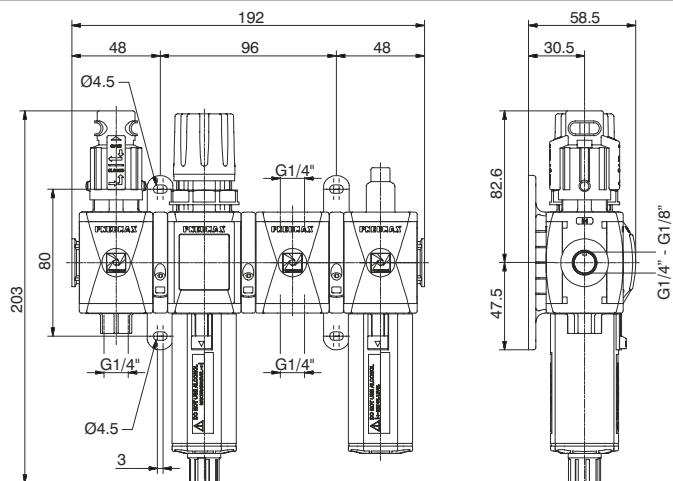
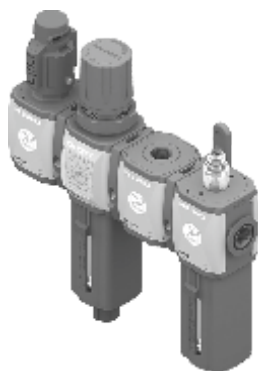

Example : GT171BVNG : size 1 combined group comprising Shut-off valve, Filter-regulator, Air intake and Lubricator Technopolymer threads, G1/4" connections 0 to 8 bar adjusting range and 20 µm filter pore size

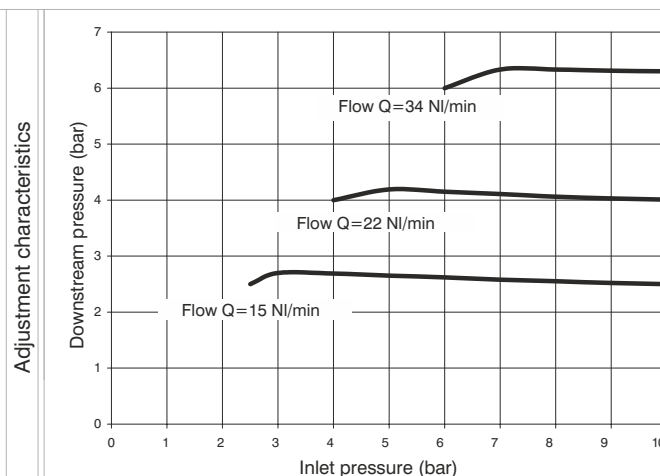
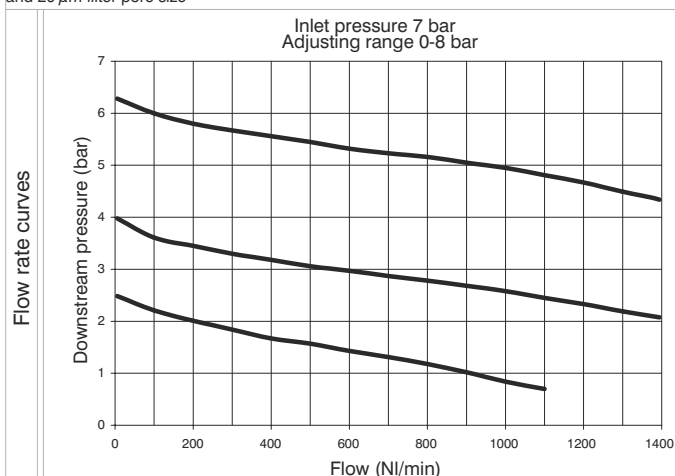

Operational characteristics

Combined group comprising manual shut-off valve, Filter - regulator with built in manometer, Air intake and Lubricator, assembled with two (Y) type coupling kits for panel mounting and one (X) type coupling kit.

Integrated manometer 0-12 bar as standard (for 0-8 and 0-12 bar range) and 0-4 bar (for 0-2 and 0-4 range)

Note

The pressure must be always regulating while increasing. For a more precise regulation and higher sensibility, the use of a regulator with a pressure range as close as possible to the regulated pressure is recommended.

Technical characteristics

Connections	G 1/8" - G 1/4"
Max. inlet pressure	13 bar
Working temperature	-5°C +50°C
Weight with Technopolymer threads	gr. 510
Weight with threaded inserts	gr. 540
Pressure range	0-2 bar / 0-4 bar 0-8 bar / 0-12 bar
Filter pore size	5 µm - 20 µm - 50 µm
Bowl capacity	18 cm³
Indicative oil drop rate	1 drop every 300/600 NI
Oil type	FD22 - HG32
Bowl capacity	36 cm³
Assembly positions	Vertical
Max. fitting torque (with Technopolymer threads)	G1/4" = 9 Nm
Max. fitting torque (with threaded inserts)	G1/8" = 15 Nm G1/4" = 20 Nm
Min. operational flow at 6,3 bar	40 NI/min.

Ordering code

GV171CTSD02

VERSION	
V N = Metal inserts	
T = Technopolymer thread	
CONNECTIONS	
A = G1/8" (only for "N" version)	
B = G1/4"	
C = 1/4 NPT (only for "N" version)	
TYPE	
1 VN = Built in gauge	
VP = G1/8" gauge connection	
FILTER PORE SIZE	
ADJUSTING RANGE	
C = 5 µm / 0-8 bar	
D = 5 µm / 0-12 bar	
G = 20 µm / 0-8 bar	
H = 20 µm / 0-12 bar	
N = 50 µm / 0-8 bar	
P = 50 µm / 0-12 bar	
OPTIONS	
= Standard *	
S = Automatic drain	
FLOW DIRECTION	
= Standard	
D (from left to right)	
W = from right to left	
BOWL OPTIONS	
= Standard *	
N = Nylon bowl	

* no additional
letter required

Service unit assembled (VL+EM+PP+L) (VL+E+PP+L) (VL+EW+PP+L)

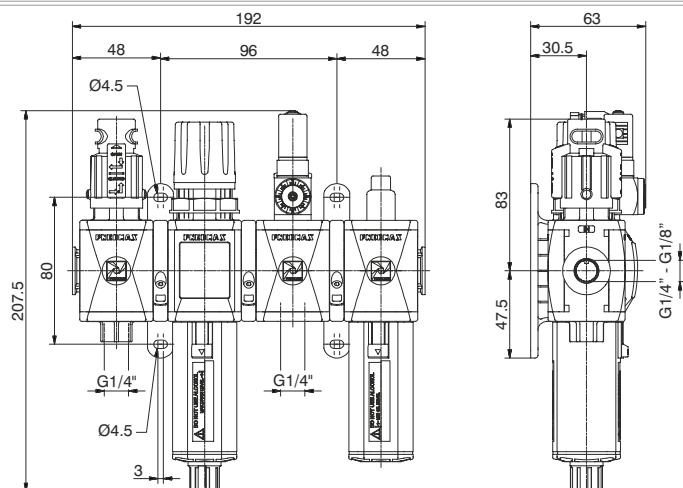
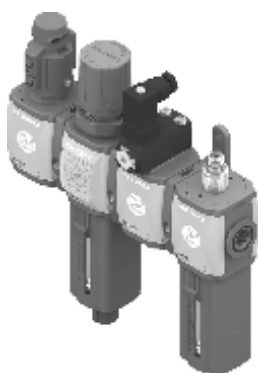

Example : GT171BVRG : size 1 combined group comprising Shut-off valve, Filter-regulator, Pressure switch and Lubricator Technopolymer threads, G1/4" connections adjusting range 0 to 8 bar and 20 µm filter pore size

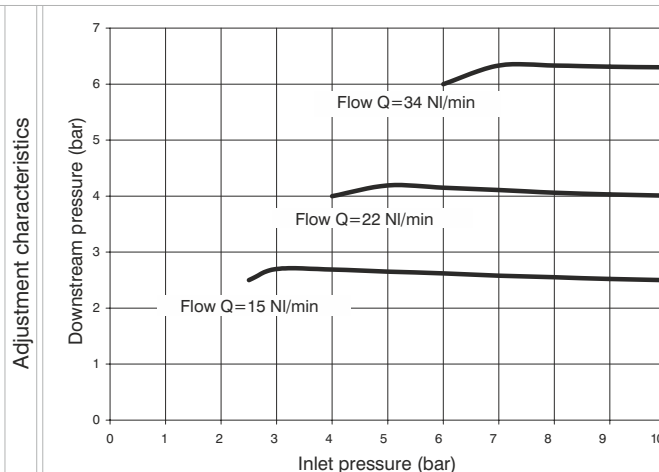
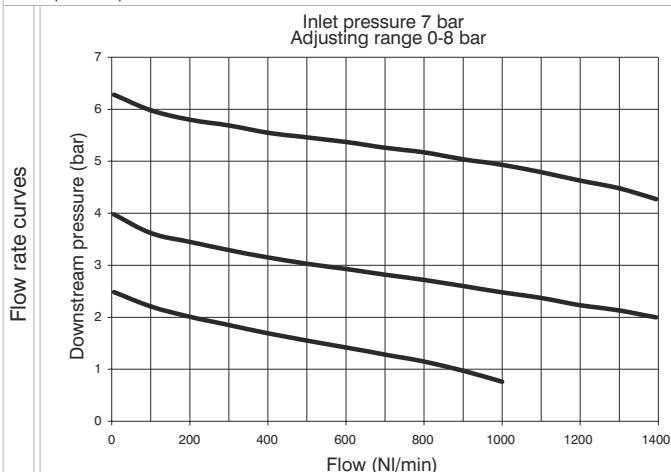

Operational characteristics

Combined group comprising manual shut-off valve, Filter - regulator with built in manometer, Pressure switch and Lubricator, assembled with two (Y) type coupling kits for panel mounting and one (X) type coupling kit.
Integrated manometer 0-12 bar as standard
(for 0-8 and 0-12 bar range) and 0-4 bar (for 0-2 and 0-4 range)

Note

The pressure must be always regulating while increasing. For a more precise regulation and higher sensibility, the use of a regulator with a pressure range as close as possible to the regulated pressure is recommended.

Technical characteristics

Connections	G 1/8" - G 1/4"
Max. inlet pressure	13 bar
Working temperature	-5°C +50°C
Weight with Technopolymer threads	gr. 596
Weight with threaded inserts	gr. 626
Pressure range	0-2 bar / 0-4 bar 0-8 bar / 0-12 bar
Filter pore size	5 µm - 20 µm - 50 µm
Bowl capacity	18 cm ³
Indicative oil drop rate	1 drop every 300/600 NI
Oil type	FD22 - HG32
Bowl capacity	36 cm ³
Assembly positions	Vertical
Max. fitting torque (with Technopolymer threads)	G1/4" = 9 Nm
Max. fitting torque (with threaded inserts)	G1/8" = 15 Nm G1/4" = 20 Nm
Min. operational flow at 6,3 bar	40 NI/min.

Ordering code

GV171CTSD02

VERSION	
V N = Metal inserts	
T = Technopolymer thread	
CONNECTIONS	
C A = G1/8" (only for "N" version)	
B = G1/4"	
C = 1/4 NPT (only for "N" version)	
TYPE	
T VR = Built in gauge	
VC = G1/8" gauge connection	
FILTER PORE SIZE	
ADJUSTING RANGE	
S C = 5 µm / 0-8 bar	
D = 5 µm / 0-12 bar	
G = 20 µm / 0-8 bar	
H = 20 µm / 0-12 bar	
N = 50 µm / 0-8 bar	
P = 50 µm / 0-12 bar	
OPTIONS	
O = Standard *	
S = Automatic drain	
FLOW DIRECTION	
D = Standard	
(from left to right)	
W = from right to left	
BOWL OPTIONS	
Z = Standard *	
N = Nylon bowl	

* no additional letter required



Service unit assembled (VE+AP)

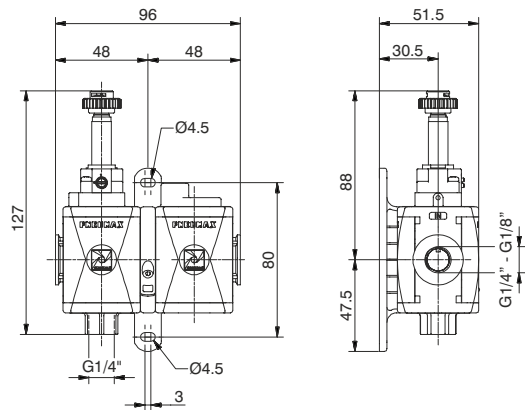

Example : GT171BSB2 : size 1 combined group comprising Electric shut-off valve, Progressive start-up valve without coil with M2 pilot Technopolymer threads, G1/4" connections

Operational characteristics	Technical characteristics		
Combined group comprising Electric shut-off valve and Progressive start-up valve assembled with a (Y) type coupling kit for panel mounting.	Connections	G 1/8" - G 1/4"	Ordering code
	Max. inlet pressure	10 bar	GV171CSA VERSION N = Metal inserts T = Technopolymer thread CONNECTIONS A = G1/8" (only for "N" version) B = G1/4" C = 1/4 NPT (only for "N" version) 15 mm COIL VOLTAGE A4 = 12 V DC A5 = 24 V DC A6 = 24 V AC (50-60 Hz) A7 = 110 V AC (50-60 Hz) A8 = 230 V AC (50-60 Hz) A9 = 24 V DC (1 Watt) 22 mm COIL VOLTAGE B2 = Without coil M2 mechanic A B4 = 12 V DC B5 = 24 V DC B6 = 24 V AC (50-60 Hz) B7 = 110 V AC (50-60 Hz) B8 = 230 V AC (50-60 Hz) B9 = 24 V DC (2 Watt) 30 mm COIL VOLTAGE C5 = 24 V DC C6 = 24 V AC (50-60 Hz) C7 = 110 V AC (50-60 Hz) C8 = 230 V AC (50-60 Hz) C9 = 24 V DC (2 Watt)
	Min. inlet pressure	3 bar	
	Working temperature	-5°C +50°C	
	Weight with Technopolymer threads	gr. 218	
	Weight with threaded inserts	gr. 238	
	Assembly positions	Indifferent	
	Max. fitting torque (with Technopolymer threads)	G1/4" = 9 Nm	
	Max. fitting torque (with threaded inserts)	G1/8" = 15 Nm G1/4" = 20 Nm	
	Flow at 6 bar with Δp=1	1200 NI/min.	