

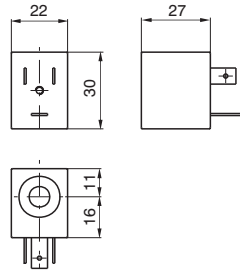

Coil



Weight 54 gr.

* Use only with M2/9

Ordering code	Available voltages Coils
MB 4 MB 5 MB 6	12 D.C. 24 D.C. 48 D.C. Direct current
MB 9*	24 D.C. (2 Watt) (Direct current, low consumption)
MB 17 MB 21 MB 22 MB 24	24/50 48/50 110/50 230/50 Alternating current 50 Hz
MB 37 MB 39 MB 41	24/60 110/60 230/60 Alternating current 60 Hz
MB 56 MB 57 MB 58	24/50-60 110/50-60 230/50-60 Alternating current 50/60 Hz
MB 66 MB 67 MB 68	24/50-60 110/50-60 230/50-60 Alternating current (low consumption) 50/60 Hz

Miniature solenoid valve Normally Closed (N.C.)

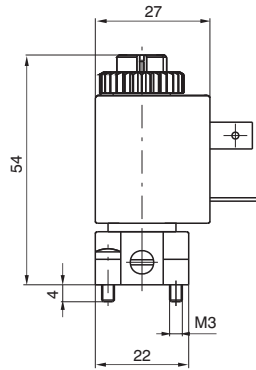
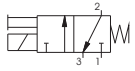

Weight 100 gr.

Ordering code	Available voltages Miniature solenoid valve N.C.
M 2.4 M 2.5 M 2.6 M 2.9	12 D.C. 24 D.C. 48 D.C. 24 D.C. (2 Watt) Direct current
M 2.17 M 2.21 M 2.22 M 2.24	24/50 48/50 110/50 230/50 Alternating current 50 Hz
M 2.37 M 2.39 M 2.41	24/60 110/60 230/60 Alternating current 60 Hz
M 2.56 M 2.57 M 2.58	24/50-60 110/50-60 230/50-60 Alternating current 50/60 Hz
M 2.66 M 2.67 M 2.68	24/50-60 110/50-60 230/50-60 Alternating current (low consumption) 50/60 Hz

Miniature solenoid valve Normally Open (N.O.)

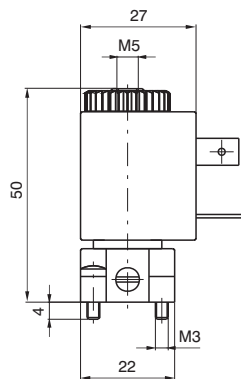
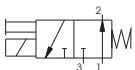

Weight 103 gr.

Ordering code	Available voltages Miniature solenoid valve N.O.
M 2/1.4 M 2/1.5 M 2/1.6 M 2/1.9	12 D.C. 24 D.C. 48 D.C. 24 D.C. (2 Watt) Direct current
M 2/1.17 M 2/1.21 M 2/1.22 M 2/1.24	24/50 48/50 110/50 230/50 Alternating current 50 Hz
M 2/1.37 M 2/1.39 M 2/1.41	24/60 110/60 230/60 Alternating current 60 Hz
M 2/1.56 M 2/1.57 M 2/1.58	24/50-60 110/50-60 230/50-60 Alternating current 50/60 Hz

External feeding base

Use with solenoid valves for piloting pressure different from the using pressure

Ordering code

305.10.05

Weight 18 gr.

