

New

SERIE 300



CARATTERISTICHE TECNICHE

TECHNICAL CHARACTERISTICS
TECHNISCHE ANGABEN
CARACTÉRISTIQUES TECHNIQUES
CARACTERÍSTICAS TÉCNICAS
CARACTERÍSTICAS TÉCNICAS



1907/2006

REACH ✓

2011/65/CE

RoHS ✓

PED
2014/68/UE

SILICON
FREE

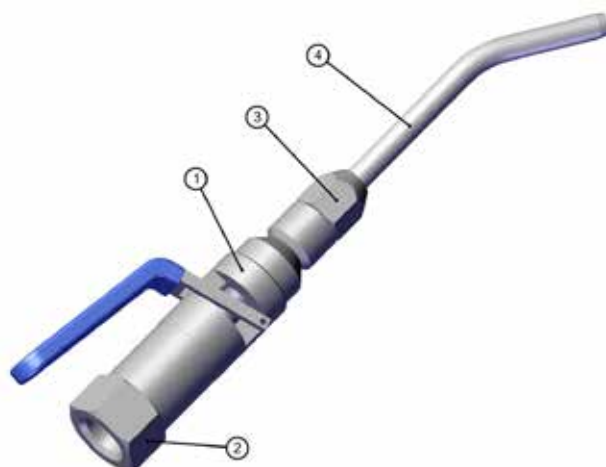

Materiali e Componenti	IT	Component Parts and Materials	GB	Komponenten und Materialien	DE
1 Corpo centrale in Ottone nichelato		1 Nickel-plated Brass Body		1 Körper Messing vernickelt	
2 Attacco terminale in Ottone nichelato		2 Nickel-plated Brass Back Connection		2 Einschraubkörper Messing vernickelt	
3 Dado di serraggio in Ottone nichelato		3 Nickel-plated Brass Locking Nut		3 Sicherungsmutter Messing vernickelt	
4 Ugello di soffiaggio in acciaio Inox AISI 304		4 Stainless Steel AISI 304 Nozzle		4 Blasdüsenrohr Edelstahl AISI 304	
Matériaux et Composants	FR	Materiales y Componentes	ES	Materiais e Componentes	PT
1 Corps: laiton nickelé		1 Cuerpo en latón niquelado		1 Corpo em latão niquelado	
2 Corps: laiton nickelé		2 Conexión terminal en latón niquelado		2 Conexão terminal em latão niquelado	
3 Ecrou: laiton nickelé		3 Tuerca de bloqueo en latón niquelado		3 Porca de travamento em latão niquelado	
4 Embout: acier inoxydable AISI 304		4 Boquilla de soplado en acero AISI 304		4 Boquilla de soplado em acero AISI 304	

301

PISTOLA DI SOFFIAGGIO CON TUBO INOX

BLOWGUN WITH STAINLESS STEEL PIPE
BLASPISTOLE MIT EDELSTAHL ROHR
SOUFFLETTE AVEC EMBOUT ACIER INOXYDABLE
PISTOLA DE SOPLADO CON TUBO ACERO INOXIDABLE
PISTOLA DE AR COM BICO DE AÇO INOXIDÁVEL

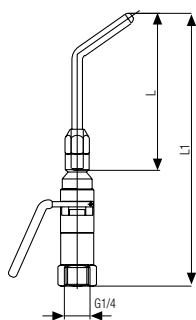

Code	L	L1	Pack.
00301 00 001	90	163	10
00301 00 002	200	273	1
00301 00 003	290	363	1
		min	max
Temperature		- 10 °C	+ 80 °C
Pressure		10 bar (1.0 MPa)	
450 NI/min @ 6 bar - 616 NI/min @ 8 bar			
LAeq 88 dBA @ 6 bar			
LAeq 89 dBA @ 8 bar			
Forza su maniglietta - Force on handle Kraft am Griff - Force sur la poignée Fuerza en el mango - Força no punho		23,5 N @ 6 bar	
Forza di soffiaggio - Blowing force Kraft der Schlag - Force de soufflage Fuerza que sopla - Força de sopra		4,6 N @ 6 bar	
2003/10/CE		Max 85 dBA	3 hr @ 6 bar 3 hr @ 8 bar
OSHA 1910.95 (b)		Max 90 dB 8 hr	

302

PISTOLA DI SOFFIAGGIO SCHERMATA CON TUBO INOX

SCREEN BLOWGUN WITH STAINLESS STEEL PIPE

BLASPISTOLE MIT EDELSTAHL ROHR

SOUFFLETTE AVEC EMBOUT ACIER INOXYDABLE

PISTOLA DE SOPLADO CON TUBO ACERO INOXIDABLE

PISTOLA DE AR COM BICO DE AÇO INOXIDÁVEI

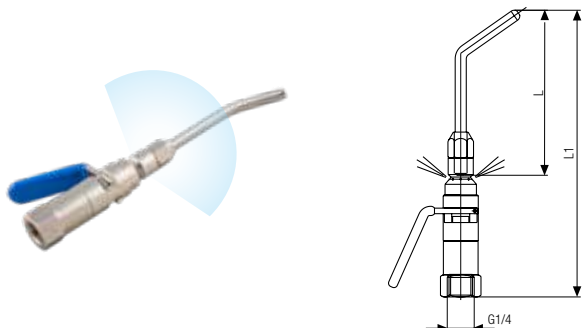

Code	L	L1	Pack.
00302 00 001	90	163	10
00302 00 002	200	273	1
00302 00 003	290	363	1

	min	max
Temperature	- 10 °C	+ 80 °C
Pressure	10 bar (1.0 MPa)	
400 NI/min @ 6 bar - 533 NI/min @ 8 bar		
LAeq 88 dBA @ 6 bar		
LAeq 89 dBA @ 8 bar		
Forza su maniglia - Force on handle <i>Kraft am Griff - Force sur la poignée</i> <i>Fuerza en el mango - Força no punho</i>	23,5 N @ 6 bar	
Forza di soffiaggio - Blowing force <i>Kraft der Schlag - Force de soufflage</i> <i>Fuerza que sopla - Força de sopra</i>	4 N @ 6 bar	
2003/10/CE	Max 85 dBA	3 hr @ 6 bar 3 hr @ 8 bar
OSHA 1910.95 (b)	Max 90 dB 8 hr	

303

PISTOLA DI SOFFIAGGIO CON TUBO INOX DI SICUREZZA

BLOWGUN WITH STAINLESS STEEL SAFETY PIPE

BLASPISTOLE MIT EDELSTAHL-SICHERHEITS ROHR

SOUFFLETTE AVEC EMBOUT DE SÉCURITÉ ACIER INOXYDABLE

PISTOLA DE SOPLADO CON TUBO DE SEGURIDAD ACERO INOXIDABLE

PISTOLA DE AR COM BICO DE SEGURANÇA DE AÇO INOXIDÁVEI

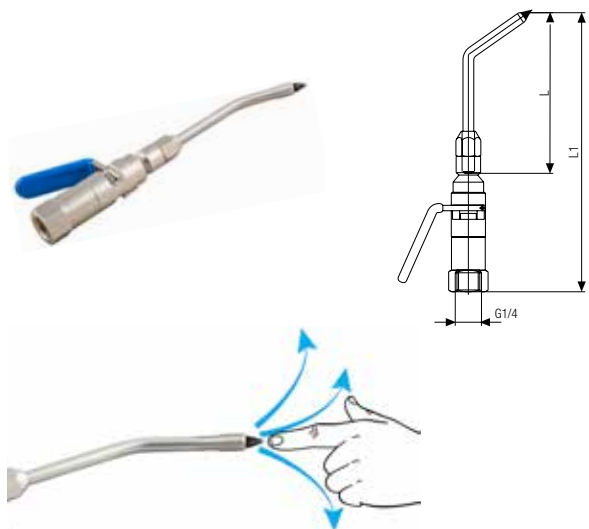

Code	L	L1	Pack.
00303 00 001	90	168,5	1
00303 00 002	200	278	1
00303 00 003	290	368	1

	min	max
Temperature	- 10 °C	+ 80 °C
Pressure	12 bar (1.2 MPa)	
416 NI/min @ 6 bar - 516 NI/min @ 8 bar		
LAeq 80 dBA @ 6 bar		
LAeq 85 dBA @ 8 bar		
Forza su maniglia - Force on handle <i>Kraft am Griff - Force sur la poignée</i> <i>Fuerza en el mango - Força no punho</i>	23,5 N @ 6 bar	
Forza di soffiaggio - Blowing force <i>Kraft der Schlag - Force de soufflage</i> <i>Fuerza que sopla - Força de sopra</i>	3,8 N @ 6 bar	
2003/10/CE	Max 85 dBA	8 hr @ 6 bar 5 hr @ 8 bar
OSHA 1910.95 (b)	Max 90 dB 8 hr	
OSHA 1910.242 (b)	Max 30 PSI (2,1 bar) when blocked	

304

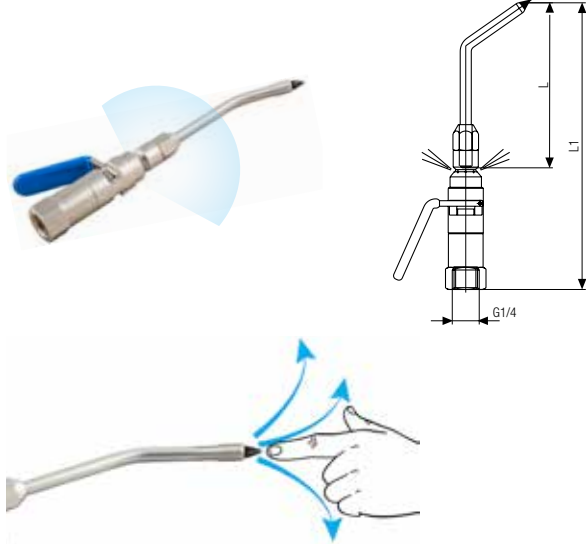
PISTOLA DI SOFFIAGGIO SCHERMATA CON TUBO INOX DI SICUREZZA
BLOWGUN WITH STAINLESS STEEL SAFETY PIPE
BLASPISTOLE MIT EDELSTAHL-SICHERHEITS ROHR
SOUFFLETTE AVEC EMBOUT DE SÉCURITÉ ACIER INOXYDABLE
PISTOLA DE SOPLADO CON TUBO DE SEGURIDAD ACERO INOXIDABLE
PISTOLA DE AR COM BICO DE SEGURANÇA DE AÇO INOXIDÁVEL

Code	L	L1	Pack.
00304 00 001	90	168,5	1
00304 00 002	200	278	1
00304 00 003	290	368	1

	min	max
Temperature	- 10 °C	+ 80 °C
Pressure	10 bar (1.0 MPa)	
316 NI/min @ 6 bar - 416 NI/min @ 8 bar		
LAeq 80 dBA @ 6 bar		
LAeq 85 dBA @ 8 bar		
Forza su maniglietta - Force on handle <i>Kraft am Griff - Force sur la poignée</i> <i>Fuerza en el mango - Força no punho</i>	23,5 N @ 6 bar	
Forza di soffiaggio - Blowing force <i>Kraft der Schlag - Force de soufflage</i> <i>Fuerza que sopla - Força de sopra</i>	3,5 N @ 6 bar	
2003/10/CE	Max 85 dBA	8 hr @ 6 bar 5 hr @ 8 bar
OSHA 1910.95 (b)	Max 90 dB 8 hr	
OSHA 1910.242 (b)	Max 30 PSI (2,1 bar) when blocked	

SERIE 300 - SERIE 360

312

UGELLO EFFETTO VENTURI (RICAMBIO)

VENTURI'S EFFECT NOZZLE (SPARE PART)

VENTURI DÜSE (ERSATZTEIL)

EMBOUT À EFFET VENTURI (RECHANGE)

BOQUILLA EFECTO VENTURI (RECAMBIO)

BICO COM EFEITO VENTURI (REPOSIÇÃO)

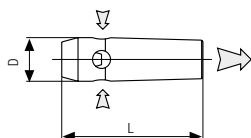

Code	L	D	Pack.
00312 00 001	55	17	1

314

New
UGELLO INOX (RICAMBIO)

STAINLESS STEEL NOZZLE (SPARE PART)

EDELSTAHL DÜSE (ERSATZTEIL)

EMBOUT EN ACIER INOXYDABLE (RECHANGE)

BOQUILLA DE ACERO INOXIDABLE (RECAMBIO)

BICO DE AÇO INOXIDÁVEL (REPOSIÇÃO)



Code	L	Pack.
00314 00 001	90	1
00314 00 002	200	1
00314 00 003	290	1

Ogni ugello è completo di dado e ogiva.

Every nozzle is supplied with nut and olive.

Jede düse ist komplett mit mutter und klemmring.

L'embout est livré avec un écrou et une bague

Cada boquilla está completa de tuerca y bicono.

Todo bico é fornecido completo, com porca e bucha para montagem.

315

New
UGELLO INOX DI SICUREZZA (RICAMBIO)

STAINLESS STEEL SAFETY NOZZLE (SPARE PART)

EDELSTAHL-SICHERHEITS DÜSE (ERSATZTEIL)

EMBOUT DE SÉCURITÉ ACIER INOXYDABLE (RECHANGE)

BOQUILLA DE SEGURIDAD ACERO INOXIDABLE (RECAMBIO)

BICO DE SEGURANÇA DE AÇO INOXIDÁVEL (REPOSIÇÃO)



Code	L	Pack.
00315 00 001	90	1
00315 00 002	200	1
00315 00 003	290	1

Ogni ugello è completo di dado e ogiva.

Every nozzle is supplied with nut and olive.

Jede düse ist komplett mit mutter und klemmring.

L'embout est livré avec un écrou et une bague

Cada boquilla está completa de tuerca y bicono.

Todo bico é fornecido completo, com porca e bucha para montagem.

Serie 310-320

Caratteristiche Tecniche / Technical Characteristics

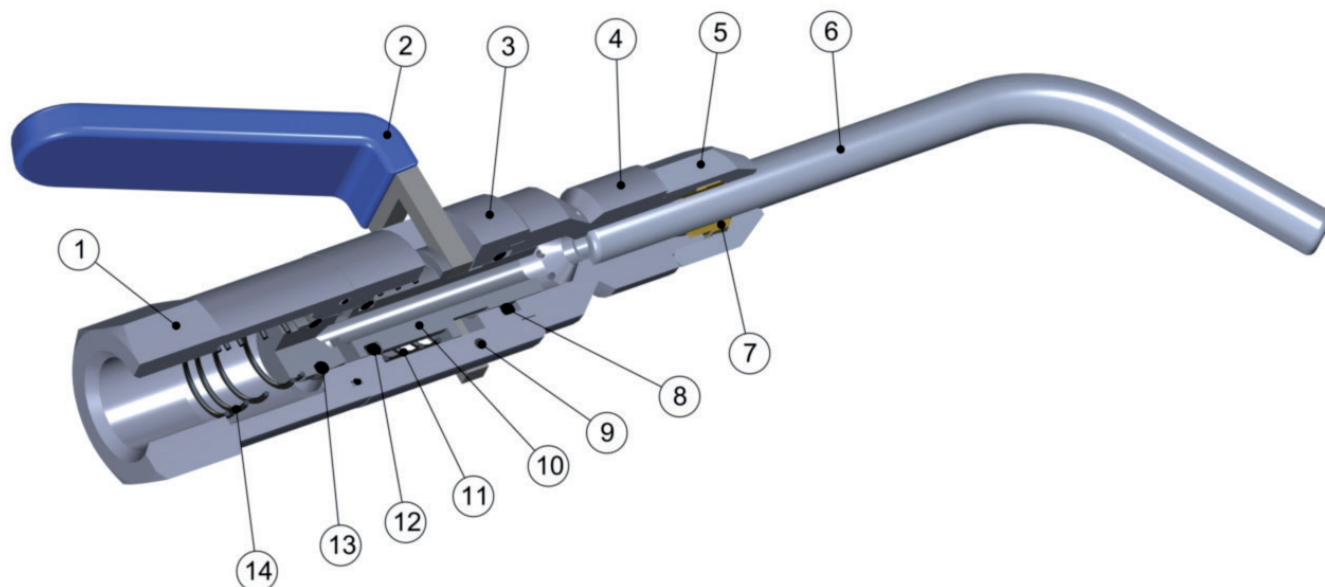

Scheda Materiali / Specifications

1 Attacco terminale in Ottone nichelato	1 Nickel-plated Brass Back Connection
2 Maniglietta in ottone Nichelato Plastificata	2 Nickel-plated Brass Handferro Plastified
3 Corpo centrale in ottone Nichelato	3 Nickel-plated Brass Central Body
4 Corpo anteriore in ottone Nichelato	4 Nickel-plated Brass Front Body
5 Dado di serraggio in ottone Nichelato	5 Nickel-plated Brass Locking nut
6 Ugello di soffiaggio in acciaio A10 Nichelato	6 Nickel-plated inox Nozzle
7 Ogiva aggraffaggio tubo in ottone giallo	7 Yellow Brass Clamping olive
8 Guarnizione O-Ring in NBR 70	8 NBR 70 O-RING Seals
9 Spina in Acciaio	9 Steel Pin
10 Pistoncino in ottone Nichelato	10 Nickel-plated Brass Plunger
11 Molla contrasto Pistoncino in acciaio AISI 302	11 Stell AISI 302 Plunger thrust spring
12 Guarnizione O-Ring in NBR 70	12 NBR 70 O-RING Seals
13 Guarnizione O-Ring in NBR 70	13 NBR 70 O-RING Seals
14 Molla posteriore Pistoncino in acciaio AISI 302	14 Steel AISI 302 Plunger back Spring

Pressioni / Pressures

Pressione massima / Maximum pressure: **10 bar (1 MPa)**

Temperature / Temperatures

Temperatura minima / Minimum temperature: **-20 °C**
 Temperatura massima / Maximum temperature: **+80 °C**

Filettature / Threads

Gas cilindrica conforme ISO 228 Classe A
 Parallel gas in conformity with ISO 228 Class A.

Metrica conforme ISO R/262
 Metric in conformity with ISO R/262.

Fluidi compatibili / Fluids

Aria compressa / Compressed air.

321

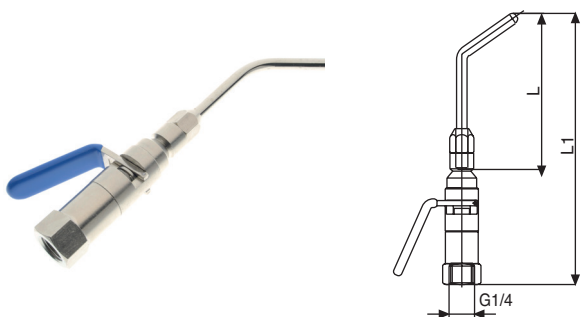
PISTOLA DI SOFFIAGGIO - ATTACCO FEMMINA - BLOW GUN FEMALE CONNECTION

Codice Code	L	L1	Conf. Pack.
0032100001	90	157	10
0032100002	200	267	1
0032100003	290	357	1

322

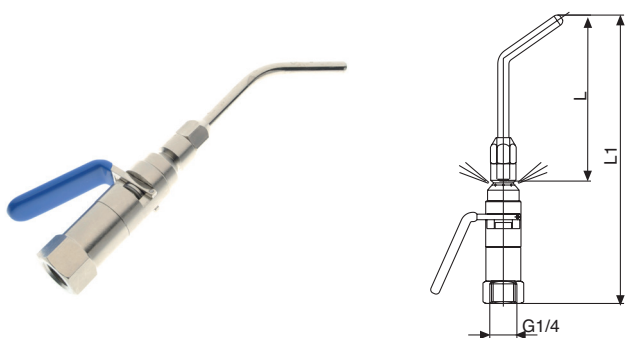
**PISTOLA DI SOFFIAGGIO CON SCHERMO D'ARIA PROTETTIVO ATTACCO FEMMINA
BLOW GUN WITH PROTECTIVE AIR-SCREEN FEMALE CONNECTION**

Codice Code	L	L1	Conf. Pack.
0032200001	90	157	10
0032200002	200	267	1
0032200003	290	357	1

325

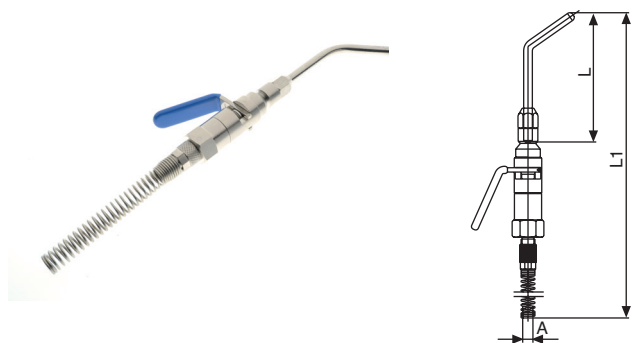
PISTOLA DI SOFFIAGGIO - ATTACCO A CALZAMENTO CON MOLLA - BLOW GUN - PUSH-ON CONNECTION WITH SPRING

Codice Code	L	A	L1	Conf. Pack.
0032500001	90	8/6	250.5	1
0032500002	90	10/8	251.5	1
0032500003	200	8/6	360.5	1
0032500004	200	10/8	361.5	1
0032500005	290	8/6	450.5	1
0032500006	290	10/8	451.5	1

326

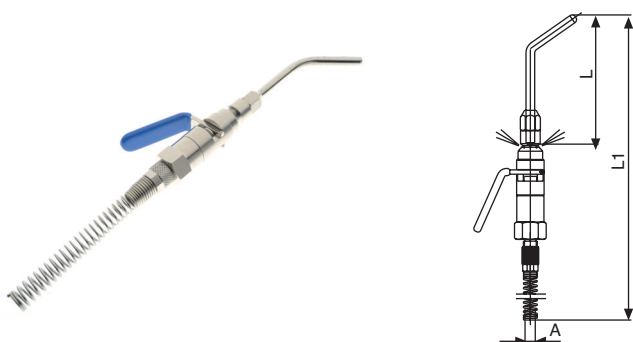
**PISTOLA DI SOFFIAGGIO CON SCHERMO D'ARIA PROTETTIVO ATTACCO A CALZAMENTO CON MOLLA
BLOW GUN WITH PROTECTIVE AIR SCREEN PUSH-ON CONNECTION WITH SPRING**

Codice Code	L	A	L1	Conf. Pack.
0032600001	90	8/6	250.5	1
0032600002	90	10/8	251.5	1
0032600003	200	8/6	360.5	1
0032600004	200	10/8	361.5	1
0032600005	290	8/6	450.5	1
0032600006	290	10/8	451.5	1

310

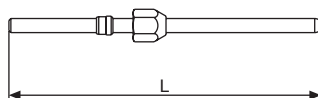
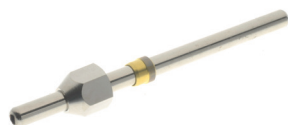
UGELLO DIRITTO (RICAMBIO) - STRAIGHT NOZZLE (SPARE PART)

Codice Code	L	Conf. Pack.
003100001	100	1
003100002	210	1
003100003	300	1

OGNI UGELLO È COMPLETO DI DADO E OGIVA.
EVERY NOZZLE IS SUPPLIED WITH NUT AND OLIVE.

311

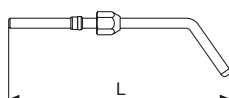
UGELLO ANGOLATO (RICAMBIO) - ELBOW NOZZLE (SPARE PART)

Codice Code	L	Conf. Pack.
003110001	90	1
003110002	200	1
003110003	290	1

OGNI UGELLO È COMPLETO DI DADO E OGIVA.
EVERY NOZZLE IS SUPPLIED WITH NUT AND OLIVE.

312

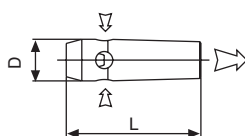
UGELLO EFFETTO VENTURI (RICAMBIO) - VENTURI'S EFFECT NOZZLE (SPARE PART)

Codice Code	D	L	Conf. Pack.
003120001	17	55	1