

Modular base

Ordering code
2430.V
VERSION
01=Modular base
V 06=Supply and exhaust closed
07=Supply closed
08=Exhaust closed

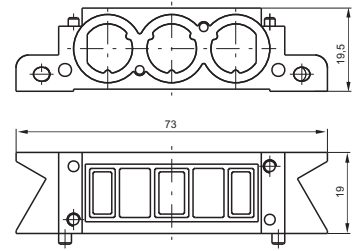

Blank base

Ordering code
2430.05

Weight gr. 85

Right inlet base

Ordering code
2430.02

Weight gr. 120

Left inlet base

Ordering code
2430.03

Weight gr. 125

Intermediate air intake

Ordering code
2430.10

Weight gr. 30
to be assembled of a valve

Closing plate

Ordering code
2430.00

Weight gr. 20

Diaphragm plug

Ordering code
2430.17

Weight gr. 5

2

Modular base

Ordering code

2440.V

VERSION

01 = standard base

✓ 11 = Modular base for single separate inlet



Weight gr. 110

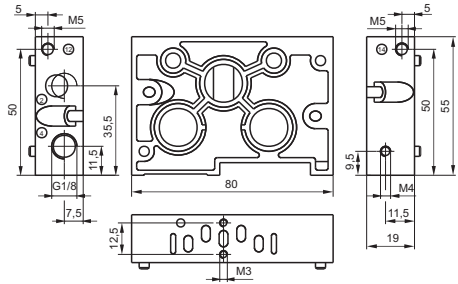

* Used to supply a single spool valve with an external pilot signal. Threaded ports 12 and 14 are connected to the valve via the base / valve interface, while the cross sectional drillings in the base are blanked off.*

Right inlet base

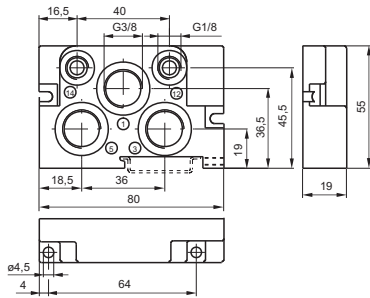

Ordering code

2440.02

Weight gr. 110

Left inlet base

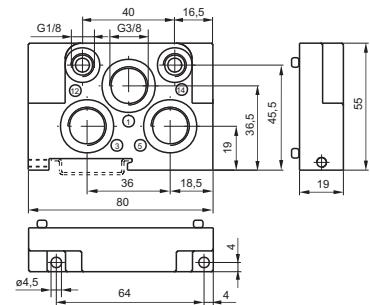

Ordering code

2440.03

Weight gr. 110

Intermediate air intake

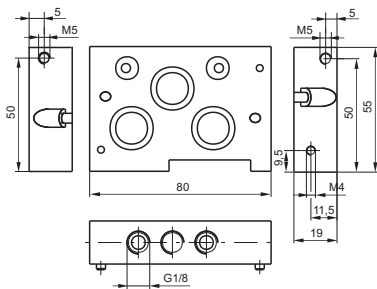

Ordering code

2440.10

Weight gr. 185

Closing plate

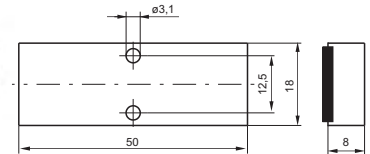

Ordering code

2440.00

Weight gr. 185



Diaphragm plug

Ordering code

2440.17





2

4 positions module	Ordering code	2 positions module												
	2400.P.T													
	<table border="1"> <tr><td>PLACES</td></tr> <tr><td>P 04 = 4 Places</td></tr> <tr><td>02 = 2 Places</td></tr> <tr><td>TYPE</td></tr> <tr><td>00 = Left IP40-PNP</td></tr> <tr><td>02 = Left IP40-PNP with protection diode PNP*</td></tr> <tr><td>10 = Left IP65-PNP</td></tr> <tr><td>12 = Left IP65-PNP with protection diode*</td></tr> <tr><td>T 01 = Right IP40-PNP</td></tr> <tr><td>03 = Right IP40-PNP with protection diode*</td></tr> <tr><td>11 = Right IP65-PNP</td></tr> <tr><td>13 = Right IP65-PNP with protection diode*</td></tr> </table>	PLACES	P 04 = 4 Places	02 = 2 Places	TYPE	00 = Left IP40-PNP	02 = Left IP40-PNP with protection diode PNP*	10 = Left IP65-PNP	12 = Left IP65-PNP with protection diode*	T 01 = Right IP40-PNP	03 = Right IP40-PNP with protection diode*	11 = Right IP65-PNP	13 = Right IP65-PNP with protection diode*	
PLACES														
P 04 = 4 Places														
02 = 2 Places														
TYPE														
00 = Left IP40-PNP														
02 = Left IP40-PNP with protection diode PNP*														
10 = Left IP65-PNP														
12 = Left IP65-PNP with protection diode*														
T 01 = Right IP40-PNP														
03 = Right IP40-PNP with protection diode*														
11 = Right IP65-PNP														
13 = Right IP65-PNP with protection diode*														
Weight gr. 50 * only for VDC		Weight gr. 30 * only for VDC												

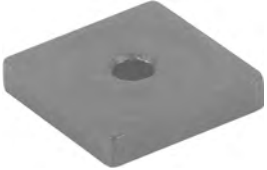
37 contacts front connector IP65	25 contacts front connector IP65				
<table border="1"> <tr><td>Ordering code</td></tr> <tr><td>2400.37.10</td></tr> </table> 	Ordering code	2400.37.10	<table border="1"> <tr><td>Ordering code</td></tr> <tr><td>2400.25.10</td></tr> </table> 	Ordering code	2400.25.10
Ordering code					
2400.37.10					
Ordering code					
2400.25.10					
Weight gr. 120 - IP 65 protection grade is achieved using the IP65 Pneumax Cable	Weight gr. 40 - IP 65 protection grade is achieved using the IP65 Pneumax Cable				

Plug	Closing plate electrical positions				
<table border="1"> <tr><td>Ordering code</td></tr> <tr><td>2400.00</td></tr> </table> 	Ordering code	2400.00	<table border="1"> <tr><td>Ordering code</td></tr> <tr><td>2400.15.00</td></tr> </table> 	Ordering code	2400.15.00
Ordering code					
2400.00					
Ordering code					
2400.15.00					
Weight gr. 5	Weight gr. 2				

VDMA support plate	FLAT support plate				
<table border="1"> <tr><td>Ordering code</td></tr> <tr><td>2440.50</td></tr> </table> 	Ordering code	2440.50	<table border="1"> <tr><td>Ordering code</td></tr> <tr><td>2430.50</td></tr> </table> 	Ordering code	2430.50
Ordering code					
2440.50					
Ordering code					
2430.50					
Weight gr. 20	Weight gr. 20				

4 positions box with 25 contacts connector	15mm male connector with 2 metres cable				
<table border="1"> <tr><td>Ordering code</td></tr> <tr><td>2400.04.25</td></tr> </table> 	Ordering code	2400.04.25	<table border="1"> <tr><td>Ordering code</td></tr> <tr><td>2400.15.02</td></tr> </table> 	Ordering code	2400.15.02
Ordering code					
2400.04.25					
Ordering code					
2400.15.02					
Weight gr. 65	Weight gr. 98				

In line cable complete with connector IP40

Ordering code
2400.T.L.00
CONNECTOR TYPE
T 25=25 contacts
37=37 contacts
CABLE LENGTH
L 03=3 meters
05=5 meters
10=10 meters



Cable complete with connector, 25 Poles IP65

Ordering code
2300.25.L.C
CABLE LENGTH
L 03=3 meters
05=5 meters
10=10 meters
CONNECTOR
C 10=In line
90=a 90°



Cable complete with connector, 37 Poles IP65

Ordering code
2400.37.L.C
CABLE LENGTH
L 03=3 meters
05=5 meters
10=10 meters
CONNECTOR
C 10=In line
90=a 90°

