

Modular throttle valves type HQ, KQ, JPQ

flow control, ISO 4401 sizes 06, 10, 16 and 25

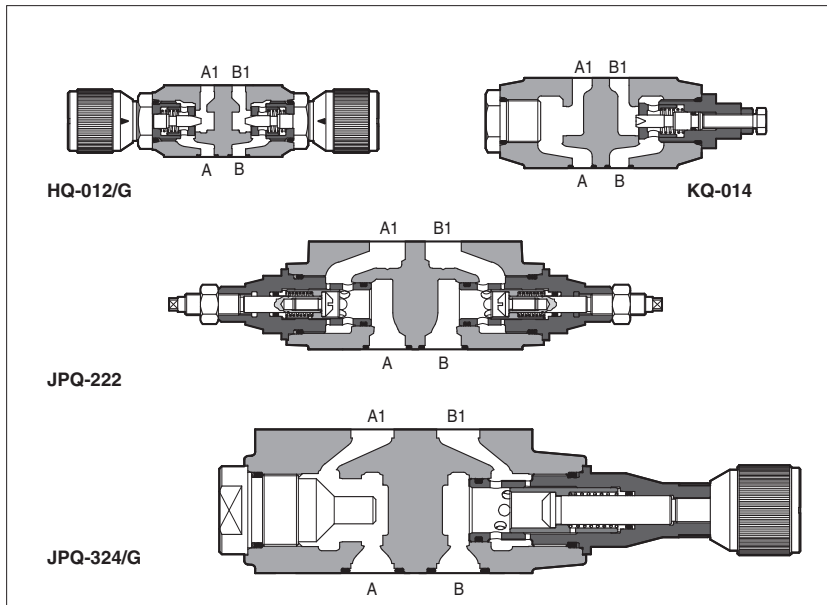

HQ, KQ and **JPQ** are flow throttling valves, not compensated, and with check valve to allow free flow in the opposite direction.

The flow adjustment is done by turning the setting screw in the normal model. Optional versions with a graduate micrometer knob are available on request. Clockwise rotation increases the throttling (passage reduced).

Valve size and max flow:

HQ-0 = size 06, flow up to 25 l/min for /U option, up to 80 l/min for standard

KQ-0 = size 10, flow up to 160 l/min

JPQ-2 = size 16, flow up to 200 l/min

JPQ-3 = size 25, flow up to 300 l/min

Mounting surface:

ISO 4401 size 06, 10, 16 and 25

Max pressure: **350 bar** (HQ, JPQ)
315 bar (KQ)

1 MODEL CODE

HQ-0	13	/	G	**	/	*
Modular flow control valve, size: HQ-0 = 06 KQ-0 = 10 JPQ-2 = 16 JPQ-3 = 25						Seals material, see section 8: - = NBR PE = FKM BT = HNBR
Configuration, see section 2 meter OUT control: 12 = double, acting on port A and B 13 = single, acting on port A 14 = single, acting on port B meter IN control: 22 = double, acting on port A and B 23 = single, acting on port A 24 = single, acting on port B				Series number		
						Options: U = better accuracy for reduced flow (only for HQ-0) G = adjustment by graduated micrometer

2 VALVE CONFIGURATION

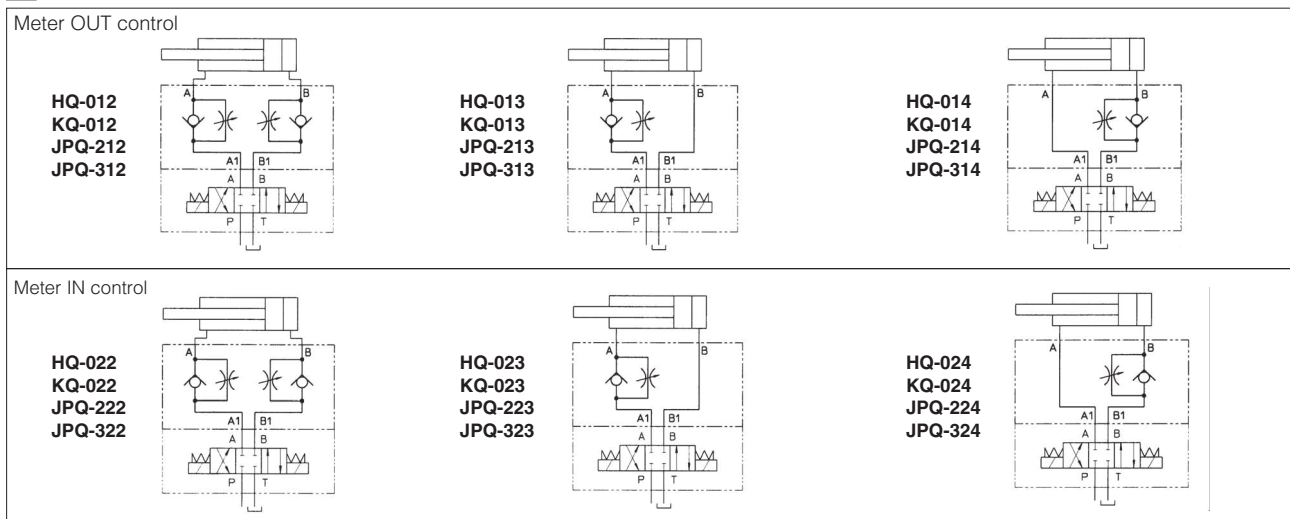

3 MAIN CHARACTERISTICS, SEALS and HYDRAULIC FLUID - for other fluids not included in below table, consult our technical office

Assembly position / location	Any position		
Subplate surface finishing	Roughness index Ra 0,4 - flatness ratio 0,01/100 (ISO 1101)		
MTTFd values according to EN ISO 13849	150 years, for further details see technical table P007		
Compliance	RoHS Directive 2011/65/EU as last update by 2015/65/EU REACH Regulation (EC) n°1907/2006		
Ambient temperature	Standard execution = -30°C ÷ +70°C /PE option = -20°C ÷ +70°C /BT option = -40°C ÷ +70°C		
Seals, recommended fluid temperature	NBR seals (standard) = -20°C ÷ +60°C, with HFC hydraulic fluids = -20°C ÷ +50°C FKM seals (/PE option) = -20°C ÷ +80°C HNBR seals (/BT option) = -40°C ÷ +60°C, with HFC hydraulic fluids = -40°C ÷ +50°C		
Recommended viscosity	15 ÷ 100 mm ² /s - max allowed range 2.8 ÷ 500 mm ² /s		
Max fluid contamination level	ISO4406 class 20/18/15 NAS1638 class 9, see also filter section at www.atos.com or KTF catalog		
Hydraulic fluid	Suitable seals type	Classification	Ref. Standard
Mineral oils	NBR, FKM, HNBR	HL, HLP, HLPD, HVLP, HVLPD	DIN 51524
Flame resistant without water	FKM	HF DU, HF DR	ISO 12922
Flame resistant with water	NBR, HNBR	HFC	

4 DIAGRAMS OF HQ-0 based on mineral oil ISO VG 46 at 50°C

- 1 = Regulation diagram at Δp 10 bar (1.1 = option /U)
- 2 = Regulation diagram at Δp 30 bar (2.1 = option /U)
- 3 = Regulation diagram at Δp 50 bar (3.1 = option /U)
- 4 = Q/ Δp diagram for free flow through the non-return valve

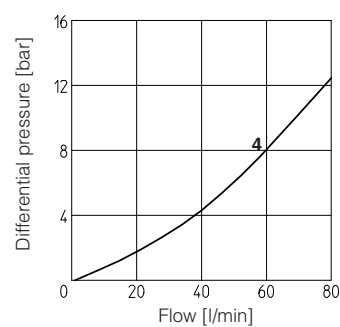
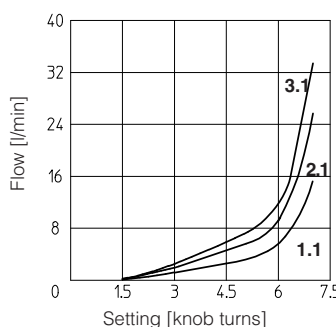
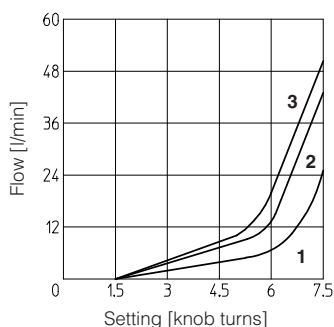

5 DIAGRAMS OF KQ-0 based on mineral oil ISO VG 46 at 50°C

- 1 = Regulation diagram at Δp 10 bar
- 2 = Regulation diagram at Δp 30 bar
- 3 = Regulation diagram at Δp 50 bar
- 4 = Q/ Δp diagram for free flow through the non-return valve

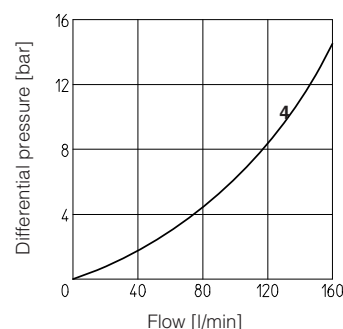
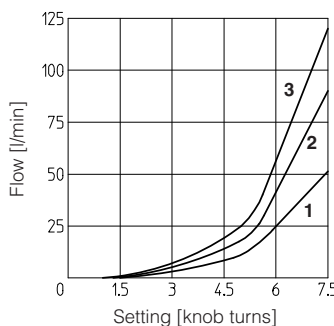

6 DIAGRAMS OF JPQ-2 based on mineral oil ISO VG 46 at 50°C

- 1 = Regulation diagram at Δp 10 bar
- 2 = Regulation diagram at Δp 30 bar
- 3 = Regulation diagram at Δp 50 bar
- 4 = Q/ Δp diagram for free flow through the non-return valve

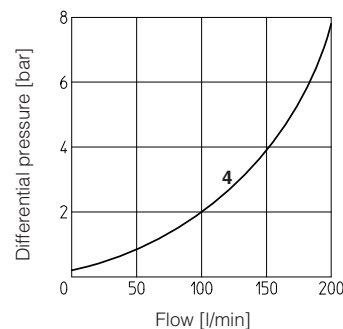
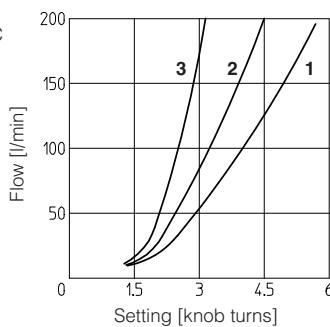

7 DIAGRAMS OF JPQ-3 based on mineral oil ISO VG 46 at 50°C

- 1 = Regulation diagram at Δp 10 bar
- 2 = Regulation diagram at Δp 30 bar
- 3 = Regulation diagram at Δp 50 bar
- 4 = Q/ Δp diagram for free flow through the non-return valve

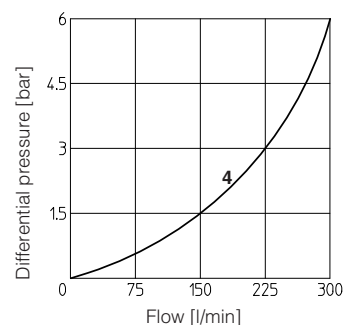
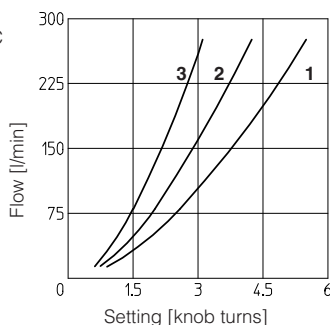

8 INSTALLATION DIMENSIONS OF HQ-0 VALVES [mm]

HQ-012
HQ-022

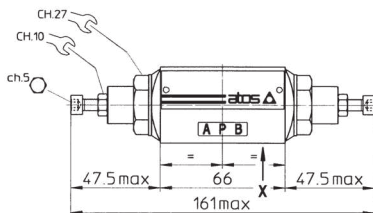
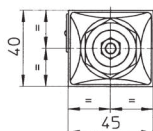

Mass: 1,1 Kg

HQ-013
HQ-014
HQ-023
HQ-024

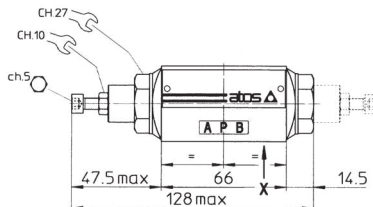
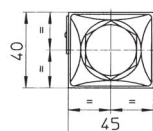

In version -014 and -024 the regulating element is on side of port B (dotted line) instead of side of port A.

Mass: 1,2 Kg

/G OPTION

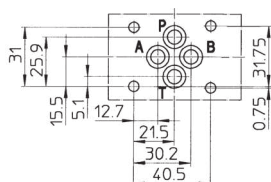
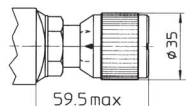
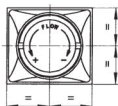

ISO 4401: 2005
Mounting surface: 4401-03-02-0-05
Diameter of ports A, B, P, T: $\varnothing = 7,5$ mm (max)
Seals: 4 OR 108

Fastening bolts: n° 4 socket head screws M5. The lenght depends on number and type of modular elements associated.

9 INSTALLATION DIMENSIONS OF KQ-0 VALVES [mm]

KQ-012
KQ-022

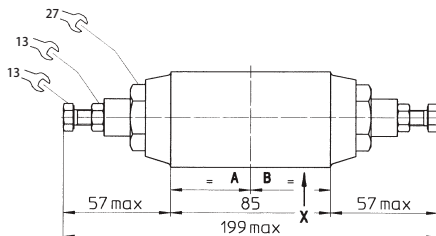
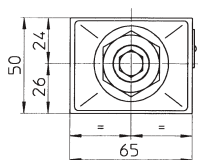

Mass: 2 Kg

KQ-013
KQ-014
KQ-023
KQ-024

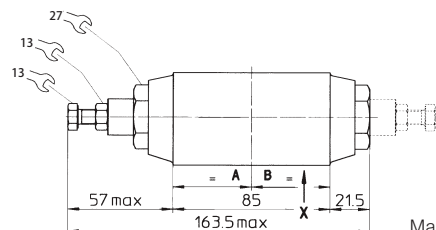
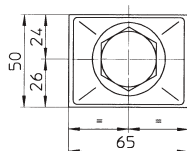

In version -014 and -024 the regulating element is on side of port B (dotted line) instead of side of port A.

Mass: 2,2 Kg

/G OPTION

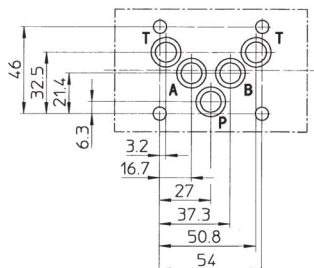
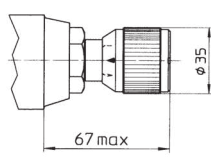
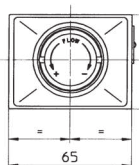

ISO 4401: 2005
Mounting surface: 4401-05-04-0-05
Diameter of ports A, B, P, T: $\varnothing = 11,2$ mm (max)
Seals: 5 OR 2050

Fastening bolts: n° 4 socket head screws M6. The lenght depends on number and type of modular elements associated.

10 INSTALLATION DIMENSIONS OF JPQ-2 VALVES [mm]

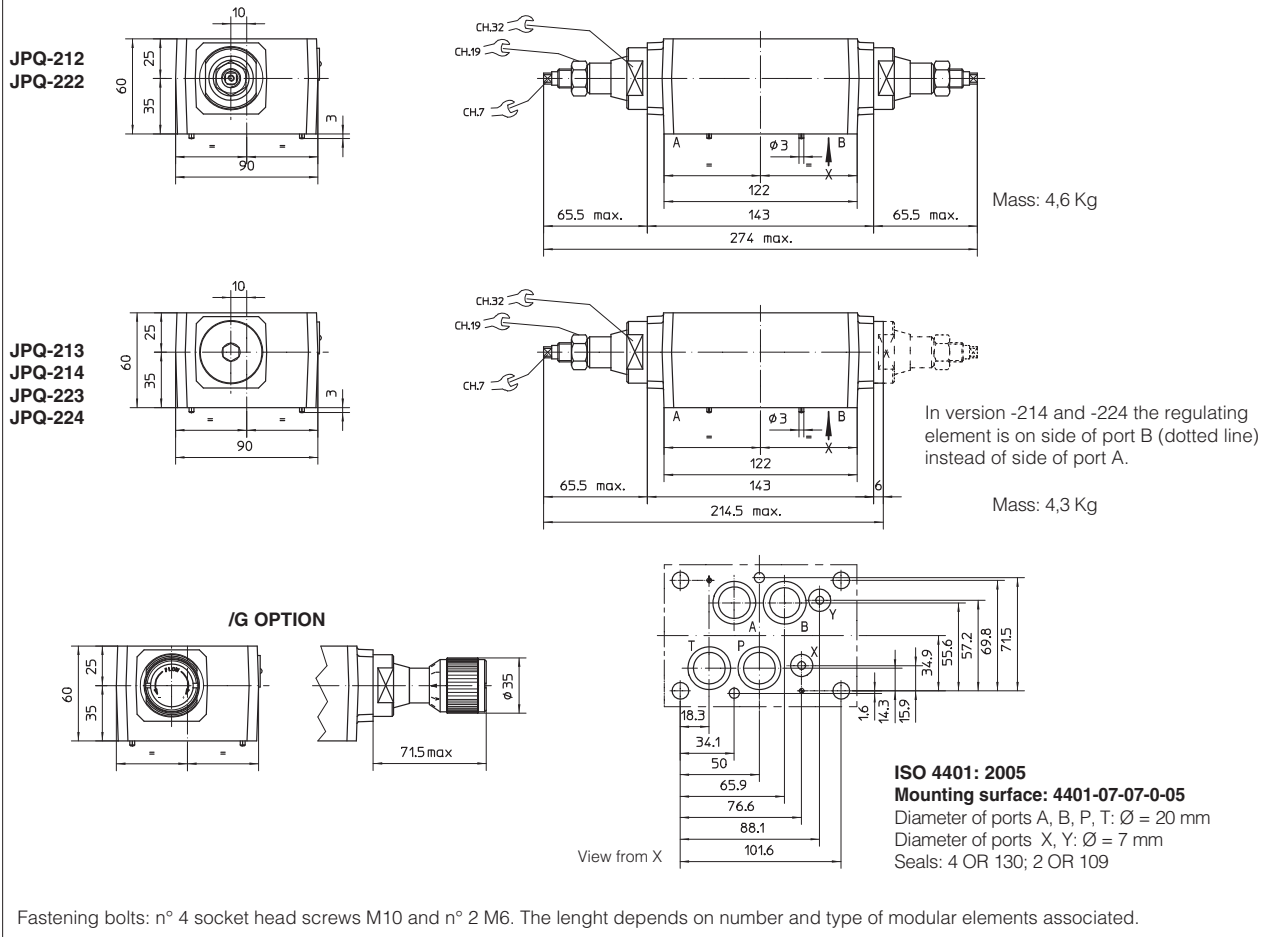

11 INSTALLATION DIMENSIONS OF JPQ-3 VALVES [mm]

