

## Block valve G1/4"

Ordering code

**6.09.14.F**

FUNCTION

UN = Unidirectional

BN = Bidirectional

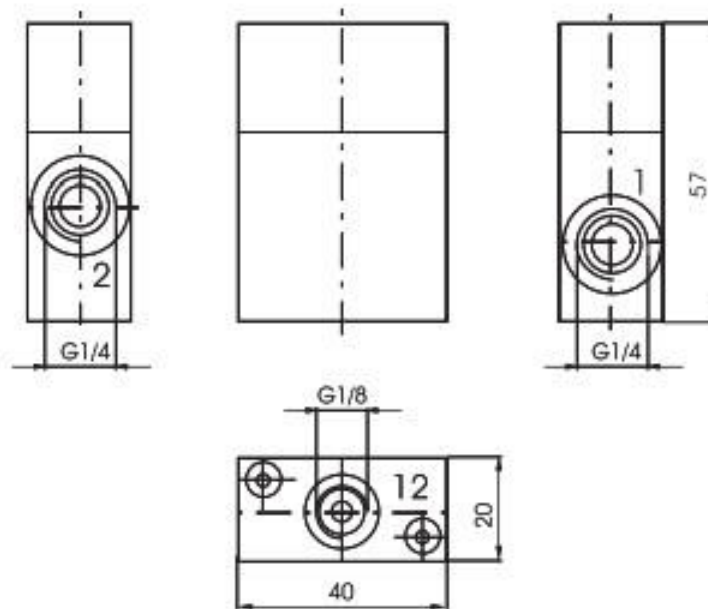

Weight gr. 122

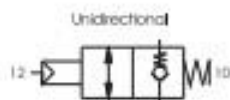

### Operational characteristic

Operational characteristic	Fluid	Max working pressure	Min. piloting pressure	Operating Temperature		Flow rate at 6 bar with $\Delta p = 1$	Orifice size
	Filtered and lubricated air	10 bar	4 bar	Min. -5°C	Max. +70°C	700 Nl/min	mm. 7