

## A106

Bulkhead

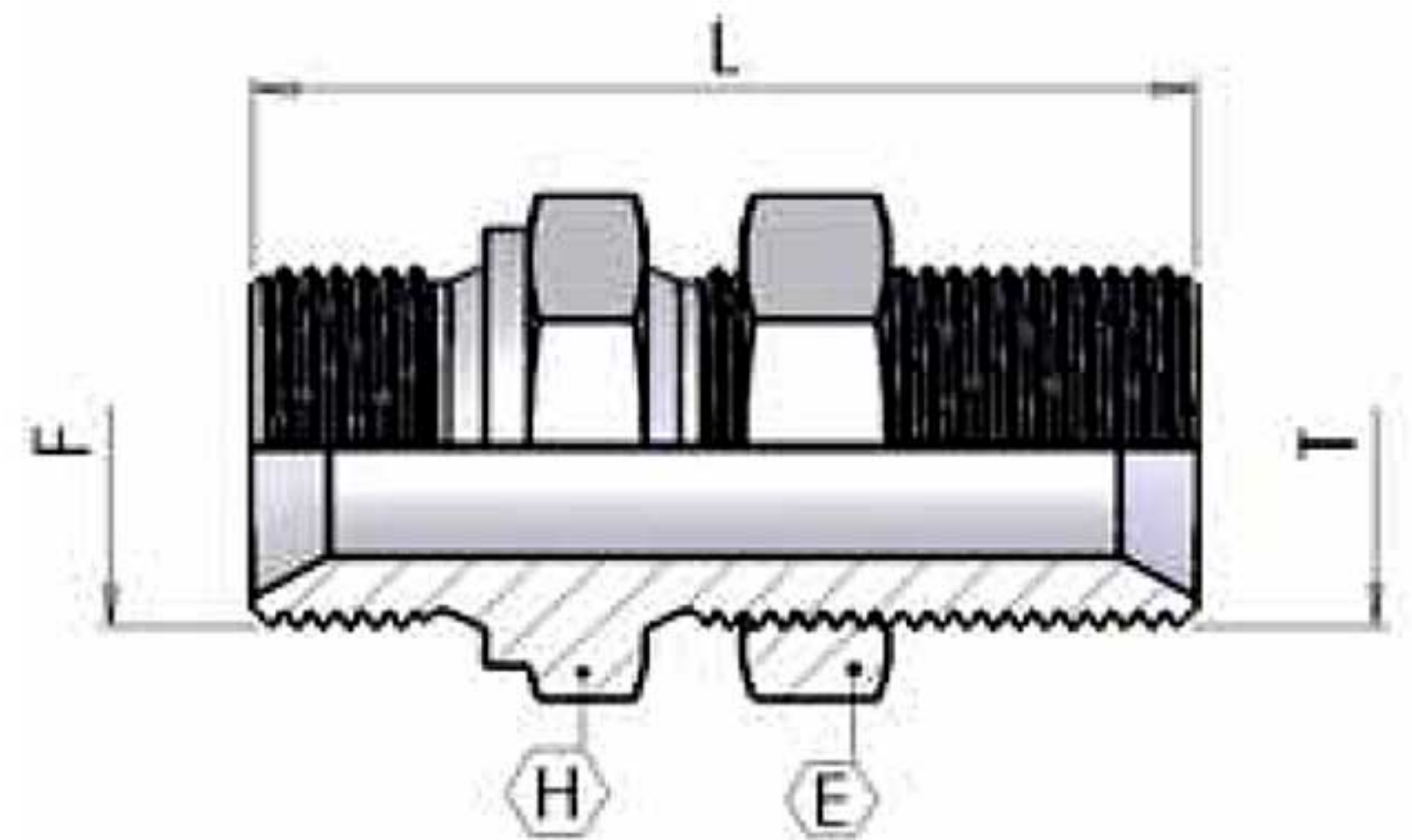

ID	part number	Ø tube		Dimensions					working pressure
		mm	inch	F	T	L	H	E	bar
31232	A106-04	8	5/16"	1/4-19	1/4-19	46	19	19	350
10396	A106-06	10	3/8"	3/8-19	3/8-19	54	22	22	350
8407	A106-08	12	1/2"	1/2-14	1/2-14	57	27	27	315
54903	A106-10	16	5/8"	5/8-14	5/8-14	65	30	30	
21808	A106-12	20	3/4"	3/4-14	3/4-14	65	32	32	250
25204	A106-16	25	1"	1-11	1-11	73	41	41	200
54904	A106-20	32	1.1/4"	2-11	2-11	79	50	50	