

R605

Short Male-Female reducing

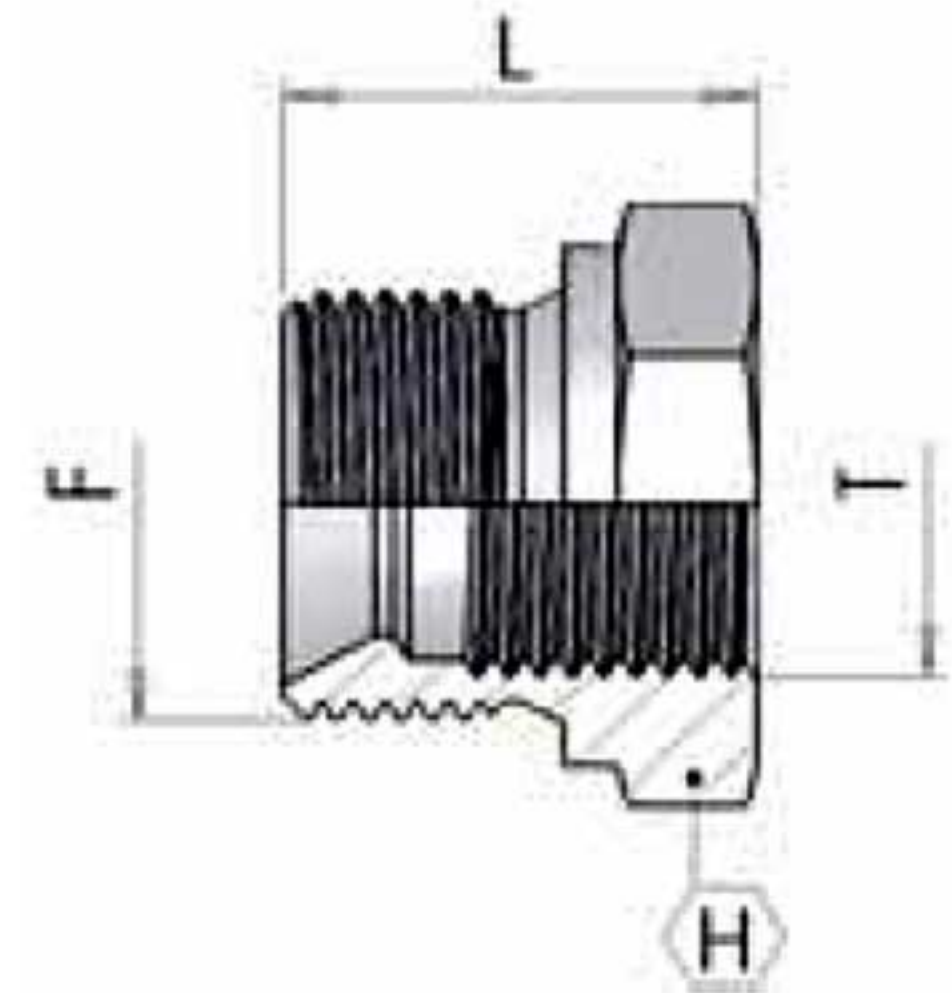

ID	part number	Ø tube		Dimensions				working pressure
		mm	inch	F	T	L	H	bar
54897	R605-04-02	6	1/4"	1/4"-19	1/8"-28	22	19	350
54896	R605-06-02	6	1/4"	3/8"-14	1/8"-28	22	22	350
8408	R605-06-04	8	5/16"	3/8"-19	1/4"-19	21	22	350
5804	R605-08-04	8	5/16"	1/2"-14	1/4"-19	24	27	315
8409	R605-08-06	10	3/8"	1/2"-14	3/8"-19	29	27	315
5805	R605-12-04	8	5/16"	3/4"-14	1/4"-19	27	32	250
9687	R605-12-06	10	3/8"	3/4"-14	3/8"-19	26	32	250
8410	R605-12-08	12	1/2"	3/4"-14	1/2"-14	27	32	250
39000	R605-16-06	10	3/8"	1-11	3/8"-19	31	41	200
5808	R605-16-08	12	1/2"	1-11	1/2"-14	30	41	200
7356	R605-16-12	20	3/4"	1-11	3/4"-14	31	41	200
39001	R605-20-12	20	3/4"	1.1/4-11	3/4"-14	34	50	160
7357	R605-20-16	25	1"	1.1/4-11	1-11	34	50	160
54898	R605-24-16	25	1"	1.1/2-11	1-11	35	55	125
7358	R605-24-20	32	1.1/4"	1.1/2-11	1.1/4"-11	39	55	125
33980	R605-32-20	32	1.1/4"	2-11	1.1/4"-11	43	70	80
39003	R605-32-24	38	1.1/2"	2-11	1.1/2"-11	43	70	80