

# Suction Pads for Handling Wood



## Suction Plates SPC

Suction area (Ø) from 160 mm to 250 mm



### Suitability for Industry-Specific Applications



Suction plates SPC

### Applications

- Round suction plate for handling and separation of flat, porous workpieces, including those with a "suck-through" effect
- Separation of workpieces by injection of a throttled flow of compressed air into a separate area of the suction pad

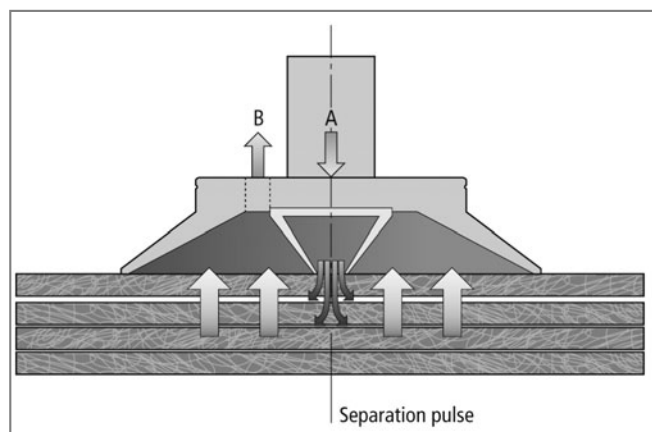

System design suction plates SPC

### Design

- Robust, wear-resistant suction pad SPC with double sealing lip, consisting of two seals (inner and outer) and aluminium support plate
- Seals are clipped securely into the support plate with specially shaped sections
- Inner seal separates the central cell for the flow of compressed air from the vacuum area
- When worn, the seals can be replaced separately; the aluminum supporting plate can be re-used
- The support plate has one threaded hole in the center (for connection of the compressed air A) and a second threaded hole towards the edge (for connection of the vacuum B) for gripping
- Series SPC-TV with sensing valve: deactivation of unused suction pads to prevent the entry of unwanted air



Suction plates SPC being used for separation of chipboards

### Our Highlights...

- Double sealing lip
- Separation function by applying a compressed air pulse
- Low internal volume
- Optimum shape

### Your Benefits...

- > Special suction pad for flat, porous workpieces, such as sheets of MDF, hardboard
- > Prevents porous workpieces from sticking together; overcomes the self-adhesion during unstacking of sheets
- > Very short cycle times
- > High suction forces in spite of small dimensions

# Suction Pads for Handling Wood



## Suction Plates SPC

Suction area (Ø) from 160 mm to 250 mm

### Designation Code Suction Plates SPC

Abbreviated designation	Suction area Ø in mm	Material and Shore hardness	Connection thread	Product addition
Example SPC 160 NBR-55 G1/2-IG TV:				
SPC	160	NBR-55	G1/2-IG	TV
SPC	160	NBR-55	G1/2-IG (IG = female (F))	TV sensing valve
	210			
	250			

### Ordering Data Suction Plates SPC

Suction plate SPC (sealing ring + support plate) is delivered assembled. The assembly consists of:

- Outer and inner sealing ring of type DR-SPC – elastomer part, available in various diameters
- Aluminium support plate – available with various threads
- Optional product range supplement – sensing valve

Available spare parts: sealing ring DR-SPC, sensing valve

### Suction Plates SPC

Type*	Part Number
SPC 160 NBR-55 G1/2-IG	10.01.01.01185
SPC 160 NBR-55 G1/2-IG TV	10.01.01.01186
SPC 210 NBR-55 G1/2-IG	10.01.01.01187
SPC 210 NBR-55 G1/2-IG TV	10.01.01.01188
SPC 250 NBR-55 G1/2-IG	10.01.01.01189
SPC 250 NBR-55 G1/2-IG TV	10.01.01.01211

\* Additional material specifications at beginning of the section "Vacuum Suction Pads"

### Ordering Data Spare Parts Suction Pads And Sensing Valve

Type	Outer sealing ring	Inner sealing ring	Sensing valve
SPC 160 NBR-55 G1/2-IG (-TV)	10.01.01.01190	10.01.01.11371	10.05.10.00061
SPC 210 NBR-55 G1/2-IG (-TV)	10.01.01.01191	10.01.01.11371	10.05.10.00061
SPC 250 NBR-55 G1/2-IG (-TV)	10.01.01.01192	10.01.01.11371	10.05.10.00038

### Technical Data Suction Plates SPC

Type	Suction force Ds [N]*	Suction force d2 [N]**	Volume [cm <sup>3</sup> ]	Recom. internal hose diameter d [mm]***
SPC 160 NBR-55 G1/2-IG	975	475	98	12
SPC 160 NBR-55 G1/2-IG TV	975	475	98	9
SPC 210 NBR-55 G1/2-IG	1760	1125	202	12
SPC 210 NBR-55 G1/2-IG TV	1760	1125	202	9
SPC 250 NBR-55 G1/2-IG	2540	1815	310	12
SPC 250 NBR-55 G1/2-IG TV	2540	1815	310	12

\* The specified suction forces are theoretical values at a vacuum of -0.6 bar and with a smooth, dry workpiece surface - they do not include a safety factor

\*\* Suction force referred to the sealing-edge diameter d2

\*\*\* The recommended hose diameter refers to a hose length of approx. 2 m

# Suction Pads for Handling Wood



## Suction Plates SPC

Suction area (Ø) from 160 mm to 250 mm



### Design Data Suction Plates SPC

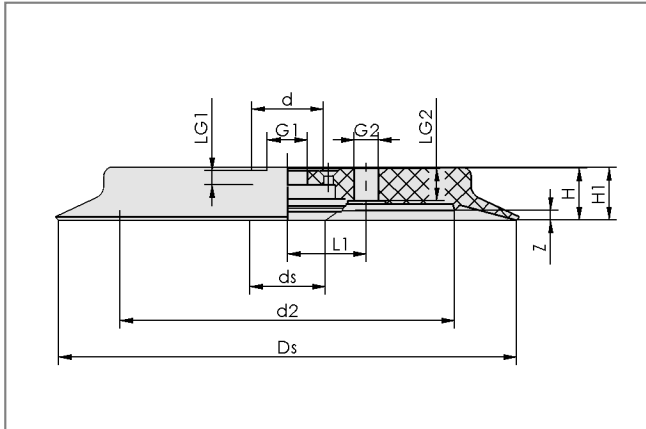

SPC 160 to 250

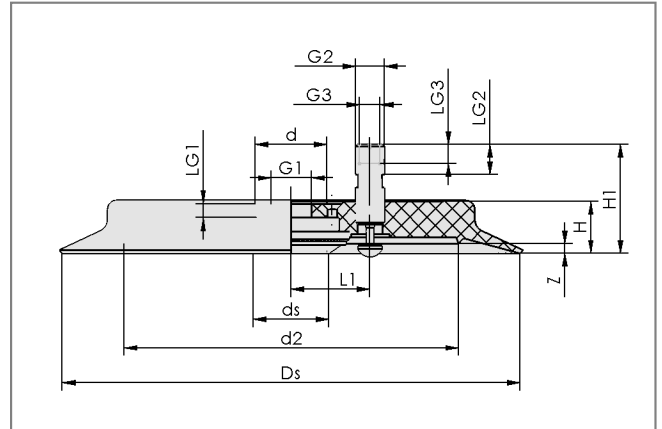

SPC 160 to 250 TV

Type	Dimensions in mm*													
	d	d2	Ds	ds	G1	G2	G3	H	H1	L1	LG1	LG2	LG3	Z
SPC 160 NBR-55 G1/2-IG	34	113	160	33.5	G1/2"-F	G1/4"-F	-	25	26.5	36.5	13.5	15	-	7
SPC 160 NBR-55 G1/2-IG TV	34	113	160	33.5	G1/2"-F	G1/4"-M	G1/8"-F	25	62.0	36.5	13.5	18	6	7
SPC 210 NBR-55 G1/2-IG	34	163	210	33.5	G1/2"-F	G1/4"-F	-	23	24.5	36.5	13.5	15	-	5
SPC 210 NBR-55 G1/2-IG TV	34	163	210	33.5	G1/2"-F	G1/4"-M	G1/8"-F	23	62.0	36.5	13.5	18	10	5
SPC 250 NBR-55 G1/2-IG	34	203	250	33.5	G1/2"-F	G1/2"-F	-	25	26.5	76.0	13.5	15	-	7
SPC 250 NBR-55 G1/2-IG TV	34	203	250	33.5	G1/2"-F	G1/2"-M	G1/8"-F	25	67.0	76.0	13.5	16	12	7

\*Acceptable dimensional tolerances for rubber parts concerning to DIN ISO 3302-1 M3