

Suction Pads for Handling Wood



Suction Plates SHF

Suction area (\emptyset) from 125 mm to 210 mm



Suitability for Industry-Specific Applications



Suction plates SHF

Applications

- Round suction plate for handling of sheets, furniture elements, parquet and similar large, flat workpieces
- Handling of wooden parts with rough surfaces

Design

- Suction plate SHF, consisting of sealing ring (3) and aluminum mounting plate (1)
- Connection (2) on the side, normally sealed with a screw plug (glued into position for extra safety)
- Sealing ring clipped securely to mounting plate (can be changed without tools)
- Double internal sealing edge (4) for better sealing to rough surfaces
- Optional sensing valve can be ordered separately (use medium-strength locking compound for installation)
- Filter screen available optionally

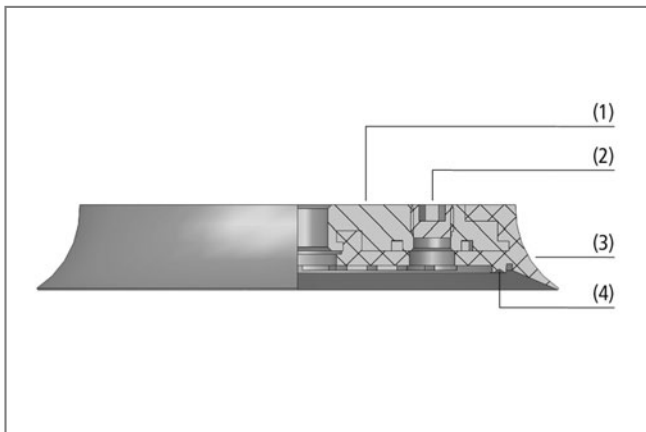

System design suction plates SHF

Our Highlights...

- Soft sealing lip
- Double internal sealing edge
- Specifically structured lower surface
- Modular design

Your Benefits...

- > Optimal adaptation to uneven workpiece surfaces
- > Very good sealing on rough and smooth surfaces
- > Highly dynamic movement and short cycle times
- > Gasket can be changed quickly without tools



Suction plates SHF being used for handling pressed wooden boards

Suction Pads for Handling Wood



Suction Plates SHF

Suction area (Ø) from 125 mm to 210 mm

Designation Code Suction Plates SHF

Abbreviated designation	Suction area Ø in mm	Material and Shore hardness	Connection thread
Example SHF 210 NK-45 G1/2-IG:			
SHF	210	NK-45	G1/2-IG
SHF	125	NK-45	G1/4-IG (IG = female (F))
	160		G1/2-IG
	210		

Ordering Data Suction Plates SHF

Suction plate SHF (sealing ring + support plate) is delivered assembled. The assembly consists of:

- Sealing ring of type DR-SHF – elastomer part, available in various diameters
- Aluminium support plate – available with various threads

Available spare parts: sealing ring DR-SHF

Available accessories: sensing valve, filter screen

Suction Plates SHF

Type*	Part Number
SHF 125 NK-45 G1/4-IG	10.01.01.11788
SHF 160 NK-45 G1/2-IG	10.01.01.12025
SHF 210 NK-45 G1/2-IG	10.01.01.11814

*Additional material specifications at beginning of the section "Vacuum Suction Pads"

Ordering Data Spare Parts And Accessories Suction Plates SHF

Type	Sealing ring DR-SHF	Filter screen (center)	Filter screen (outside)	Sensing valve
SHF 125 NK-45 G1/4-IG	10.01.01.11783	10.07.01.00215	10.07.01.00215	10.05.10.00061
SHF 160 NK-45 G1/2-IG	10.01.01.12023	10.07.01.00110	10.07.01.00215	10.05.10.00061
SHF 210 NK-45 G1/2-IG	10.01.01.11809	10.07.01.00110	10.07.01.00215	10.05.10.00061

Technical Data Suction Plates SHF

Type	Suction force Ds [N]*	Suction force d2 [N]**	Volume [cm³]	Min. curve radius [mm] (convex)	Recom. internal hose diameter d [mm]***
SHF 125 G1/4-IG	625	290	72	305	9
SHF 160 G1/2-IG	1025	580	117	500	12
SHF 210 G1/2-IG	1770	1160	224	885	12

*The specified suction forces are theoretical values at a vacuum of -0.6 bar and with a smooth, dry workpiece surface - they do not include a safety factor

**Suction force referred to the sealing-edge diameter d2

***The recommended hose diameter refers to a hose length of approx. 2 m

Suction Pads for Handling Wood



Suction Plates SHF

Suction area (\emptyset) from 125 mm to 210 mm



Design Data Suction Plates SHF

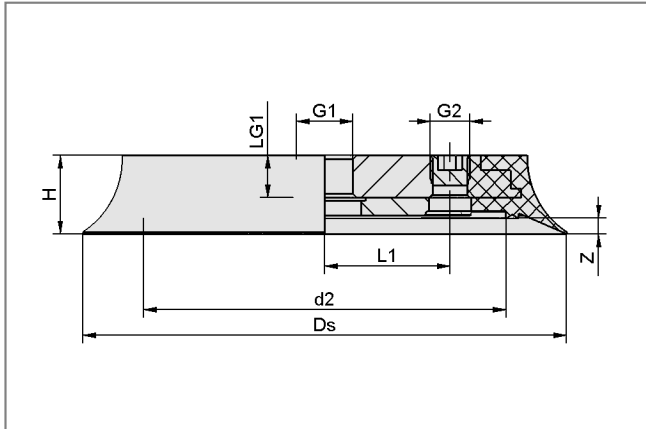

SHF 125 to 210

Type*	Dimensions in mm**							
	d2	Ds	G1	G2***	H	L1	LG1	Z (Stroke)
SHF 125 G1/4-IG	85	125	G1/4"-F	G1/4"-F	26	26.5	14	6
SHF 160 G1/2-IG	120	160	G1/2"-F	G1/4"-F	26	41.4	14	6
SHF 210 G1/2-IG	170	210	G1/2"-F	G1/4"-F	26	52.8	14	6

*The connection dimensions for the sensing valve can be found under "Sensing valves TV/TVN" in Section "Valve technology"

**Acceptable dimensional tolerances for rubber sealings concerning to DIN ISO 3302-1 M3

***A plug is fitted in this connection in the factory

- Schmalz - The Company
- Vacuum Knowledge
- Vacuum Suction Pads**
- Special Grippers
- Mounting Elements
- Vacuum Generators
- Valve Technology
- Switches and Monitoring
- Filters and Connections
- Vacuum Gripping Systems
- Services
- Contact
- Index of Products