

APG/APM

PROTEZIONE PER FORI FILETTATI
CAP FOR THREADED HOLES
STOPFEN FÜR BOHRUNGEN MIT GEWINDE

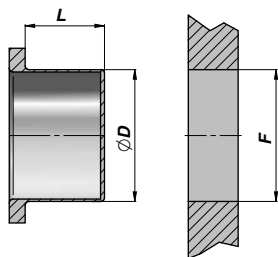
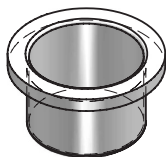

Codice Code Bestell-Nr.	F BSP	ØD	L
APG0300000	1/8"	9,0	7,5
APG0400000	1/4"	12,0	9,0
APG0600000	3/8"	15,5	9,5
APG0800000	1/2"	19,0	10,5
APG1200000	3/4"	25,0	12,0
APG1600000	1"	31,0	10,5
APG2000000	1"1/4	39,5	11,0
APG2400000	1"1/2	46,0	10,5
APG3200000	2"	57,5	13,5

Codice Code Bestell-Nr.	F	ØD	L
APM1215000	M12x1,5	10,5	8,0
APM1415000	M14x1,5	13,0	9,5
APM1615000	M16x1,5	15,0	9,5
APM1815000	M18x1,5	17,0	10,5
APM2015000	M20x1,5	19,0	10,5
APM2215000	M22x1,5	21,0	11,0

MATERIALE - MATERIAL:
POLIETILENE L.D. - POLYETHYLENE L.D. - POLYÄTHYLEN L.D.

APSEP

PROTEZIONE PER FORI FILETTATI
CAP FOR THREADED HOLES
STOPFEN FÜR BOHRUNGEN MIT GEWINDE

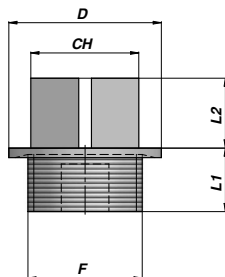
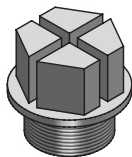

Codice Code Bestell-Nr.	F BSP	D	L1	L2	CH
APSEP43516	1/8"	16,8	9	10	13
APSEP43519	1/4"	19,2	9	10	13
APSEP43522	3/8"	22,2	9	11	17
APSEP43527	1/2"	27,2	12	13	19
APSEP43532	3/4"	32,3	12	13	24
APSEP43540	1"	40,0	15	14	27
APSEP43550	1"1/4	50,4	15	15	36
APSEP43555	1"1/2	55,4	15	15	41
APSEP43568	2"	68,4	15	15	55

Codice Code Bestell-Nr.	F	D	L1	L2	CH
APSEP435M12	M12x1,5	17,2	10	10	13
APSEP435M14	M14x1,5	19,2	10	10	13
APSEP435M16	M16x1,5	22,0	10	10	17
APSEP435M18	M18x1,5	24,0	10	11	17
APSEP435M20	M20x1,5	26,0	10	14	19
APSEP435M22	M22x1,5	27,2	10	14	19

MATERIALE - MATERIAL:
POLIAMIDE PA 6 - POLYAMIDE PA 6 - POLYAMID PA 6