

1

<b>Pneumatic-Spring</b>	3/2	Ordering code <b>T488.11.1</b>	5/2	<b>Pneumatic-Spring</b>
Weight gr. 75 Minimum operating pressure 2,5 bar				

Operational characteristics	Fluid	Max working pressure	Operating Temperature	Flow rate at 6 bar with Δp=1	Orifice size	Working port size
	Filtered air, with or without lubrication	10	-5 ÷ +50	620	6	G 1/8"

<b>Pneumatic-Differential (external)</b>	3/2	Ordering code <b>T488.11.12</b>	5/2	<b>Pneumatic-Differential (external)</b>
Minimum operating pressure 2 bar (for Pneumatic-Pneumatic version)				

Operational characteristics	Fluid	Max working pressure	Operating Temperature	Flow rate at 6 bar with Δp=1	Orifice size	Working port size
	Filtered air, with or without lubrication	10	-5 ÷ +50	620	6	G 1/8"

<b>Pneumatic-Pneumatic</b>	3/2	Ordering code <b>T488.11.11</b>	5/2	<b>Pneumatic-Pneumatic</b>
Minimum operating pressure 2 bar (for Pneumatic-Pneumatic version)				

Operational characteristics	Fluid	Max working pressure	Operating Temperature	Flow rate at 6 bar with Δp=1	Orifice size	Working port size
	Filtered air, with or without lubrication	10	-5 ÷ +50	620	6	G 1/8"



Pneumatic-Pneumatic

5/3

Ordering code
<b>T488.53.F.11.11</b>
FUNCTION
<b>F</b> 32 = Open Centres
33 = Pressured Centres

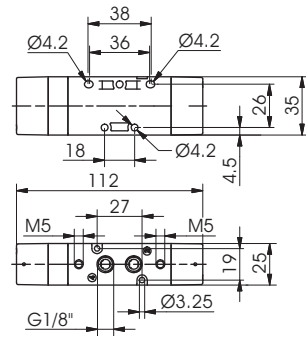

Weight gr. 140  
Minimum operating pressure 3 bar



Operational characteristics	Fluid	Max working pressure	Operating Temperature	Flow rate at 6 bar with $\Delta p=1$	Orifice size	Working port size
	Filtered air, with or without lubrication	10	-5 ÷ +50	410	6	G 1/8"

