

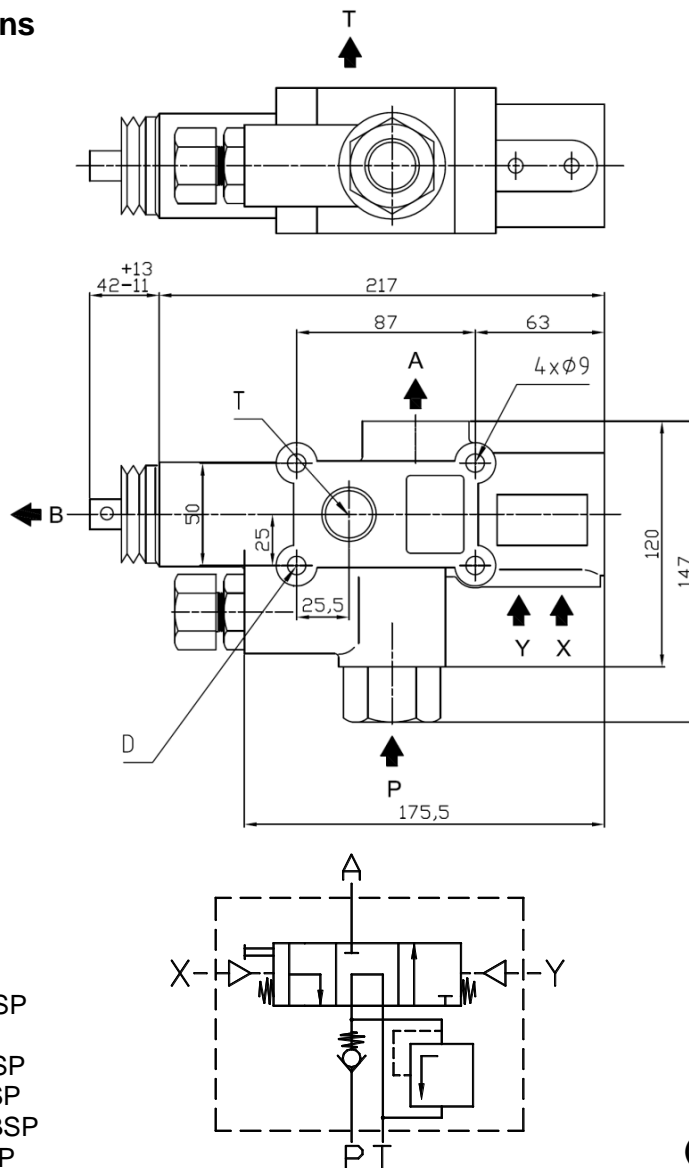

Tipping Valve		Ref. DTCA130
DT	Open Circuit 130 L	

Main Dimensions



A – Outlet 3/4" BSP
 B – Pull Stroke end
 P – Pump 3/4" BSP
 T – Tank 3/4" BSP
 X – Descent 1/8" BSP
 Y – Ascent 1/8" BSP

(Dimensions in mm)

Main Data

Maximum pressure (Bar)	350
Operating pressure (Bar)	up to 300
Flow rate (l/min)	130
Weight (kg)	5.2

Notes:

- ✓ This distributor can be used in progressive descent with our air command AOHCDC2 or AOHCDC3
- ✓ Tighten the tipping valve with only three bolts. Do not use the "D" hole. Screw the three bolts with 20 N.m torque.

ABER is constantly engaged in improving its products and, therefore, reserves itself the right to modify without any further notice the characteristics shown