

INTERUTTORI A PUNTALE

SWITCH WITH SOCKET CONNECTOR

CODICE FAMIGLIA
FAMILY CODE

311-001

DIN 72585

- Interruttore meccanico a puntale da utilizzarsi unicamente con carico max. sui contatti:
 - 5A lampada a 12V / 3A a 24V
oppure con carico minimo sui contatti:
 - 50 / 150 mA carico resistivo 12V / 24V.
- Interruttore NON idoneo per impiego in ambiente con pressione.
- Tenuta lato connettore DIN 72585: IP64K e IPX9K secondo NORMA DIN 40050 pat. 9 e NORMA CEI EN 60529.
- Mechanical push button switch only to be used with max load on contacts:
 - 5A bulb at 12V / 3A at 24V
or with minimum load on the contacts:
 - 50 / 150 mA resistive load 12V / 24V.
- Switch NOT suitable for use in pressurised environments.
- Socket connector DIN 72585: IP64K and IPX9K in accordance with DIN 40050 pat.9 and CEI EN 60529 standards.

CODICE / Order code
311-001-00125

CONTATTO / Contact
Normalmente chiuso
Normally closed



7201

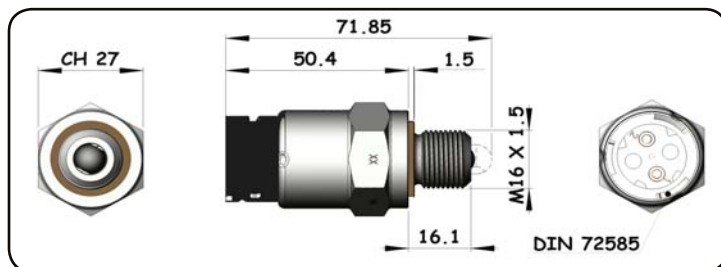

CODICE / Order code
311-001-00134

CONTATTO / Contact
Normalmente aperto
Normally open



7200

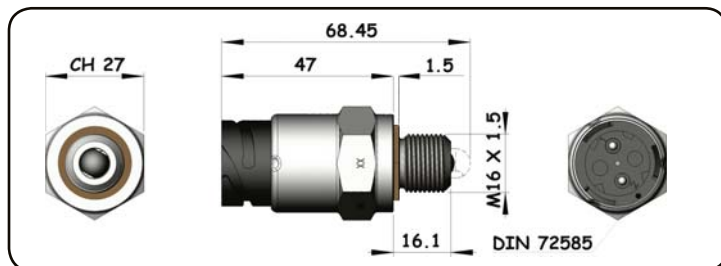

CODICE / Order code
311-001-00170

CONTATTO / Contact
Normalmente chiuso
Normally closed



7206

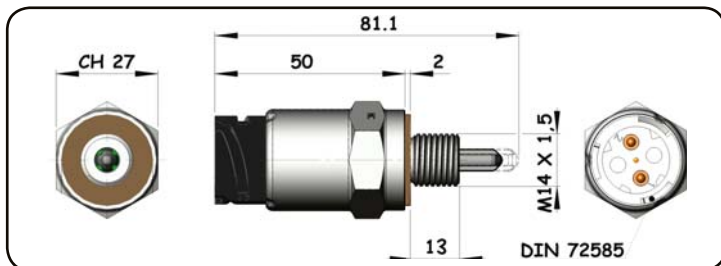

CODICE / Order code
311-001-00189

CONTATTO / Contact
Normalmente aperto
Normally open

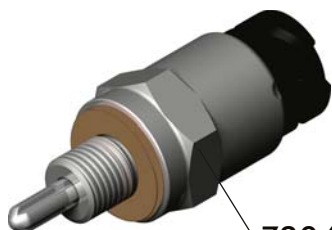

7204

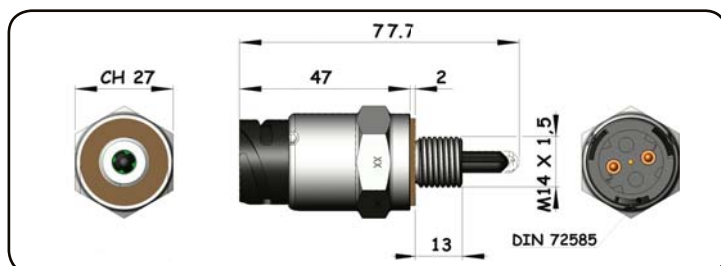

CODICE / Order code
311-001-00198

CONTATTO / Contact
Normalmente chiuso
Normally closed



7208

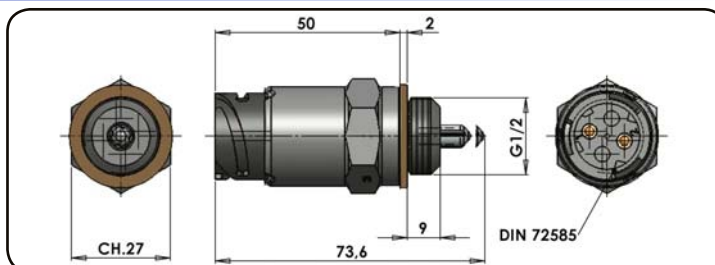

CODICE / Order code
311-001-00205

CONTATTO / Contact
Normalmente aperto
Normally open

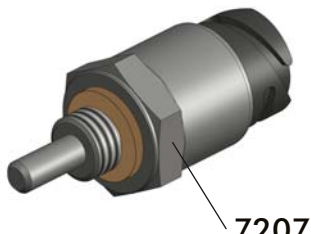

7207

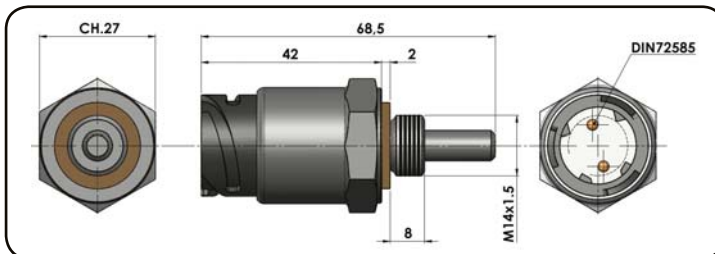

PACKARD

- Interruttore meccanico a puntale da utilizzarsi unicamente con carico max. sui contatti:

- 3W lampada
- Tensione 12V - 24V
- Temperatura di esercizio: -25°C +80°C

- Mechanical push button switch only to be used with max load on contacts:

- 3W bulb
- Voltage 12V - 24V
- Working temperature: -25°C +80°C

CODICE / Order code
311-001-00107

CONTATTO / Contact
Normalmente chiuso
Normally closed

- Interruttore NON idoneo per impiego in ambiente con pressione.
- Switch NOT suitable for use in pressurised environments.

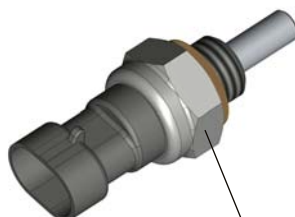

7131

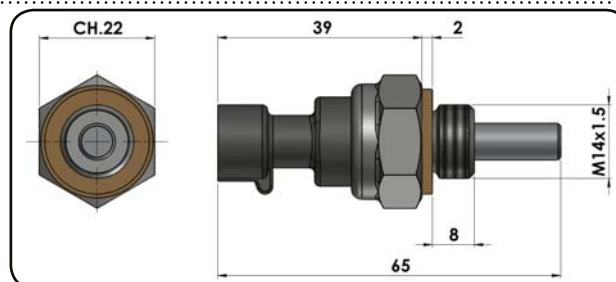

CODICE / Order code
311-001-00116

CONTATTO / Contact
Normalmente aperto
Normally open

- Interruttore NON idoneo per impiego in ambiente con pressione.
- Switch NOT suitable for use in pressurised environments.



7130

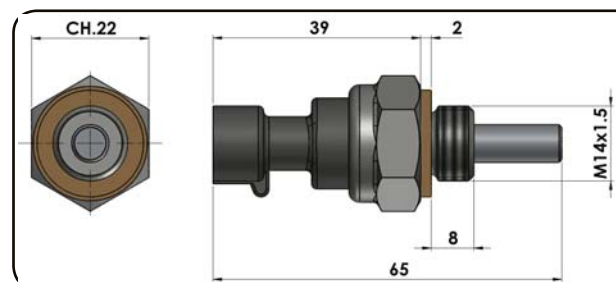

CODICE / Order code
311-001-00081

CONTATTO / Contact
Normalmente chiuso
Normally closed

ALTA PRESSIONE
HIGH PRESSURE
MAX. 12,5 bar

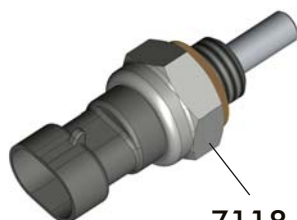

7118

